

Soils Map

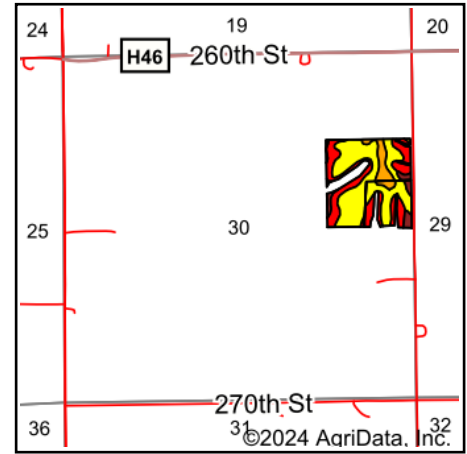

State: **Iowa**
 County: **Henry**
 Location: **30-71N-7W**
 Township: **Tippecanoe**
 Acres: **35.65**
 Date: **3/22/2024**

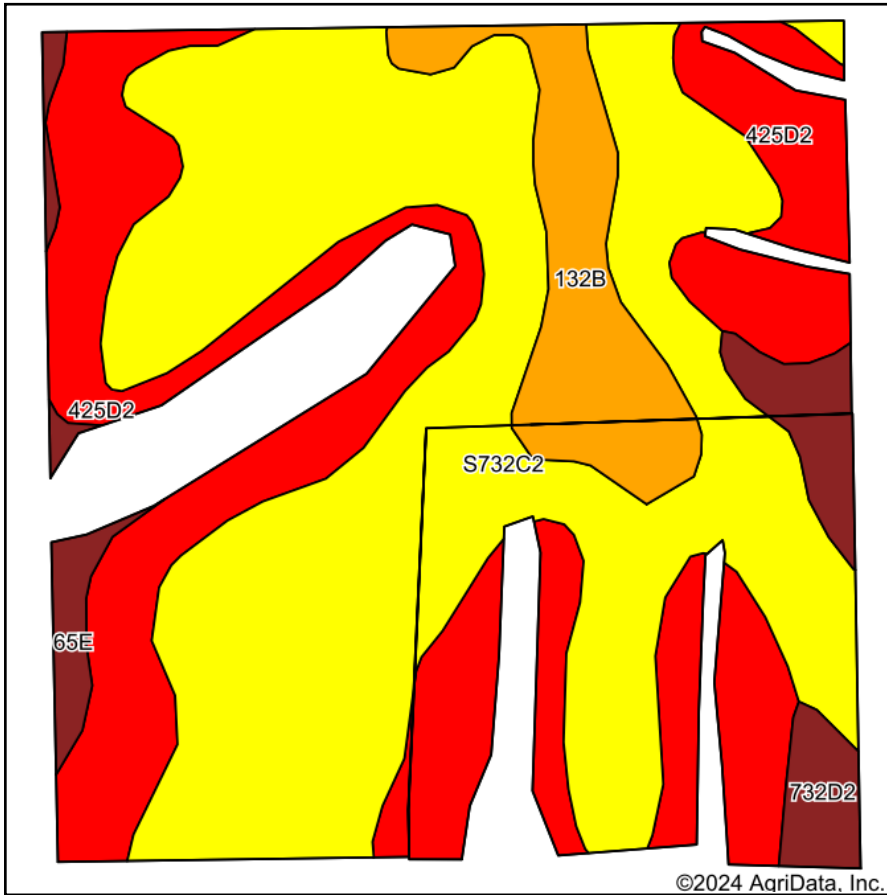





Maps Provided By:

 CUSTOMIZED ONLINE MAPPING
 © AgriData, Inc. 2023 www.AgriDataInc.com



Area Symbol: IA087, Soil Area Version: 28

Code	Soil Description	Acres	Percent of field	CSR2 Legend	Non-Irr Class *c	CSR2**	CSR	
S732C2	Weller silty clay loam, 5 to 9 percent slopes, moderately eroded	19.15	53.7%		IIIe	59		
425D2	Keswick loam, 9 to 14 percent slopes, moderately eroded	11.44	32.1%		IVe	9	12	
132B	Weller silt loam, 2 to 5 percent slopes	2.90	8.1%		IIIe	67	60	
732D2	Weller silty clay loam, 9 to 14 percent slopes, moderately eroded	1.45	4.1%		IVe	34	28	
65E	Lindley loam, 14 to 18 percent slopes	0.71	2.0%		VIe	33	30	
Weighted Average						3.42	42.1	*-

**IA has updated the CSR values for each county to CSR2.

*- CSR weighted average cannot be calculated on the current soils data, use prior data version for csr values.

*c: Using Capabilities Class Dominant Condition Aggregation Method