

Soils Map

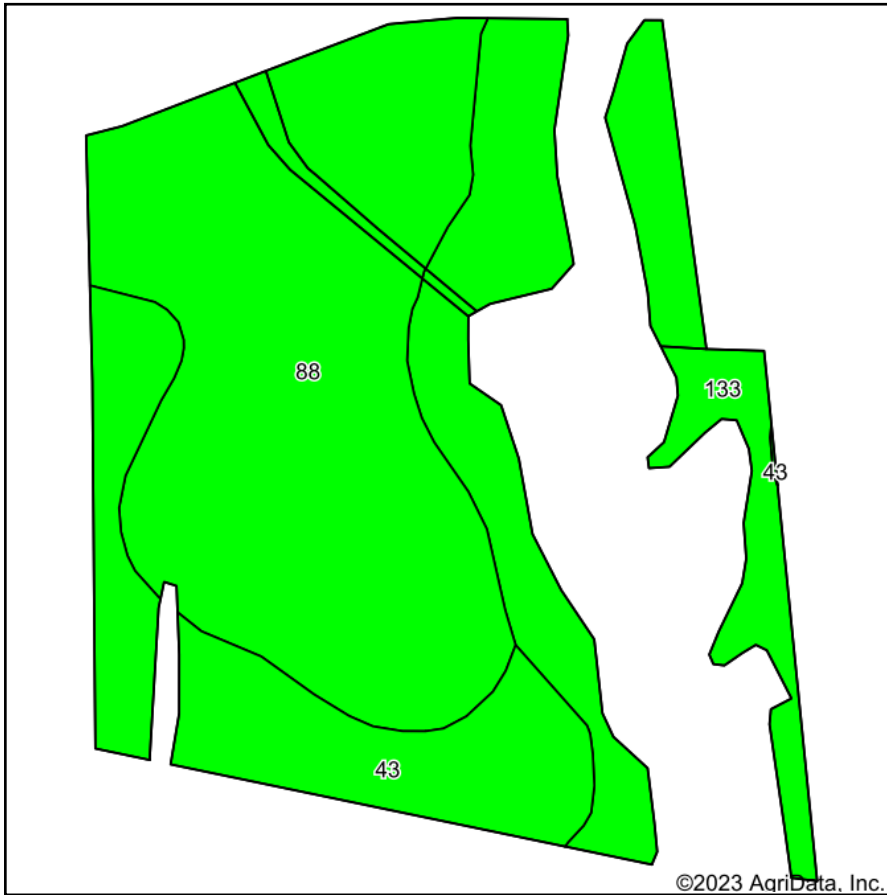

Soils data provided by USDA and NRCS.

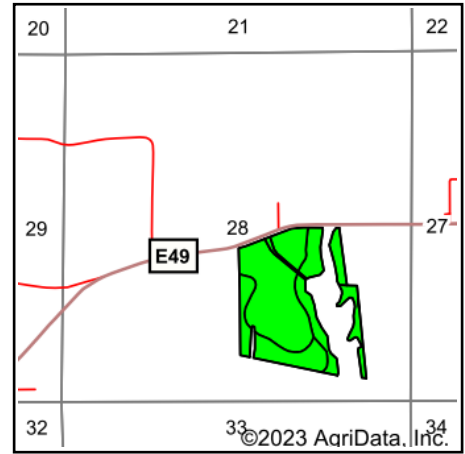

State: **Iowa**
 County: **Tama**
 Location: **28-83N-15W**
 Township: **Tama**
 Acres: **62.32**
 Date: **6/2/2023**



Maps Provided By:



© AgriData, Inc. 2023

www.AgriDataInc.com



Area Symbol: IA171, Soil Area Version: 27

Code	Soil Description	Acres	Percent of field	CSR2 Legend	Non-Irr Class *c	CSR2**	CSR	
88	Nevin silty clay loam, 0 to 2 percent slopes	33.26	53.4%		lw	95	90	
133	Colo silty clay loam, 0 to 2 percent slopes, occasionally flooded	16.77	26.9%		llw	78	85	
43	Bremer silty clay loam, 0 to 2 percent slopes, occasionally flooded	12.29	19.7%		llw	74	82	
Weighted Average						1.47	86.3	87.1

**IA has updated the CSR values for each county to CSR2.

*c: Using Capabilities Class Dominant Condition Aggregation Method

Soils data provided by USDA and NRCS.