

# Soils Map

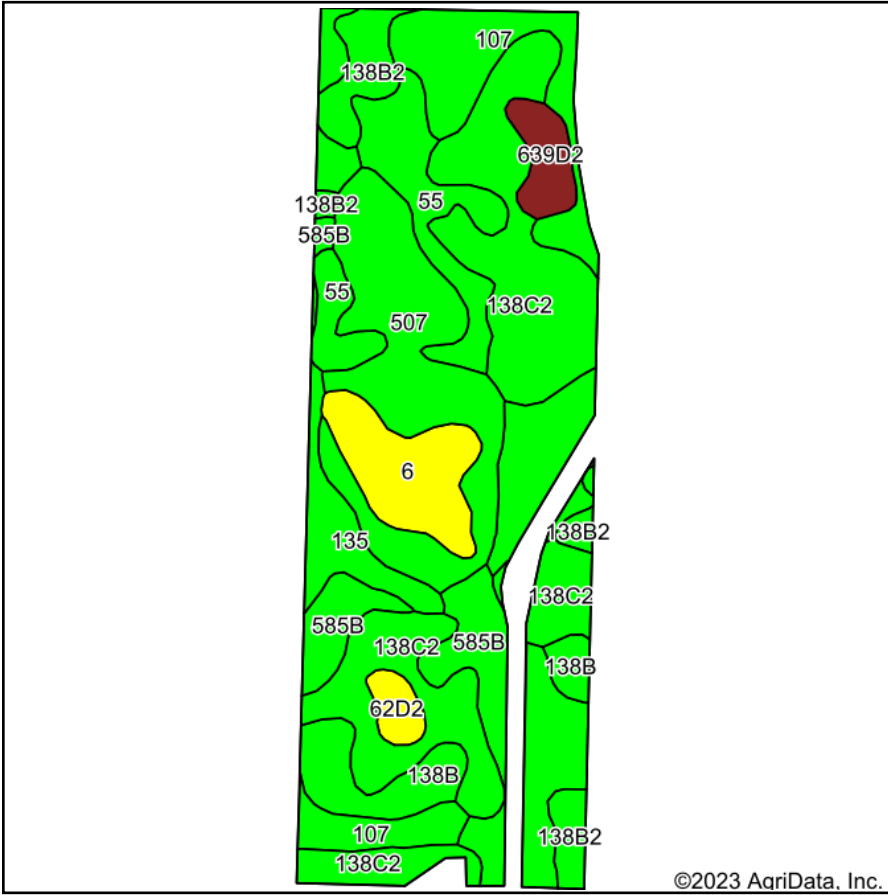

Soils data provided by USDA and NRCS.

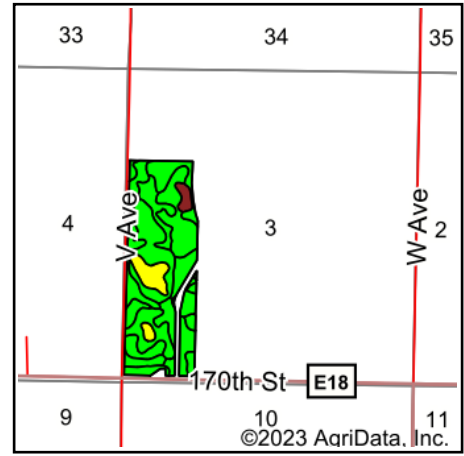

State: **Iowa**  
 County: **Greene**  
 Location: **3-84N-29W**  
 Township: **Junction**  
 Acres: **106.29**  
 Date: **3/10/2023**



Maps Provided By:



Area Symbol: IA073, Soil Area Version: 28

Code	Soil Description	Acres	Percent of field	CSR2 Legend	Non-Irr Class *c	CSR2**	CSR	
138C2	Clarion loam, 6 to 10 percent slopes, moderately eroded	26.89	25.3%		IIIe	83	66	
107	Webster clay loam, 0 to 2 percent slopes	16.94	15.9%		IIw	86	86	
507	Canisteo clay loam, 0 to 2 percent slopes	15.90	15.0%		IIw	84	81	
585B	Coland-Spillville complex, 1 to 5 percent slopes	12.55	11.8%		IIw	74	70	
55	Nicollet clay loam, 1 to 3 percent slopes	8.84	8.3%		Iw	89	91	
6	Okoboji silty clay loam, 0 to 1 percent slopes	6.51	6.1%		IIIw	59	58	
138B	Clarion loam, 2 to 6 percent slopes	5.33	5.0%		IIe	89	83	
138B2	Clarion loam, 2 to 6 percent slopes, moderately eroded	5.28	5.0%		IIe	87	81	
135	Coland clay loam, 0 to 2 percent slopes, occasionally flooded	4.11	3.9%		IIw	76	81	
639D2	Salida-Storden complex, 9 to 14 percent slopes, moderately eroded	2.53	2.4%		IVe	26	10	
62D2	Storden loam, 10 to 16 percent slopes, moderately eroded	1.41	1.3%		IVe	41	43	
<b>Weighted Average</b>						<b>2.31</b>	<b>79.9</b>	<b>74</b>

\*\*IA has updated the CSR values for each county to CSR2.

\*c: Using Capabilities Class Dominant Condition Aggregation Method  
 Soils data provided by USDA and NRCS.