

Soils Map

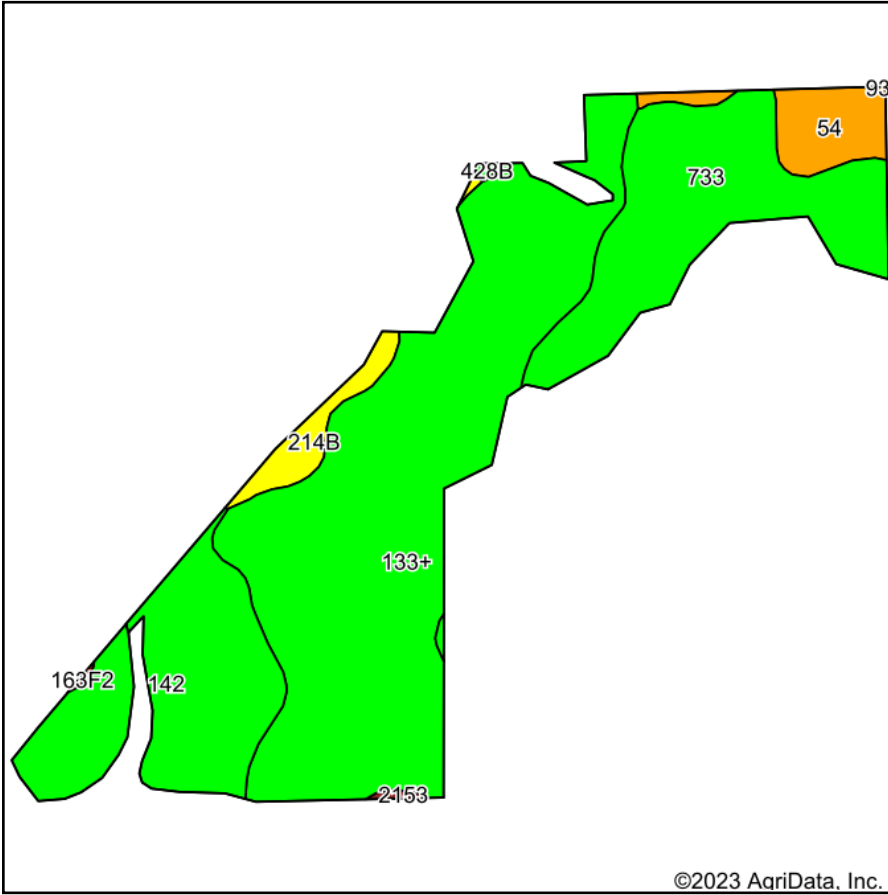

Soils data provided by USDA and NRCS.

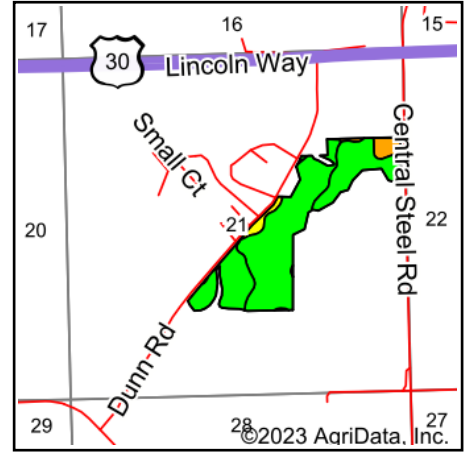

State: **Iowa**
 County: **Clinton**
 Location: **21-81N-6E**
 Township: **Camanche**
 Acres: **67.09**
 Date: **2/1/2023**



Maps Provided By:



© AgriData, Inc. 2021

www.AgriDataInc.com



Area Symbol: IA045, Soil Area Version: 28

Code	Soil Description	Acres	Percent of field	CSR2 Legend	Non-Irr Class *c	CSR2**	CSR	
133+	Colo silt loam, 0 to 2 percent slopes, occasionally flooded, overwash	35.42	52.8%		IIw	78	80	
733	Calco silty clay loam, 0 to 2 percent slopes	13.71	20.4%		IIw	78	60	
142	Chaseburg silt loam, moderately well drained, 0 to 2 percent slopes	12.59	18.8%		IIw	79	88	
54	Zook silty clay loam, 0 to 2 percent slopes	3.21	4.8%		IIw	69	70	
214B	Rockton loam, 20 to 30 inches to limestone, 2 to 5 percent slopes	1.93	2.9%		Ile	49	59	
2153	Shandep clay loam, 0 to 2 percent slopes, ponded, occasionally flooded	0.12	0.2%		Vw	21		
428B	Ely silt loam, 2 to 5 percent slopes	0.11	0.2%		Ile	87	88	
Weighted Average						2.01	76.8	*-

**IA has updated the CSR values for each county to CSR2.

*- CSR weighted average cannot be calculated on the current soils data, use prior data version for csr values.

*c: Using Capabilities Class Dominant Condition Aggregation Method

Soils data provided by USDA and NRCS.