

# Soils Map

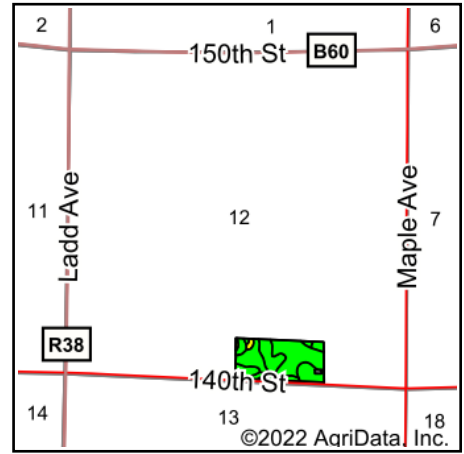

State: **Iowa**  
 County: **Hancock**  
 Location: **12-94N-25W**  
 Township: **Amsterdam**  
 Acres: **19.57**  
 Date: **10/13/2022**

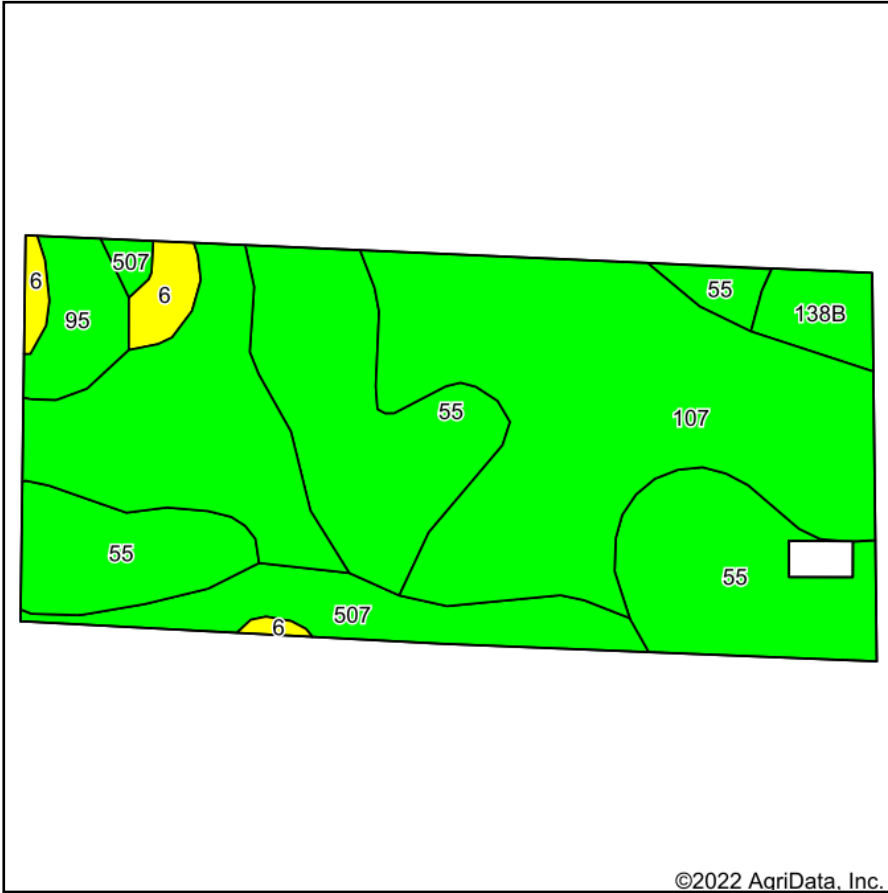

Maps Provided By:  
  
 CUSTOMIZED ONLINE MAPPING  
 © AgriData, Inc. 2021      www.AgriDataInc.com



Soils data provided by USDA and NRCS.

©2022 AgriData, Inc.

Area Symbol: IA081, Soil Area Version: 32

Code	Soil Description	Acres	Percent of field	CSR2 Legend	Non-Irr Class *c	CSR2**	CSR	
107	Webster clay loam, 0 to 2 percent slopes	9.62	49.2%		IIw	86	83	
55	Nicollet clay loam, 1 to 3 percent slopes	6.54	33.4%		Iw	89	88	
507	Canisteo clay loam, 0 to 2 percent slopes	1.61	8.2%		IIw	84	78	
95	Harps clay loam, 0 to 2 percent slopes	0.74	3.8%		IIw	72	62	
138B	Clarion loam, 2 to 6 percent slopes	0.55	2.8%		Ile	89	80	
6	Okoboji silty clay loam, 0 to 1 percent slopes	0.51	2.6%		IIIw	59	57	
<b>Weighted Average</b>						<b>1.69</b>	<b>85.7</b>	<b>82.7</b>

\*\*IA has updated the CSR values for each county to CSR2.  
 \*c: Using Capabilities Class Dominant Condition Aggregation Method  
 Soils data provided by USDA and NRCS.