

U. S. DEPARTMENT OF AGRICULTURE
AGRICULTURAL CONSERVATION PROGRAM SERVICE

NOTICE OF PRACTICE TENTATIVELY APPROVED

LOCATION OF FARM

Fremont Twp. Sec 30

DATE

6/7/63

FARM
NO.

NAME AND ADDRESS

PROGRAM YEAR

AGENCY REFERRED TO:

113 FRED F. MOHLIS 194 114
1
00 SUMNER, IOWA

1963

SCS

PHOTOGRAPH NUMBER

NO. A	PRACTICE DESCRIPTION B	MONTH INTENDED TO START C	PRACTICE TENTATIVELY APPROVED		FEDERAL COST SHARE TENTATIVELY APPROVED E
			EXTENT D	UNIT	
c-10	a. tile 5"	July	2475 (24.75 tile units)	ft.	225.22
	c. pipe (1)		16	ft.	8.00

Your request for ACP cost-sharing to carry out the practice shown above has been **tentatively** approved. The practice units and Federal cost-shares tentatively approved are preliminary estimates only, subject to change when and if a firm approval is made by the ASC county committee.

To assure sound investment of program funds and to avoid unnecessary expenditures on your part by installing an impracticable practice, it is required that a local technician determine whether the practice is needed and practicable on your farm. This, in most cases, requires inspection of the site where the practice is to be installed, and a decision by the technician as to the need and practicability of installing the practice on your farm and the number of units necessary to assure a satisfactory job. This tentative approval will be canceled if the technician finds that the practice is not needed on your farm to solve a conservation problem for which it is designed or that it is not practicable to install it. It will also be canceled if it is found that the practice otherwise does not qualify for cost-sharing under the provisions of the program.

Under the provisions of the program, you must develop the conditions for installing the practice to meet ACP specifications. If more detailed plans must be developed for the practice than can be developed during this visit, the technician will advise you of the requirements and assist you in the arrangements for the preparation and approval of the required plans. Please discuss with him any problems you have in connection with completing the practice. You should, if possible, be with the technician on the job so as to reach mutual agreement on what is to be done.

We shall notify you whether the practice is finally approved for ACP cost-sharing and, if it is approved, the extent to which the Federal Government will share in the cost of performing the practice, including the date by which the practice must be completed and its performance reported. While you are at liberty to start performance of the practice before a firm approval of cost-sharing is given by the ASC county committee, you will assume the risk that the practice may not be found eligible for ACP cost-sharing or that the work may not meet ACP practice specifications. If you find that you will be unable to carry out the practice, we shall appreciate your letting the ASC county committee know promptly so that unnecessary trips to your farm may be avoided.

Chester Turner
(FOR THE COUNTY COMMITTEE)

TILE RECORD MAP

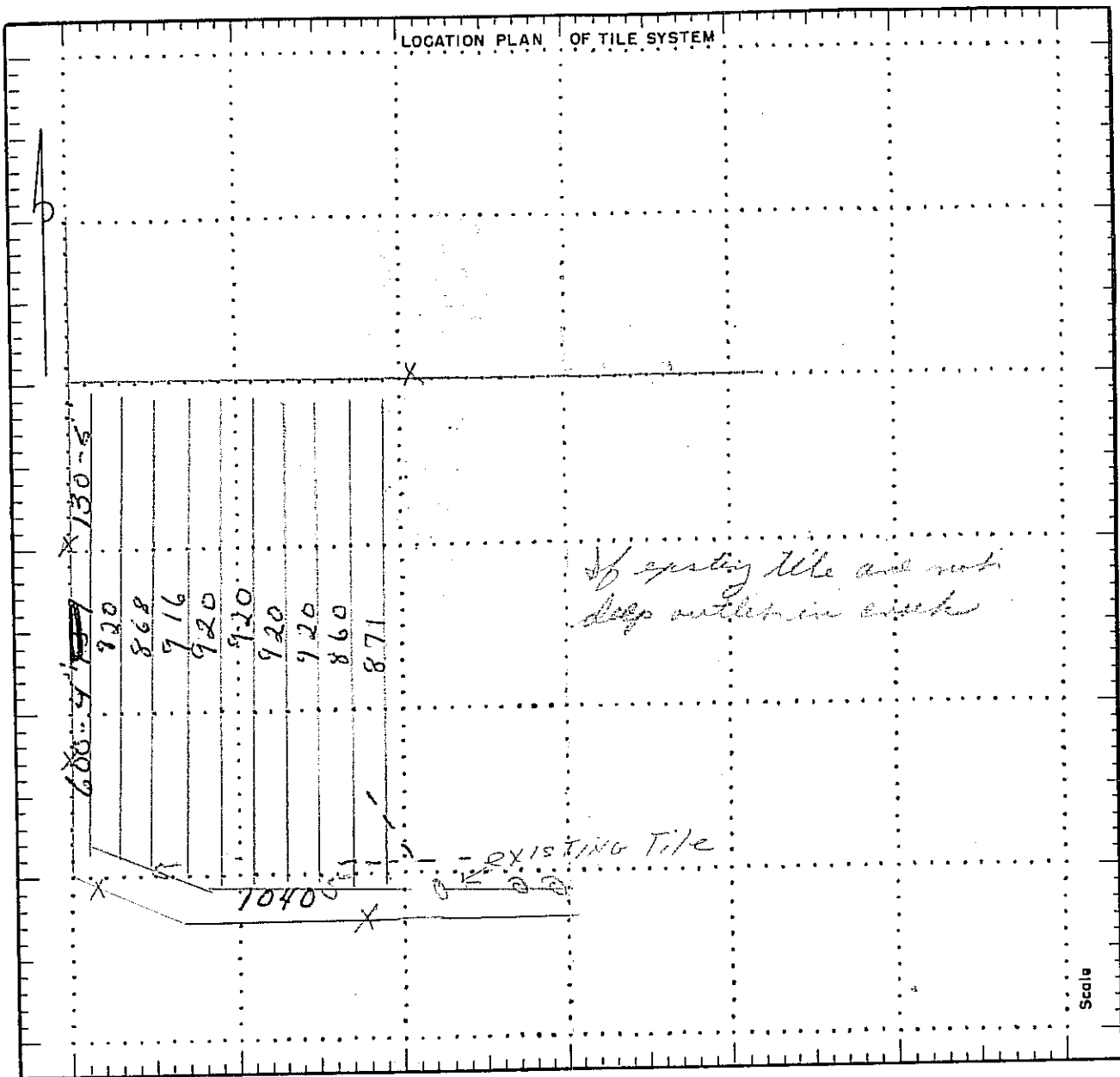

NAME K. Mollis

Section _____ Township _____ County _____

Contractor Neufman Date Installed March 81

Amount of Tile Installed: 5" 1,170 6" _____ 8" _____

4" 8,615 12" _____ Larger _____

Regular inspection of the tile system is essential. Prompt repair of any failure will keep the system in working order and maintenance costs low.

Tiling
Map.

2

382	4
332	
326	
357	

3

3

TILE RECORD MAP

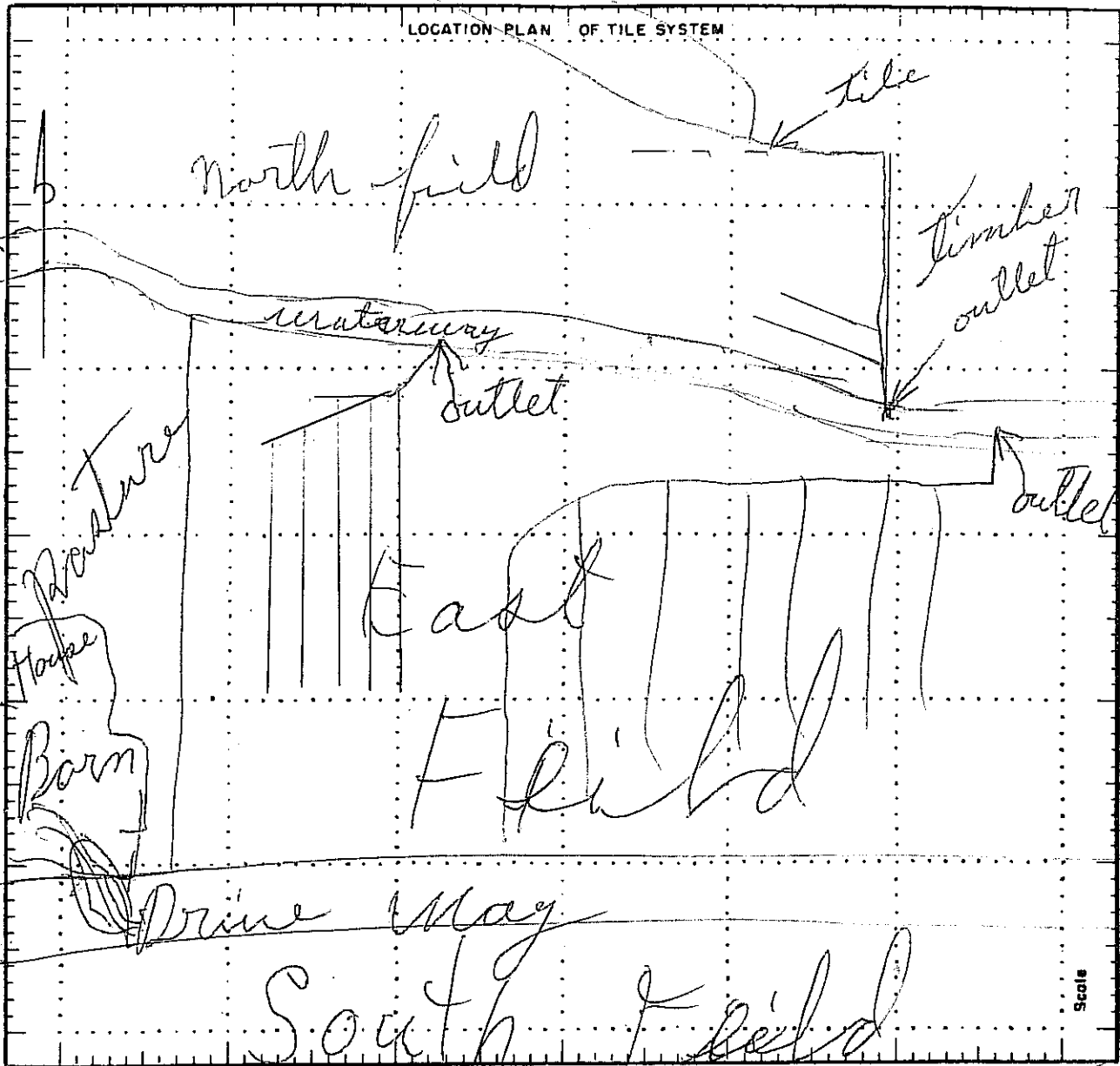

SCALE — 440 feet to the inch.

NAME

Ren m

South

Section

Township

County

Contractor

Date Installed

Amount of tile installed:

4" 5,800

5"

6"

8"

10"

Larger

Regular inspection of the tile system is essential. Prompt repair of any failure will keep the system in working order and maintenance costs low.

MEIGHAN DRAINAGE CONTRACTORS, SUMNER, IOWA