

# Soils Map

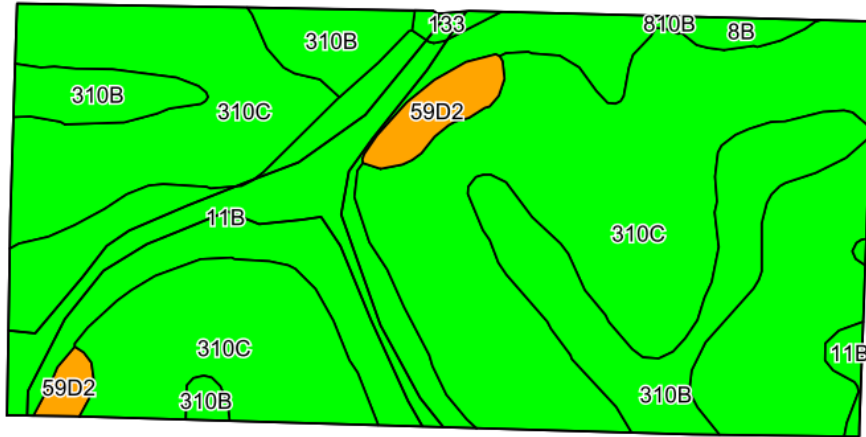

©2022 AgriData, Inc.

Soils data provided by USDA and NRCS.

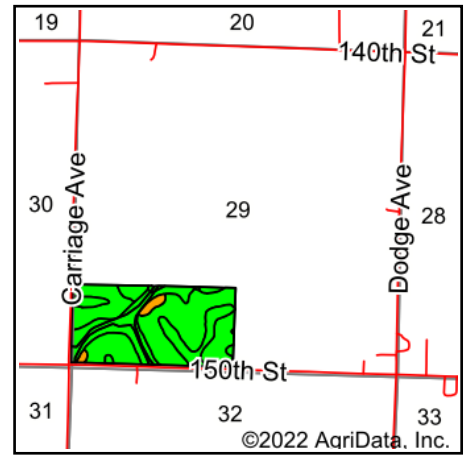

State: **Iowa**  
 County: **Ida**  
 Location: **29-89N-40W**  
 Township: **Griggs**  
 Acres: **78.77**  
 Date: **7/6/2022**



Maps Provided By:



© AgriData, Inc. 2021

www.AgriDataInc.com



Area Symbol: IA093, Soil Area Version: 32

Code	Soil Description	Acres	Percent of field	CSR2 Legend	Non-Irr Class *c	CSR2**	CSR
310C	Galva silty clay loam, 5 to 9 percent slopes	47.98	60.9%		IIIe	87	57
11B	Colo-Judson silty clay loams, 0 to 5 percent slopes, occasionally flooded	15.88	20.2%		IIw	80	62
310B	Galva silty clay loam, 2 to 5 percent slopes	11.65	14.8%		Ile	95	73
59D2	Burchard clay loam, 5 to 14 percent slopes	2.09	2.7%		IIIe	64	37
8B	Judson silty clay loam, deep loess, 2 to 5 percent slopes	0.70	0.9%		Ile	92	76
133	Colo silty clay loam, deep loess, 0 to 2 percent slopes, occasionally flooded	0.38	0.5%		IIw	78	75
810B	Galva silty clay loam, terrace, 2 to 5 percent slopes	0.09	0.1%		Ile	95	73
Weighted Average					2.64	86.2	60.1

\*\*IA has updated the CSR values for each county to CSR2.

\*c: Using Capabilities Class Dominant Condition Aggregation Method  
 Soils data provided by USDA and NRCS.