

Soils Map

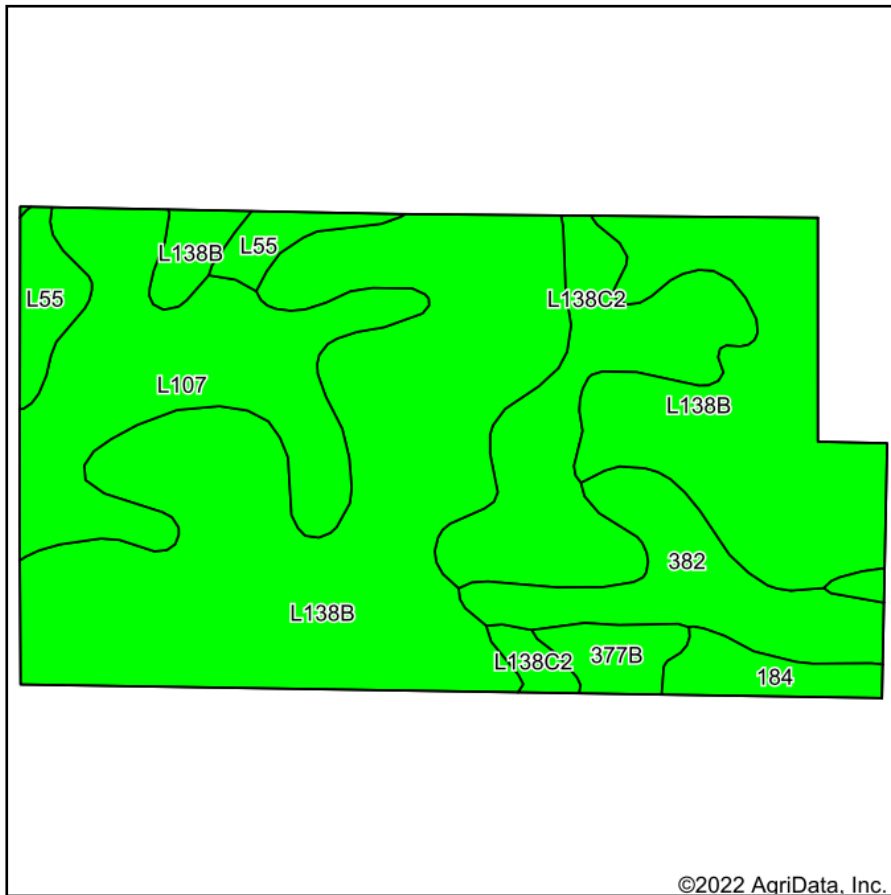

Soils data provided by USDA and NRCS.

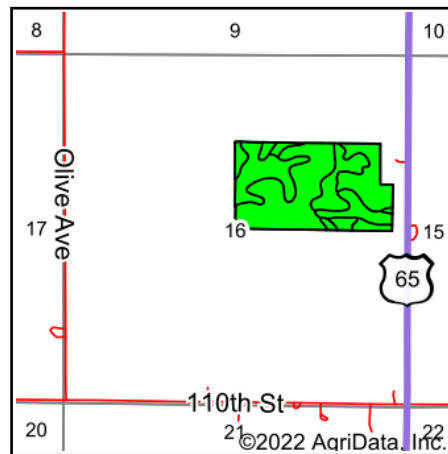

State: **Iowa**
 County: **Franklin**
 Location: **16-91N-20W**
 Township: **Reeve**
 Acres: **70.04**
 Date: **5/4/2022**



Maps Provided By:



Area Symbol: IA069, Soil Area Version: 28

Code	Soil Description	Acres	Percent of field	CSR2 Legend	Non-Irr Class *c	CSR2**	CSR	
L138B	Clarion loam, Bemis moraine, 2 to 6 percent slopes	38.89	55.5%		Ile	88		
L107	Webster clay loam, Bemis moraine, 0 to 2 percent slopes	11.28	16.1%		Ilw	88		
L138C2	Clarion loam, Bemis moraine, 6 to 10 percent slopes, moderately eroded	8.46	12.1%		IIIle	83		
382	Maxfield silty clay loam, 0 to 2 percent slopes	5.63	8.0%		Ilw	87	90	
L55	Nicollet loam, 1 to 3 percent slopes	2.47	3.5%		Ie	91		
184	Klinger silty clay loam, 1 to 4 percent slopes	1.91	2.7%		Iw	95	95	
377B	Dinsdale silty clay loam, 2 to 5 percent slopes	1.40	2.0%		Ile	94	90	
Weighted Average						2.06	87.7	*-

**IA has updated the CSR values for each county to CSR2.

*- CSR weighted average cannot be calculated on the current soils data, use prior data version for csr values.

*c: Using Capabilities Class Dominant Condition Aggregation Method

Soils data provided by USDA and NRCS.