

Soils Map

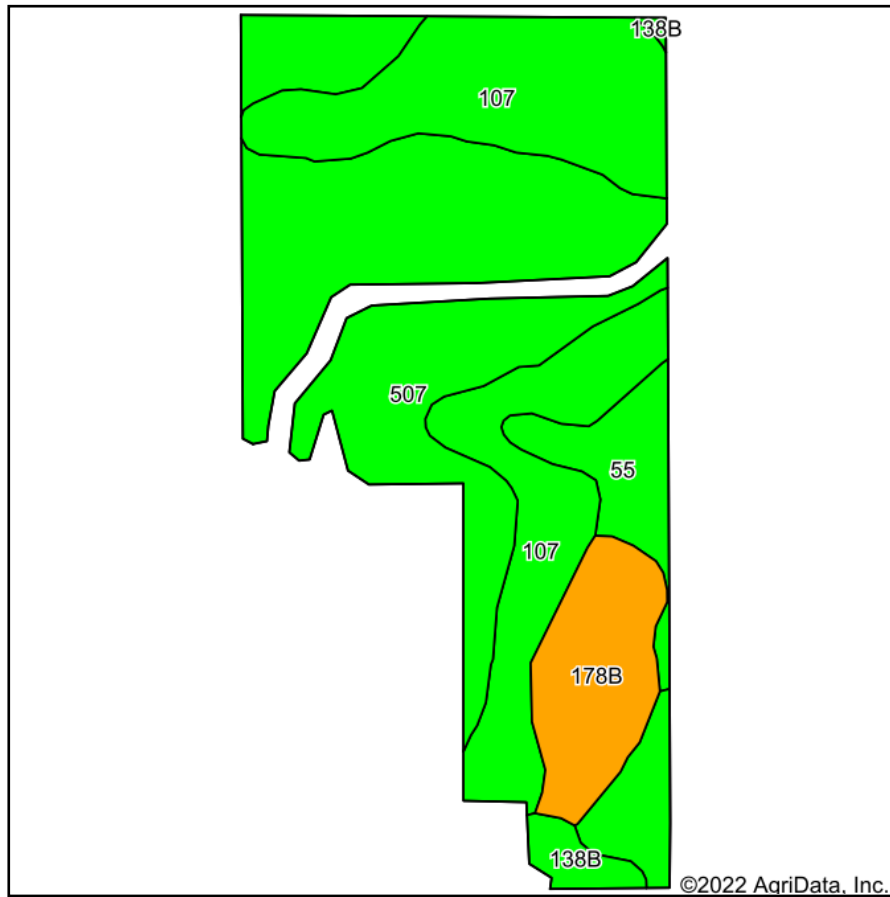

Soils data provided by USDA and NRCS.

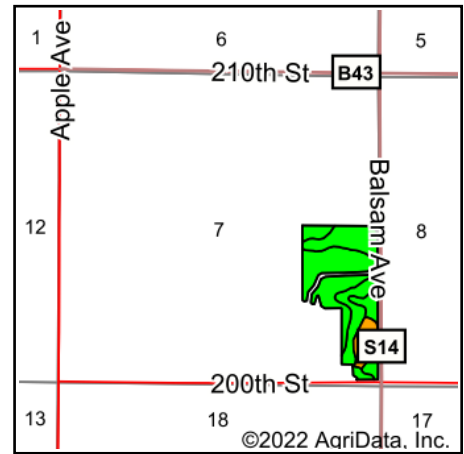

State: **Iowa**
 County: **Cerro Gordo**
 Location: **7-95N-22W**
 Township: **Union**
 Acres: **53.29**
 Date: **4/7/2022**



Maps Provided By:



Area Symbol: IA033, Soil Area Version: 25

Code	Soil Description	Acres	Percent of field	CSR2 Legend	Non-Irr Class *c	CSR2**	CSR
507	Canisteo clay loam, 0 to 2 percent slopes	23.59	44.3%		Ilw	84	78
107	Webster clay loam, 0 to 2 percent slopes	19.74	37.0%		Ilw	86	83
178B	Waukee loam, 2 to 5 percent slopes	5.47	10.3%		Ils	64	72
55	Nicollet clay loam, 1 to 3 percent slopes	3.33	6.2%		Iw	89	88
138B	Clarion loam, 2 to 6 percent slopes	1.16	2.2%		Ile	89	80
Weighted Average					1.94	83.1	79.9

**IA has updated the CSR values for each county to CSR2.

*c: Using Capabilities Class Dominant Condition Aggregation Method

Soils data provided by USDA and NRCS.