

# Soils Map

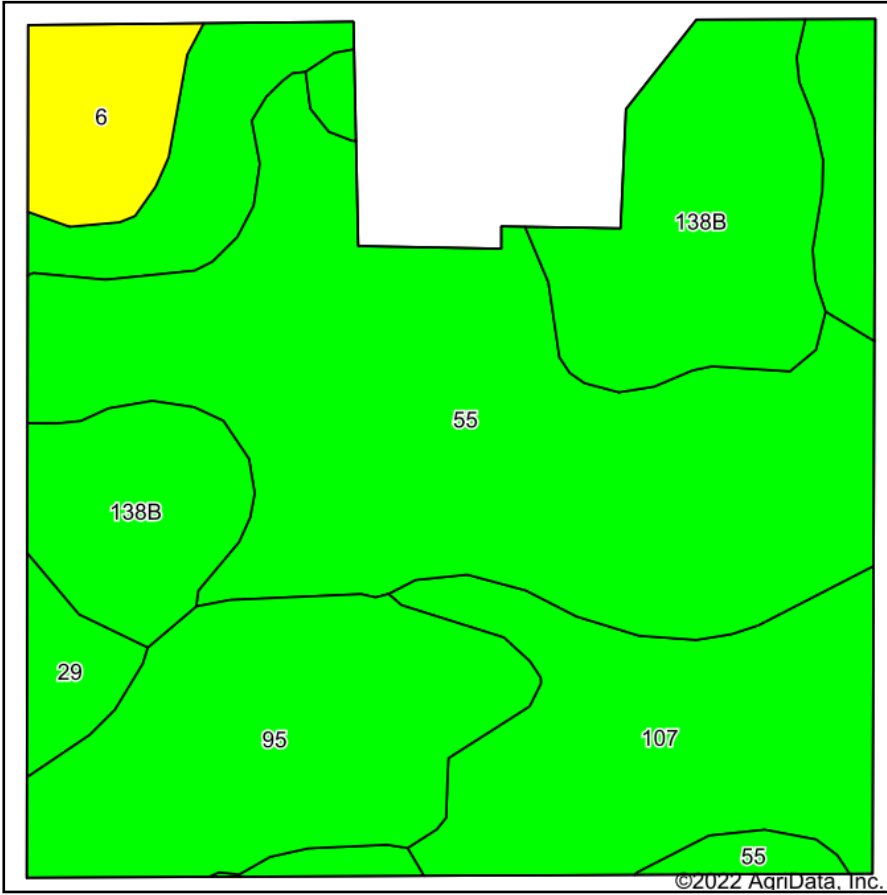

Soils data provided by USDA and NRCS.

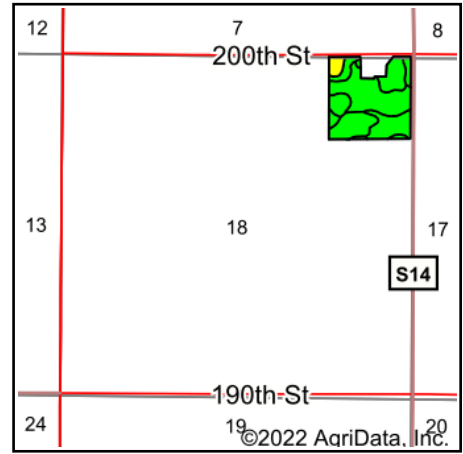

State: **Iowa**  
 County: **Cerro Gordo**  
 Location: **18-95N-22W**  
 Township: **Union**  
 Acres: **34.06**  
 Date: **4/7/2022**



Maps Provided By:  
  
 CUSTOMIZED ONLINE MAPPING  
 © AgriData, Inc. 2021 www.AgriDataInc.com



Area Symbol: IA033, Soil Area Version: 25

Code	Soil Description	Acres	Percent of field	CSR2 Legend	Non-Irr Class *c	CSR2**	CSR	
55	Nicollet clay loam, 1 to 3 percent slopes	12.59	37.0%		lw	89	88	
107	Webster clay loam, 0 to 2 percent slopes	7.83	23.0%		llw	86	83	
138B	Clarion loam, 2 to 6 percent slopes	6.20	18.2%		lle	89	80	
95	Harps clay loam, 0 to 2 percent slopes	5.23	15.4%		llw	72	62	
6	Okoboji silty clay loam, 0 to 1 percent slopes	1.47	4.3%		lllw	59	57	
29	Clarion-Nicollet loams, 1 to 3 percent slopes	0.74	2.2%		lw	89	85	
<b>Weighted Average</b>						<b>1.65</b>	<b>84.4</b>	<b>80</b>

\*\*IA has updated the CSR values for each county to CSR2.

\*c: Using Capabilities Class Dominant Condition Aggregation Method  
 Soils data provided by USDA and NRCS.