

Soils Map

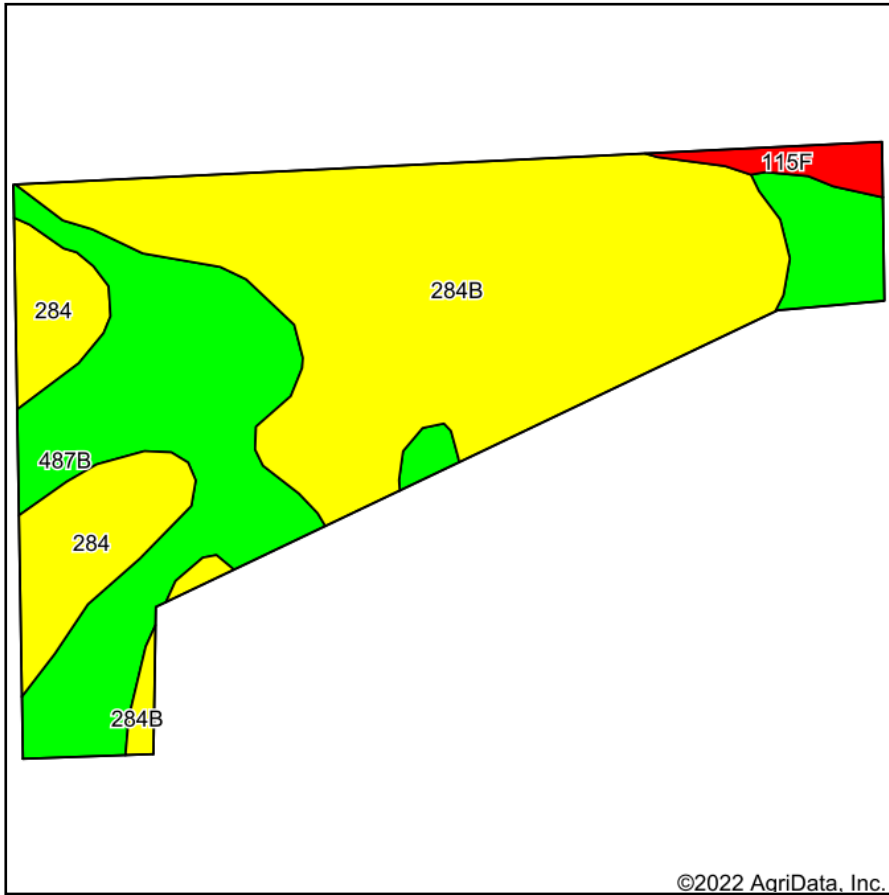

Soils data provided by USDA and NRCS.

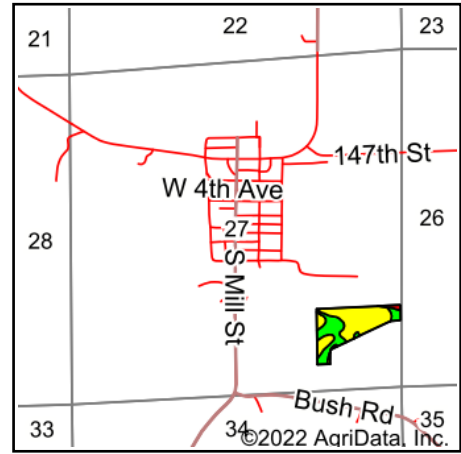

State: **Iowa**
 County: **Fayette**
 Location: **27-93N-7W**
 Township: **Illyria**
 Acres: **15.29**
 Date: **4/5/2022**



Maps Provided By:



© AgriData, Inc. 2021

www.AgriDataInc.com



Area Symbol: IA065, Soil Area Version: 26

Code	Soil Description	Acres	Percent of field	CSR2 Legend	Non-Irr Class *c	CSR2**	CSR	
284B	Flagler sandy loam, 2 to 5 percent slopes	8.18	53.5%		IIIe	49	45	
487B	Otter-Huntsville silt loams, 2 to 5 percent slopes	4.97	32.5%		IIIw	80	68	
284	Flagler sandy loam, 0 to 2 percent slopes	1.80	11.8%		IIIs	56	52	
115F	Sandy escarpments, 14 to 30 percent slopes	0.34	2.2%		VIIIs	5	5	
Weighted Average						3.09	58.9	52.4

**IA has updated the CSR values for each county to CSR2.

*c: Using Capabilities Class Dominant Condition Aggregation Method

Soils data provided by USDA and NRCS.