

Soils Map

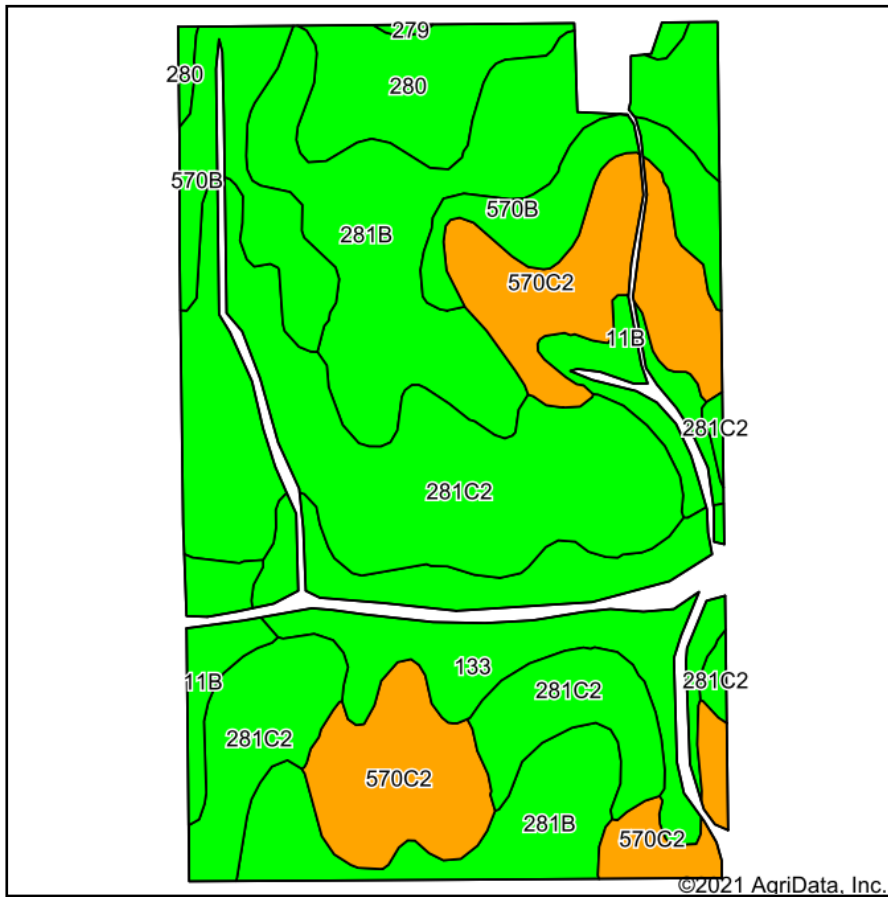

Soils data provided by USDA and NRCS.

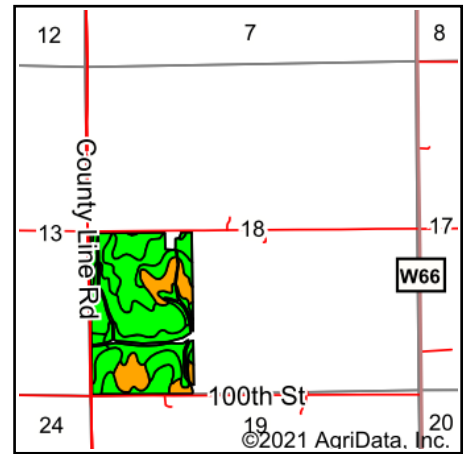

State: **Iowa**
 County: **Louisa**
 Location: **20-74N-5W**
 Township: **Elm Grove**
 Acres: **92.16**
 Date: **12/22/2021**



Maps Provided By:



Area Symbol: IA115, Soil Area Version: 25

Code	Soil Description	Acres	Percent of field	CSR2 Legend	Non-Irr Class *c	CSR2**	CSR
281C2	Otley silty clay loam, 5 to 9 percent slopes, eroded	27.00	29.3%		IIIe	82	70
281B	Otley silty clay loam, 2 to 5 percent slopes	20.37	22.1%		Ile	91	90
570C2	Nira silty clay loam, 5 to 9 percent slopes, moderately eroded	14.71	16.0%		IIIe	70	67
133	Colo silty clay loam, 0 to 2 percent slopes, occasionally flooded	10.85	11.8%		IIw	78	80
570B	Nira silty clay loam, 2 to 5 percent slopes	8.91	9.7%		Ile	81	87
280	Mahaska silty clay loam, 0 to 2 percent slopes	5.68	6.2%		Iw	94	95
11B	Colo-Ely complex, 0 to 5 percent slopes	4.55	4.9%		IIw	86	68
279	Taintor silty clay loam, 0 to 2 percent slopes	0.09	0.1%		IIw	83	88
Weighted Average					2.39	82.4	78.2

**IA has updated the CSR values for each county to CSR2.

*c: Using Capabilities Class Dominant Condition Aggregation Method

Soils data provided by USDA and NRCS.