

Soils Map

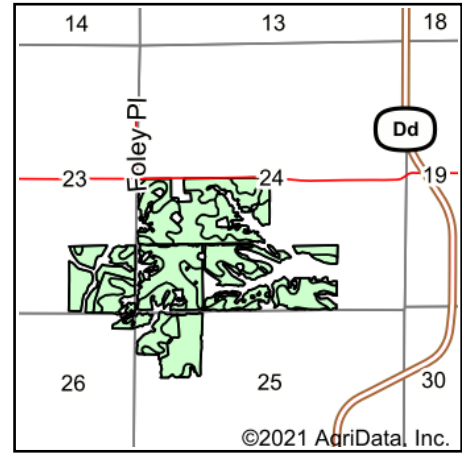

State: **Missouri**
 County: **Mercer**
 Location: **24-65N-23W**
 Township: **Ravanna**
 Acres: **204.46**
 Date: **11/17/2021**

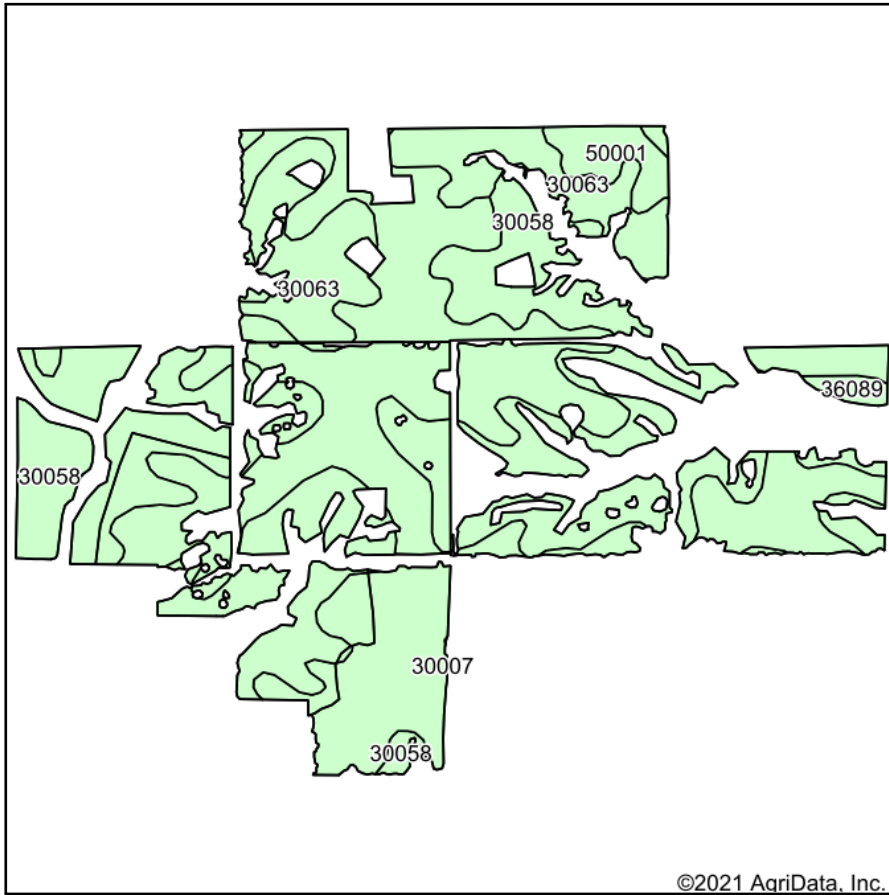

Maps Provided By:
surety
 CUSTOMIZED ONLINE MAPPING
 © AgriData, Inc. 2021 www.AgriDataInc.com



Soils data provided by USDA and NRCS.

©2021 AgriData, Inc.

Area Symbol: MO129, Soil Area Version: 22

Code	Soil Description	Acres	Percent of field	Non-Irr Class *c	Alfalfa hay Tons	Caucasian bluestem Tons	Common bermudagrass Tons	Corn	Corn Bu	Grain sorghum Bu	Orchardgrass red clover Tons	Soybeans Bu	Tall fescue Tons	Warm season grasses Tons	Winter wheat Bu
30007	Adair loam, 5 to 9 percent slopes, eroded	89.56	43.8%	IIIe	5	8	7					8	7	8	
30058	Gara loam, 14 to 18 percent slopes, moderately eroded	78.83	38.6%	VIe											
30063	Gara loam, 9 to 14 percent slopes, moderately eroded	29.38	14.4%	IVe											
50001	Armstrong loam, 5 to 9 percent slopes, eroded	5.17	2.5%	IIIe	5	8	7	5	5	4	8	2	7	8	2
36089	Nodaway-Humeston-Vigar complex, 1 to 6 percent slopes	1.52	0.7%	IIIw			7				8		8	10	
Weighted Average				4.30	2.3	3.7	3.3	0.1	0.1	0.1	3.8	0.1	3.3	3.8	0.1

*c: Using Capabilities Class Dominant Condition Aggregation Method
 Soils data provided by USDA and NRCS.