

Soils Map

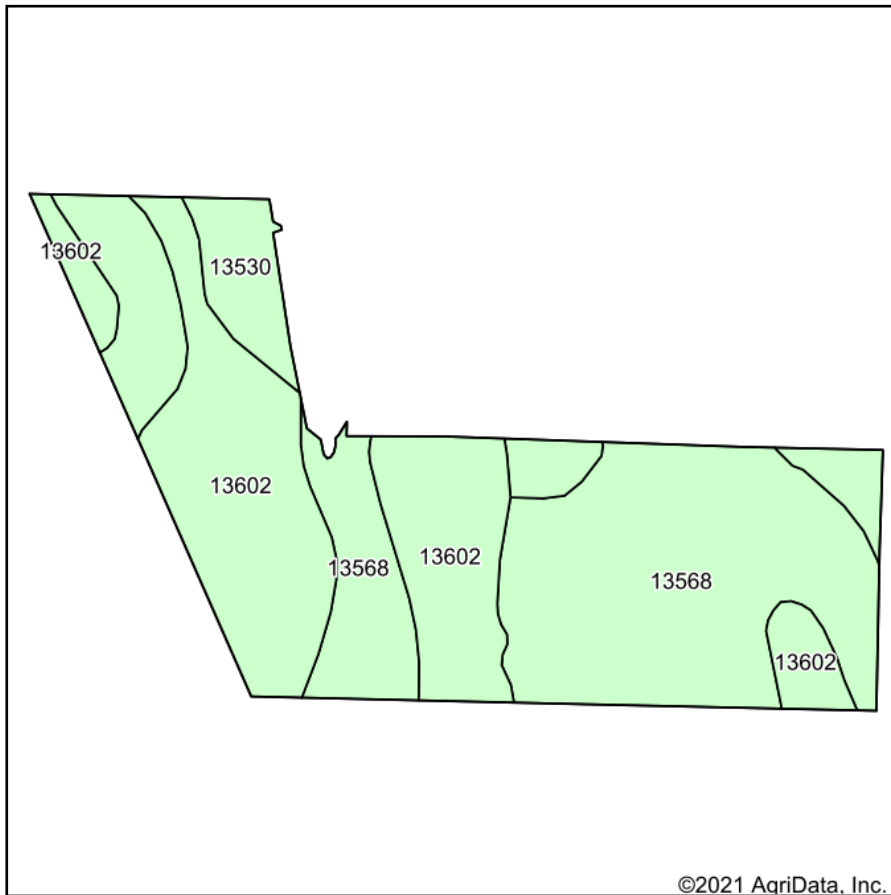

Soils data provided by USDA and NRCS.

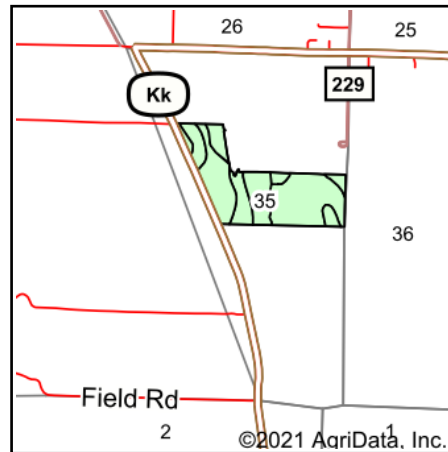

State: **Missouri**
 County: **Buchanan**
 Location: **35-56N-37W**
 Township: **Lake**
 Acres: **47.72**
 Date: **10/28/2021**



Maps Provided By:



© AgriData, Inc. 2021

www.AgriDataInc.com



Area Symbol: MO021, Soil Area Version: 22

| Code | Soil Description | Acres | Percent of field | Non-Irr Class *c | Irr Class *c | Common bermudagrass Tons | Orchardgrass red clover Tons | Tall fescue Tons | Warm season grasses Tons |
|-------------------------|---|-------|------------------|------------------|--------------|--------------------------|------------------------------|------------------|--------------------------|
| 13568 | Onawa silty clay, 0 to 2 percent slopes, rarely flooded | 24.72 | 51.8% | IIw | IIw | 7 | 7 | 8 | 9 |
| 13602 | Haynie silt loam, 0 to 2 percent slopes, rarely flooded | 18.44 | 38.6% | Iw | | 7 | 8 | 8 | 10 |
| 13530 | Haynie-Onawa complex, 0 to 2 percent slopes, rarely flooded | 4.56 | 9.6% | Iw | | 8 | 8 | 8 | 9 |
| Weighted Average | | | | 1.52 | 1.04 | 7.1 | 7.5 | 8 | 9.4 |

*c: Using Capabilities Class Dominant Condition Aggregation Method
 Soils data provided by USDA and NRCS.