

Soils Map

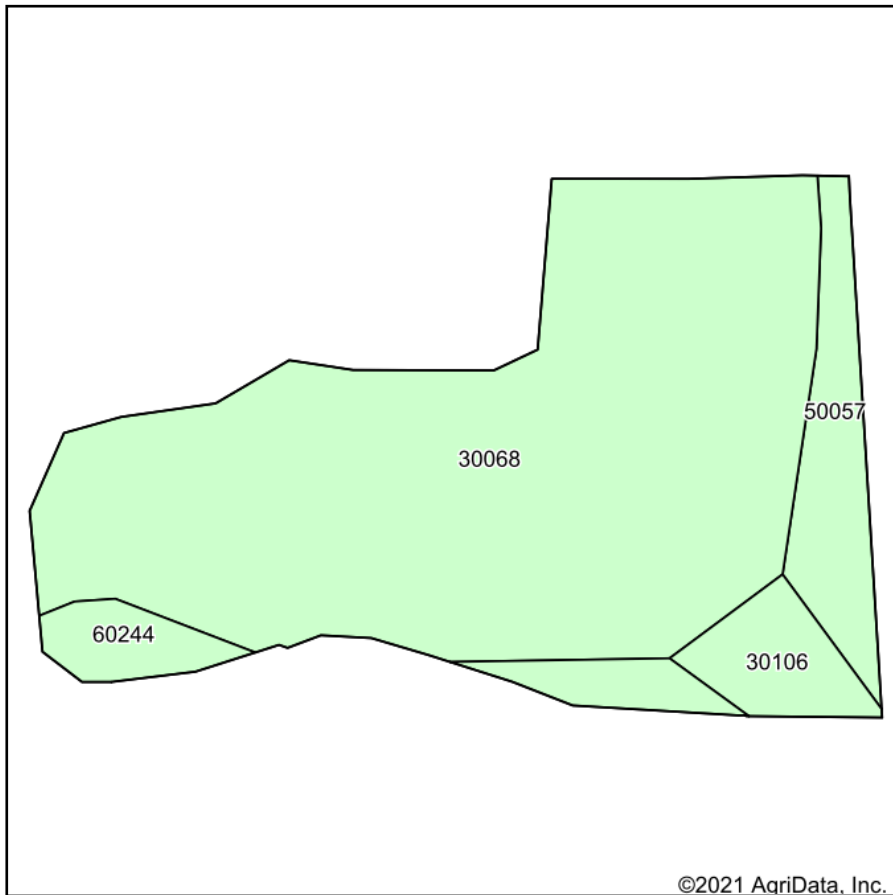

Soils data provided by USDA and NRCS.

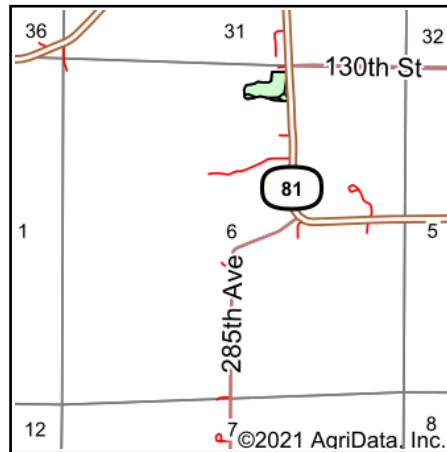

State: **Missouri**
 County: **Lewis**
 Location: **6-62N-6W**
 Township: **Canton**
 Acres: **4.74**
 Date: **10/7/2021**



Maps Provided By:



Area Symbol: MO111, Soil Area Version: 22

Code	Soil Description	Acres	Percent of field	Non-Irr Class *c	Corn Bu	Grass legume hay Tons	Grass legume pasture Tons	Soybeans Bu	Wheat Bu
30068	Gorin silt loam, 5 to 9 percent slopes, eroded	3.75	79.1%	IIIe					
50057	Putnam silt loam, 1 to 3 percent slopes	0.42	8.9%	IIIw					
60244	Winfield silt loam, 5 to 10 percent slopes, eroded	0.32	6.8%	IIIe	132	4.1	6.8	40	52
30106	Kilwinning silt loam, 1 to 5 percent slopes	0.25	5.3%	IIIe					
Weighted Average				3.00	8.9	0.3	0.5	2.7	3.5

*c: Using Capabilities Class Dominant Condition Aggregation Method
 Soils data provided by USDA and NRCS.