

Soils Map

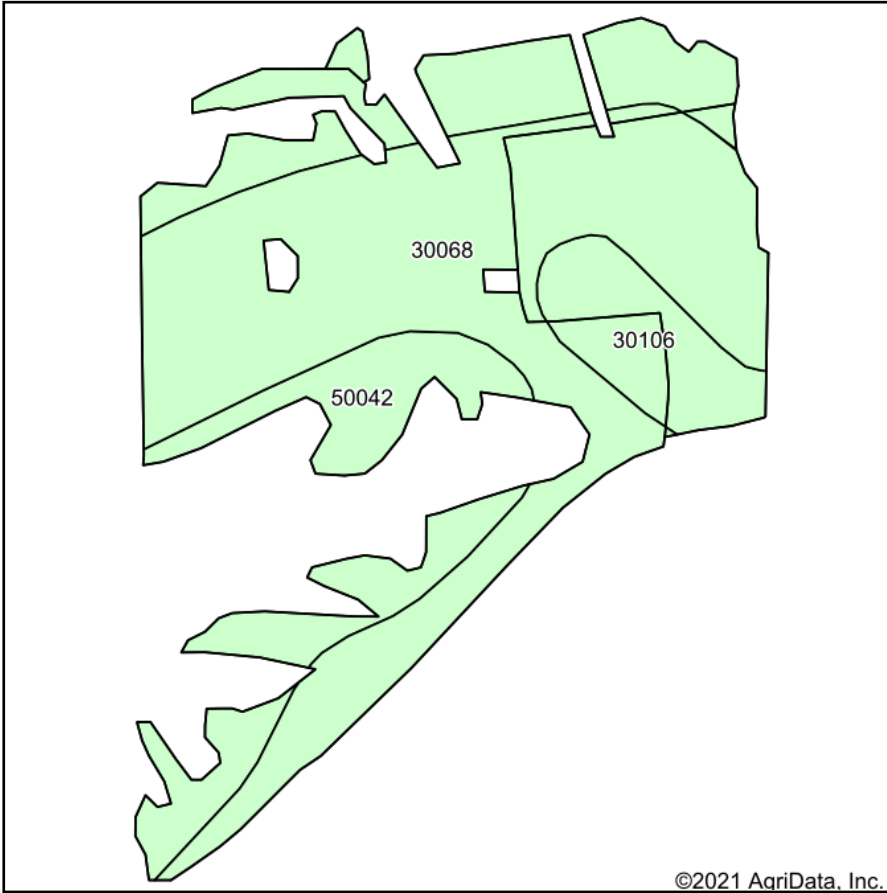

Soils data provided by USDA and NRCS.

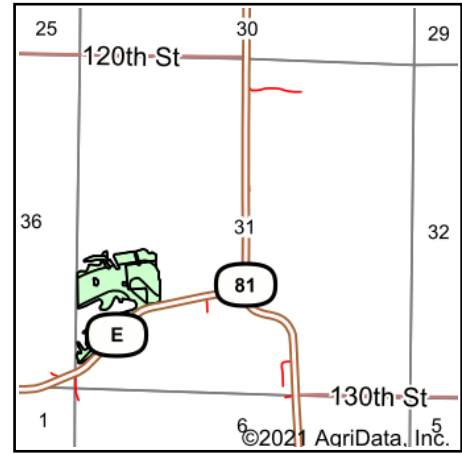

State: **Missouri**
 County: **Lewis**
 Location: **31-63N-6W**
 Township: **Canton**
 Acres: **25.52**
 Date: **10/7/2021**



Maps Provided By:



© AgriData, Inc. 2021

www.AgriDataInc.com



Area Symbol: MO111, Soil Area Version: 22

Code	Soil Description	Acres	Percent of field	Non-Irr Class *c	Alfalfa hay Tons	Caucasian bluestem Tons	Common bermudagrass Tons	Orchardgrass red clover Tons	Tall fescue Tons	Warm season grasses Tons
30068	Gorin silt loam, 5 to 9 percent slopes, eroded	14.49	56.8%	IIIe	5	7	6	7	6	7
50042	Lindley loam, 20 to 35 percent slopes, eroded	8.64	33.9%	VIe						
30106	Kilwinning silt loam, 1 to 5 percent slopes	2.39	9.4%	IIIe		2	8	7	8	10
Weighted Average				4.02	2.8	4.2	4.2	4.6	4.2	4.9

*c: Using Capabilities Class Dominant Condition Aggregation Method
 Soils data provided by USDA and NRCS.