

Soils Map

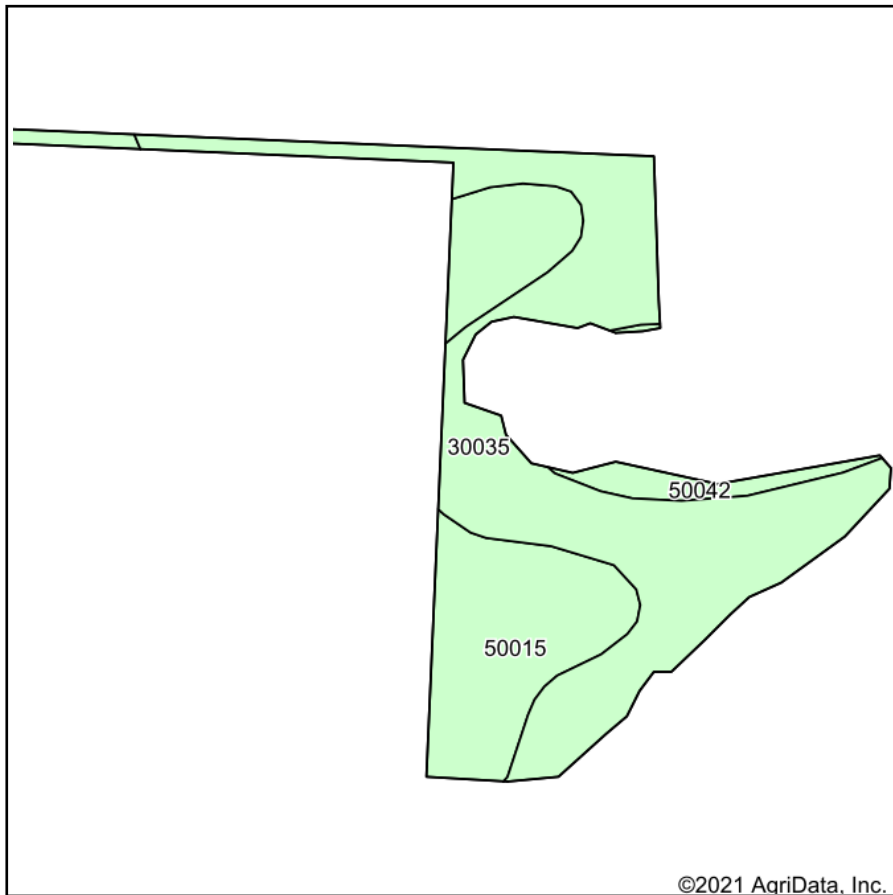

Soils data provided by USDA and NRCS.

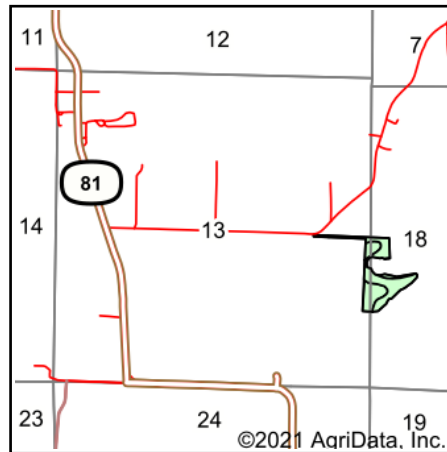

State: **Missouri**
 County: **Clark**
 Location: **13-63N-7W**
 Township: **Jackson**
 Acres: **12.87**
 Date: **10/7/2021**



Maps Provided By:



© AgriData, Inc. 2021

www.AgriDataInc.com



Area Symbol: MO045, Soil Area Version: 23

Code	Soil Description	Acres	Percent of field	Non-Irr Class *c	Alfalfa hay Tons	Caucasian bluestem Tons	Common bermudagrass Tons	Orchardgrass red clover Tons	Tall fescue Tons	Warm season grasses Tons
30035	Armstrong loam, 5 to 12 percent slopes, eroded	7.70	59.8%	IIIe	5	8	7	8	7	8
50015	Adco silt loam, 1 to 5 percent slopes	4.62	35.9%	IIIe	5	8	7	8	7	8
50042	Lindley loam, 20 to 35 percent slopes, eroded	0.55	4.3%	VIe						
Weighted Average				3.13	4.8	7.7	6.7	7.7	6.7	7.7

*c: Using Capabilities Class Dominant Condition Aggregation Method
 Soils data provided by USDA and NRCS.