

# Soils Map

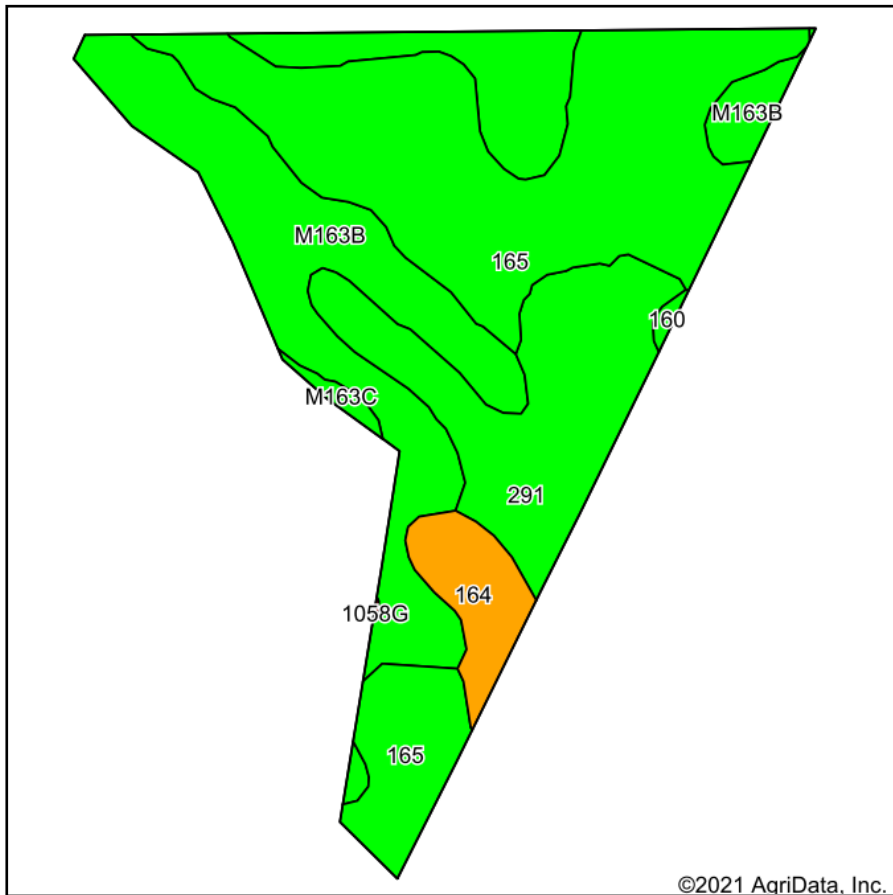

Soils data provided by USDA and NRCS.

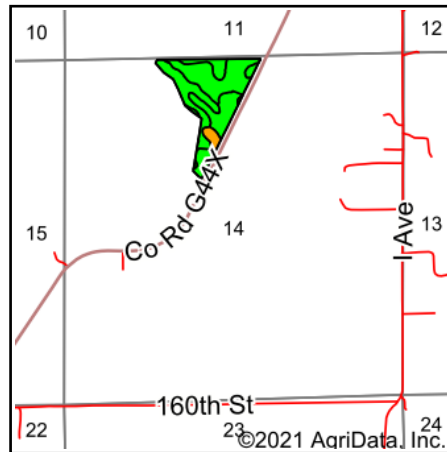

State: **Iowa**  
 County: **Louisa**  
 Location: **14-75N-3W**  
 Township: **Grandview**  
 Acres: **28.49**  
 Date: **9/20/2021**



Maps Provided By:  
  
 CUSTOMIZED ONLINE MAPPING  
 © AgriData, Inc. 2021 [www.AgriDataInc.com](http://www.AgriDataInc.com)



Area Symbol: IA115, Soil Area Version: 24

Code	Soil Description	Acres	Percent of field	CSR2 Legend	Non-Irr Class *c	CSR2**	CSR	Bromegrass alfalfa	Corn	Oats	Soybeans
165	Stronghurst silt loam, 0 to 2 percent slopes	12.03	42.2%		Iw	86	90				
M163B	Fayette silt loam, till plain, 2 to 5 percent slopes	9.55	33.5%		Ile	84		1	9	4	3
291	Atterberry silt loam, 0 to 2 percent slopes	5.20	18.3%		Iw	90	95				
164	Traer silt loam, 0 to 2 percent slopes	1.43	5.0%		IIIw	62	60				
M163C	Fayette silt loam, till plain, 5 to 9 percent slopes	0.19	0.7%		IIIe	79		1	9	4	3
160	Walford silt loam, 0 to 1 percent slopes	0.09	0.3%		IIIw	85	65				
<b>Weighted Average</b>						<b>84.8</b>	<b>*-</b>	<b>0.3</b>	<b>3.1</b>	<b>1.4</b>	<b>1</b>

\*\*IA has updated the CSR values for each county to CSR2.

\*- CSR weighted average cannot be calculated on the current soils data, use prior data version for csr values.

\*c: Using Capabilities Class Dominant Condition Aggregation Method

Soils data provided by USDA and NRCS.