

Soils Map

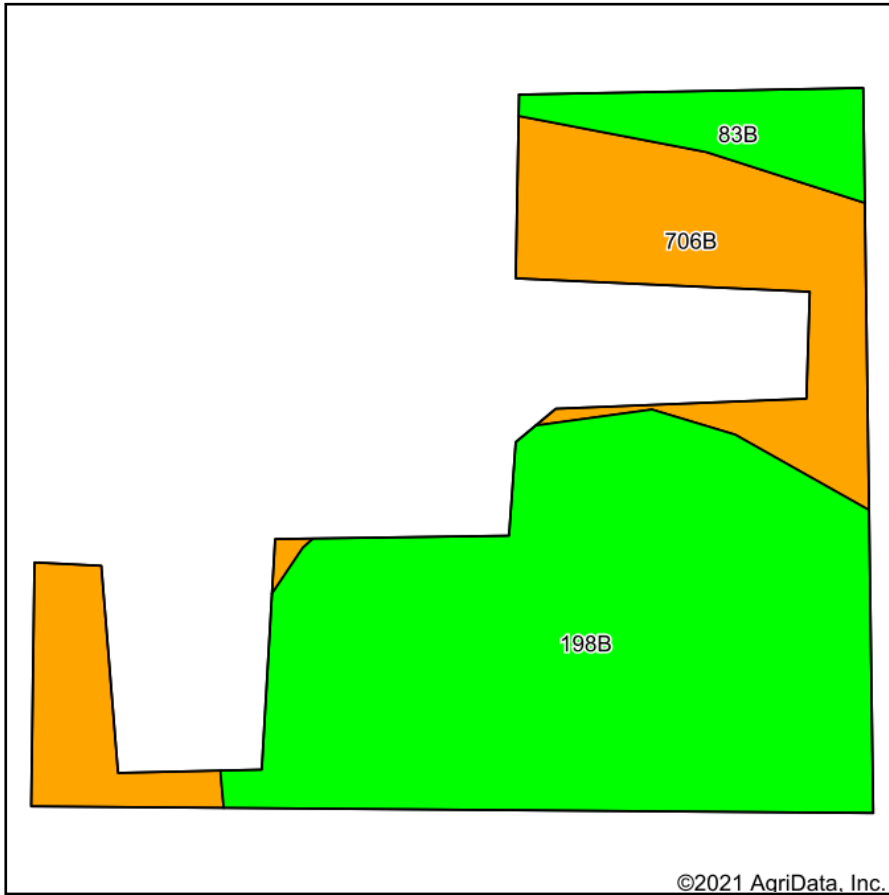

Soils data provided by USDA and NRCS.

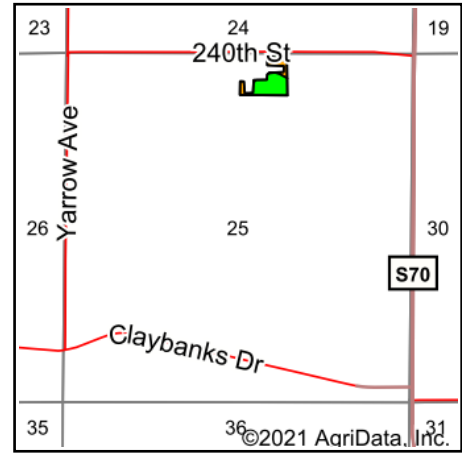

State: **Iowa**
 County: **Cerro Gordo**
 Location: **25-96N-19W**
 Township: **Portland**
 Acres: **5.21**
 Date: **9/16/2021**



Maps Provided By:



© AgriData, Inc. 2021

www.AgriDataInc.com



Area Symbol: IA033, Soil Area Version: 24

Code	Soil Description	Acres	Percent of field	CSR2 Legend	Non-Irr Class *c	CSR2**	CSR	Bromegrass alfalfa	Bromegrass alfalfa hay	Corn	Kentucky bluegrass	Oats	Smooth bromegrass	Soybeans
198B	Floyd loam, 1 to 4 percent slopes	3.37	64.7%		IIw	89	78							
706B	Cerlin silt loam, 2 to 5 percent slopes	1.48	28.4%		IIe	64	58							
83B	Kenyon loam, 2 to 5 percent slopes	0.36	6.9%		IIe	90	83	11	6.6	210	3.9	91	6.6	61
Weighted Average						82	72.7	0.8	0.5	14.5	0.3	6.3	0.5	4.2

**IA has updated the CSR values for each county to CSR2.

*c: Using Capabilities Class Dominant Condition Aggregation Method

Soils data provided by USDA and NRCS.