

Soils Map

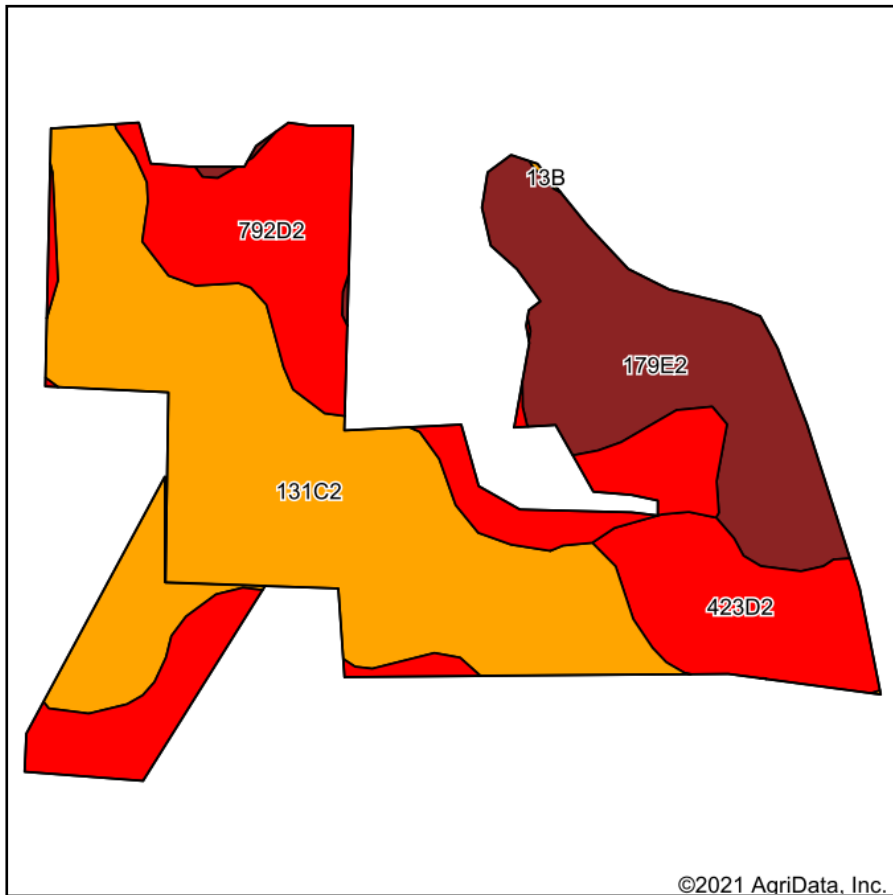

Soils data provided by USDA and NRCS.

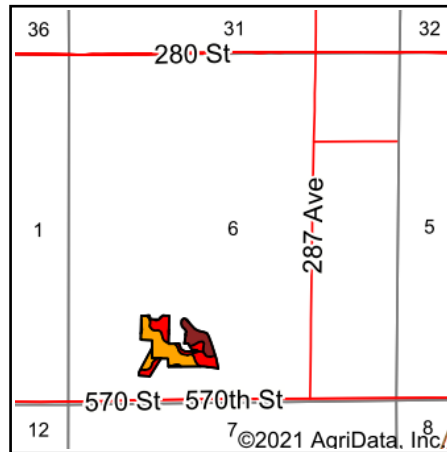

State: **Iowa**
 County: **Lucas**
 Location: **6-73N-20W**
 Township: **Pleasant**
 Acres: **14.13**
 Date: **8/27/2021**



Maps Provided By:



© AgriData, Inc. 2021

www.AgriDataInc.com



Area Symbol: IA117, Soil Area Version: 29

Code	Soil Description	Acres	Percent of field	CSR2 Legend	Non-Irr Class *c	CSR2**	CSR
131C2	Pershing silty clay loam, 5 to 9 percent slopes, moderately eroded	6.35	44.9%		IIIe	62	45
792D2	Armstrong clay loam, 9 to 14 percent slopes, moderately eroded	3.43	24.3%		IVe	5	13
179E2	Gara clay loam, 14 to 18 percent slopes, moderately eroded	2.86	20.2%		VIe	23	33
423D2	Bucknell silty clay loam, 9 to 14 percent slopes, moderately eroded	1.49	10.5%		IVe	6	13
Weighted Average						34.4	31.4

**IA has updated the CSR values for each county to CSR2.

*c: Using Capabilities Class Dominant Condition Aggregation Method

Soils data provided by USDA and NRCS.