

Soils Map

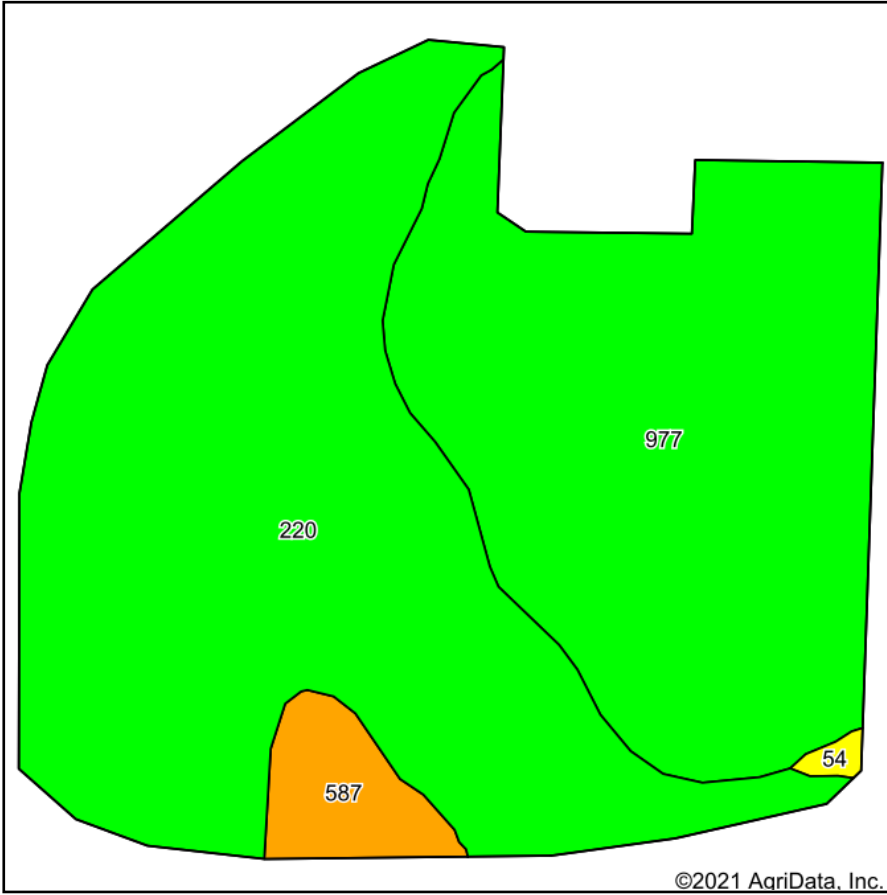

Soils data provided by USDA and NRCS.

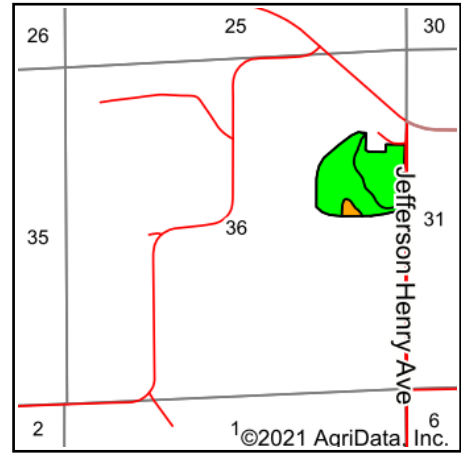

State: **Iowa**
 County: **Jefferson**
 Location: **36-73N-8W**
 Township: **Walnut**
 Acres: **33.54**
 Date: **7/22/2021**







Maps Provided By:

 CUSTOMIZED ONLINE MAPPING
 © AgriData, Inc. 2021 www.AgriDataInc.com



Area Symbol: IA101, Soil Area Version: 28

Code	Soil Description	Acres	Percent of field	CSR2 Legend	Non-Irr Class *c	CSR2**	CSR
220	Nodaway silt loam, shallow loess, 0 to 2 percent slopes, occasionally flooded	18.19	54.2%		Ilw	77	87
977	Richwood silt loam, 0 to 2 percent slopes	13.92	41.5%		lw	98	95
587	Chequest silty clay loam, 0 to 2 percent slopes	1.30	3.9%		Ilw	61	65
54	Zook silty clay loam, 0 to 2 percent slopes, occasionally flooded	0.13	0.4%		Ilw	60	70
Weighted Average						85	89.4

**IA has updated the CSR values for each county to CSR2.

*c: Using Capabilities Class Dominant Condition Aggregation Method

Soils data provided by USDA and NRCS.