

IN THE NW 1/4 OF
SECTION 33-146-45
NORMAN COUNTY, MINNESOTA

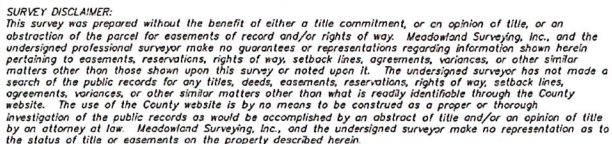

I hereby certify that this survey, plan, or report was prepared by me or under my direct supervision and that I am a duly Licensed Land Surveyor under the laws of the State of Minnesota.

Scott R. Walz
Print Name: _____
Signature: _____
May 26, 2021
Date: _____ 50320
License # _____

DRAWING NUMBER: T9924-15



1118 Hwy 59 South, Detroit Lakes, Minnesota 56501
(office) 218-847-4289 (fax) 218-846-1945
www.meadowlandsurveying.com

Jimmy Dale – Tract A – Southerly tract to be sold

Land description:

That part of the Northwest Quarter in Section 33, Township 146 North, Range 45 West of the Fifth Principal Meridian in Norman County, Minnesota, described as follows:

Commencing at an iron monument which designates the northwest corner of said Section 33; thence South 00 degrees 44 minutes 14 seconds East 1293.22 feet on an assumed bearing along the west line of said Section 33 to the point of beginning; thence North 89 degrees 43 minutes 31 seconds East 36.60 feet to an iron monument; thence continuing North 89 degrees 43 minutes 31 seconds East 2585.01 feet to an iron monument on the north-south quarter line of said Section 33; thence South 00 degrees 49 minutes 18 seconds East 702.03 feet along the north-south quarter line of said Section 33 to an iron monument at the southeast corner of the North Half of the South Half of the Northwest Quarter in said Section 33; thence South 89 degrees 44 minutes 08 seconds West 2587.57 feet along the south line of said North Half of the South Half of the Northwest Quarter to an iron monument; thence continuing South 89 degrees 44 minutes 08 seconds West 35.08 feet along the south line of said North Half of the South Half of the Northwest Quarter to the southwest corner of said North Half of the South Half of the Northwest Quarter; thence North 00 degrees 44 minutes 14 seconds West 701.55 feet along the west line of said Section 33 to the point of beginning. The above described tract contains 42.24 acres.

SUBJECT TO the rights of the public for road purposes for 310th Street over, under and across the westerly part of the above described tract.

I hereby certify that this survey, plan, or report was prepared by me or under my direct supervision and that I am a duly Licensed Land Surveyor under the laws of the State of Minnesota and that the above legal description was prepared from information on Certificate of Survey T9924-15 dated May 26, 2021, and said legal description is legally sufficient to locate the boundary lines shown on said Certificate of Survey.

Scott R. Walz
Minnesota Licensed Land Surveyor No. 50320