

Soils Map

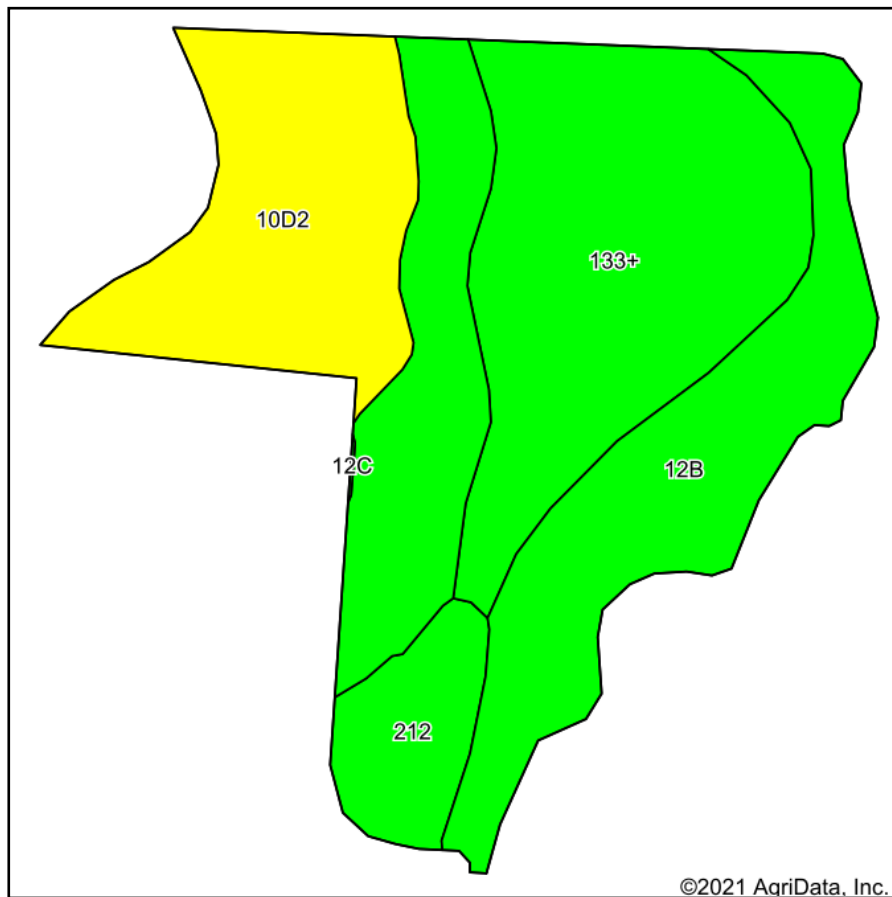

Soils data provided by USDA and NRCS.

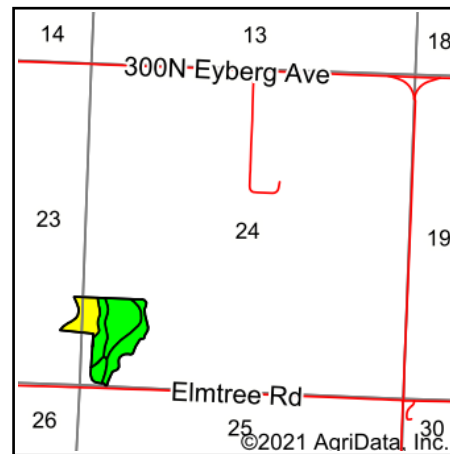

State: **Iowa**
 County: **Pottawattamie**
 Location: **24-75N-42W**
 Township: **Hardin**
 Acres: **25.56**
 Date: **4/19/2021**



Maps Provided By:



© AgriData, Inc. 2021

www.AgriDataInc.com



Area Symbol: IA155, Soil Area Version: 26

Code	Soil Description	Acres	Percent of field	CSR2 Legend	Non-Irr Class *c	CSR2**	CSR
12B	Napier silt loam, 2 to 5 percent slopes	9.89	38.7%		Ile	93	77
133+	Colo silt loam, deep loess, 0 to 2 percent slopes, overwash, occasionally flooded	8.32	32.6%		IIlw	78	85
10D2	Monona silt loam, 9 to 14 percent slopes, eroded	5.56	21.8%		IIIle	60	53
212	Kennebec silt loam, 0 to 2 percent slopes, occasionally flooded	1.79	7.0%		Iw	91	86
Weighted Average						80.8	75

**IA has updated the CSR values for each county to CSR2.

*c: Using Capabilities Class Dominant Condition Aggregation Method

Soils data provided by USDA and NRCS.