

Soils Map

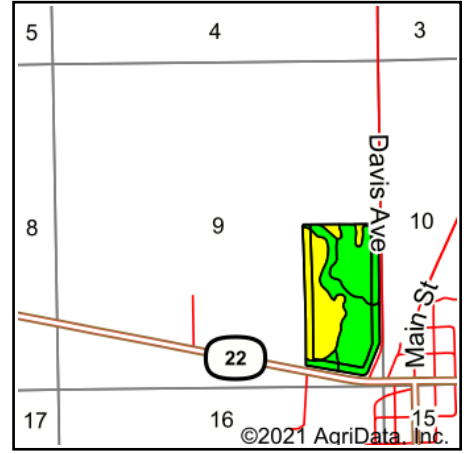

State: **Iowa**
 County: **Muscatine**
 Location: **9-77N-4W**
 Township: **Pike**
 Acres: **65.03**
 Date: **3/19/2021**

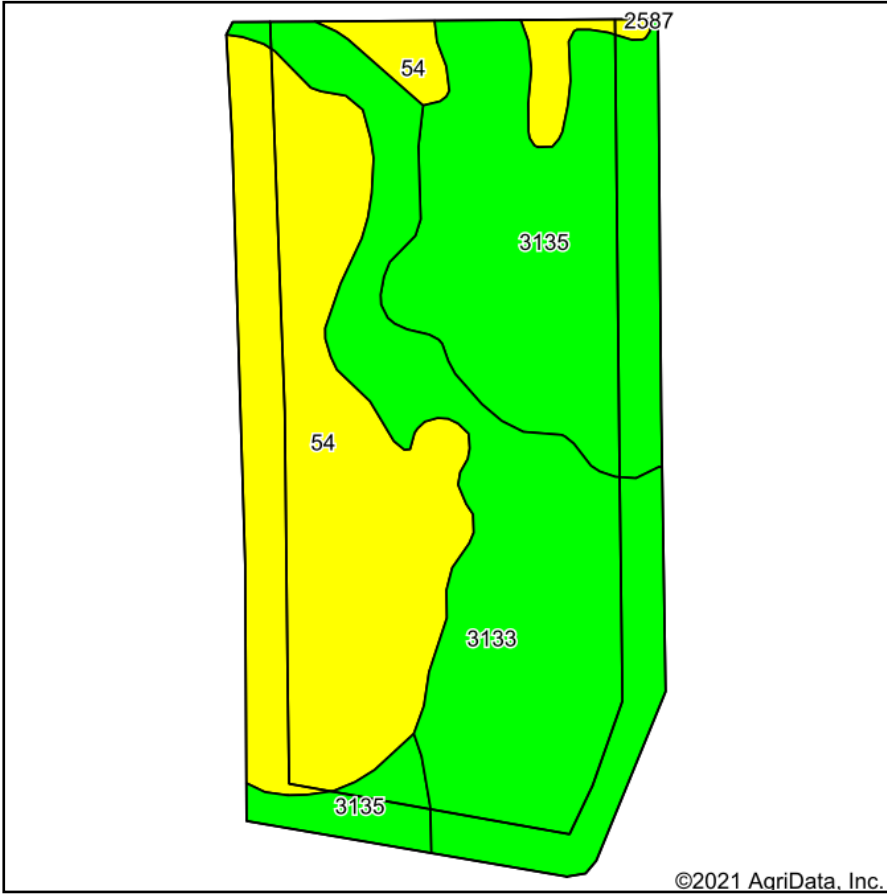



Maps Provided By:

 CUSTOMIZED ONLINE MAPPING
 © AgriData, Inc. 2021 www.AgriDataInc.com



Area Symbol: IA139, Soil Area Version: 26

Code	Soil Description	Acres	Percent of field	CSR2 Legend	Non-Irr Class *c	CSR2**	CSR
54	Zook silty clay loam, 0 to 2 percent slopes, occasionally flooded	23.66	36.4%		Ilw	60	
3133	Colo silty clay loam, 0 to 2 percent slopes, rarely flooded	21.95	33.8%		Ilw	84	80
3135	Coland clay loam, rarely flooded, 0 to 2 percent slopes	19.42	29.9%		Ilw	80	80
Weighted Average						74.1	*-

**IA has updated the CSR values for each county to CSR2.

*- CSR weighted average cannot be calculated on the current soils data, use prior data version for csr values.

*c: Using Capabilities Class Dominant Condition Aggregation Method

Soils data provided by USDA and NRCS.