

# Soils Map

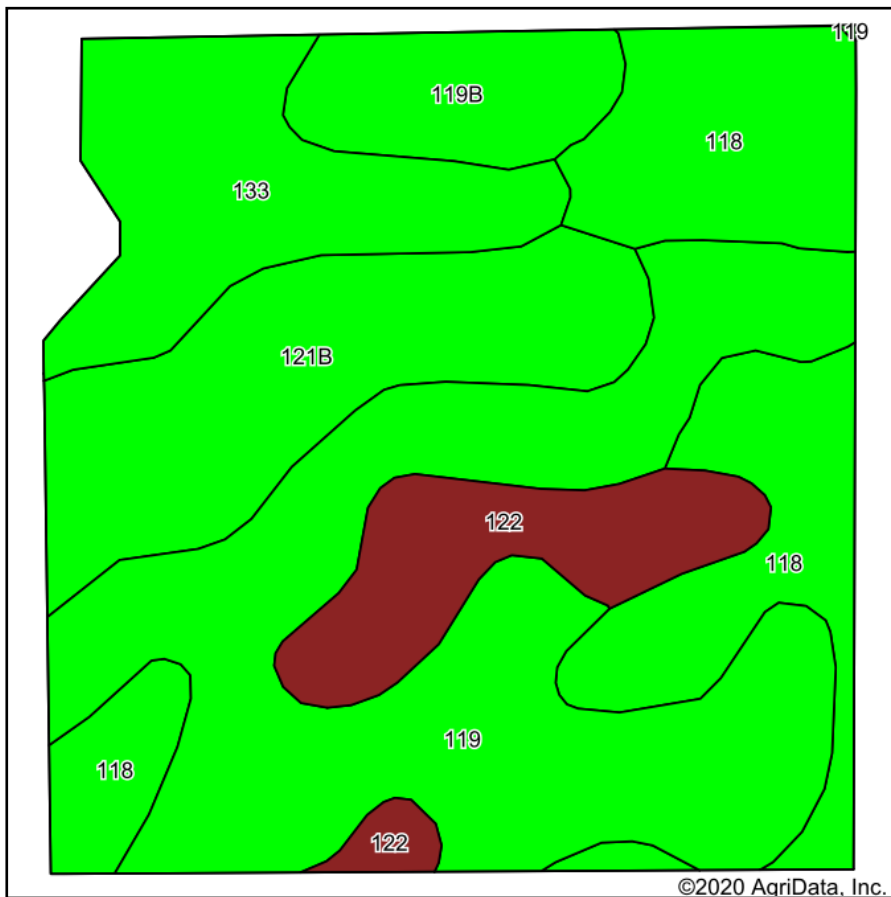

Soils data provided by USDA and NRCS.

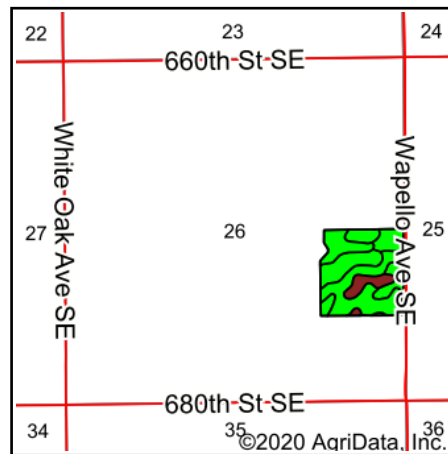

State: **Iowa**  
 County: **Johnson**  
 Location: **26-77N-5W**  
 Township: **Fremont**  
 Acres: **38.14**  
 Date: **12/1/2020**



Maps Provided By:



| Code                    | Soil Description  | Acres | Percent of field | CSR2 Legend | Non-Irr Class *c | CSR2**      | CSR       |
|-------------------------|---|-------|------------------|-------------|------------------|-------------|-----------|
| 119                     | Muscatine silt loam, 0 to 2 percent slopes                        | 13.36 | 35.0%            |             | Iw               | 100         | 100       |
| 118                     | Garwin silty clay loam, 0 to 2 percent slopes                     | 8.08  | 21.2%            |             | IIw              | 90          | 95        |
| 121B                    | Tama silt loam, 2 to 5 percent slopes                             | 6.10  | 16.0%            |             | Ile              | 95          |           |
| 133                     | Colo silty clay loam, 0 to 2 percent slopes, occasionally flooded | 4.86  | 12.7%            |             | IIw              | 78          | 85        |
| 122                     | Sperry silt loam, depressional, 0 to 1 percent slopes             | 3.49  | 9.2%             |             | IIIw             | 36          | 63        |
| 119B                    | Muscatine silty clay loam, 2 to 5 percent slopes                  | 2.25  | 5.9%             |             | Ile              | 95          | 95        |
| <b>Weighted Average</b> |   |       |                  |             |                  | <b>88.1</b> | <b>*-</b> |

\*\*IA has updated the CSR values for each county to CSR2.

\*- CSR weighted average cannot be calculated on the current soils data, use prior data version for csr values.

\*c: Using Capabilities Class Dominant Condition Aggregation Method

Soils data provided by USDA and NRCS.