

# Soils Map

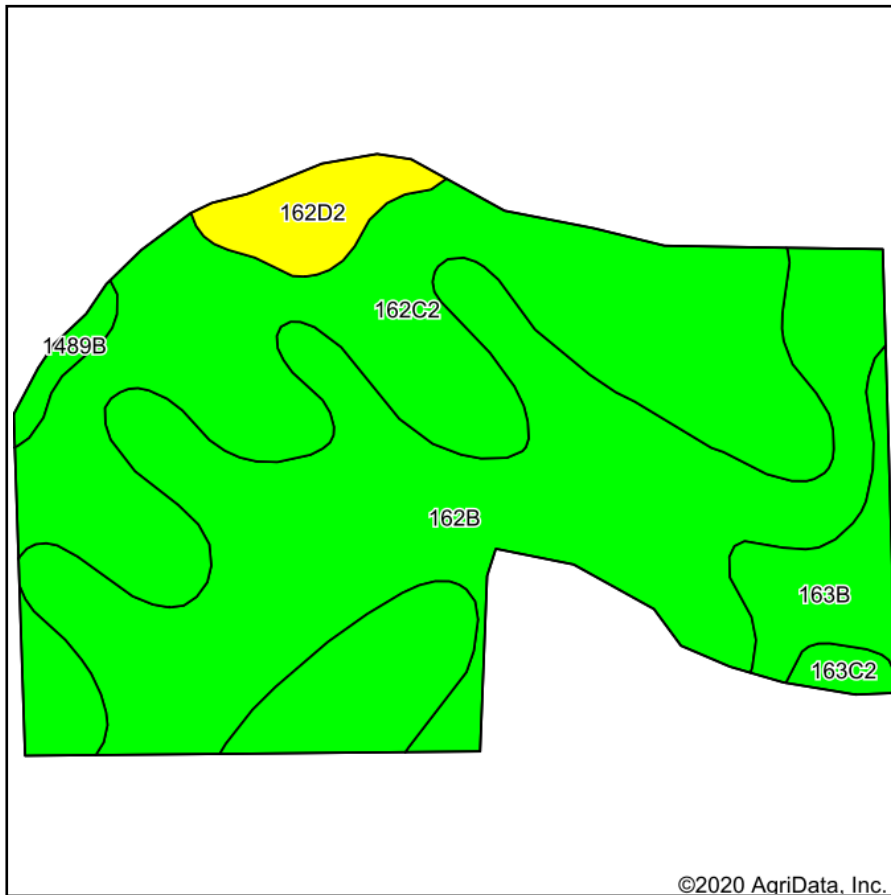

Soils data provided by USDA and NRCS.

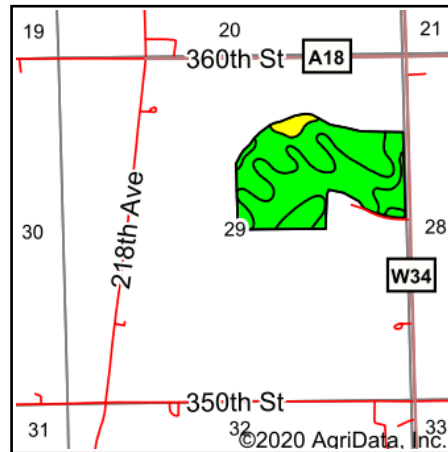

State: **Iowa**  
 County: **Winneshiek**  
 Location: **29-100N-8W**  
 Township: **Hesper**  
 Acres: **80.85**  
 Date: **11/18/2020**



Maps Provided By:



Area Symbol: JA191. Soil Area Version: 29							
Code	Soil Description	Acres	Percent of field	CSR2 Legend	Non-Irr Class *c	CSR2**	CSR
162C2	Downs silt loam, 5 to 9 percent slopes, moderately eroded	36.20	44.8%		IIIe	80	
162B	Downs silt loam, 2 to 6 percent slopes	35.44	43.8%		Ile	90	88
163B	Fayette silt loam, 2 to 6 percent slopes	4.23	5.2%		Ile	83	83
162D2	Downs silt loam, 9 to 14 percent slopes, moderately eroded	3.21	4.0%		IIIe	54	
1489B	Lawson-Ossian complex, 0 to 4 percent slopes	0.93	1.2%		IIw	77	82
163C2	Fayette silt loam, 5 to 9 percent slopes, moderately eroded	0.84	1.0%		IIIe	72	66
<b>Weighted Average</b>						<b>83.4</b>	<b>*-</b>

\*\*IA has updated the CSR values for each county to CSR2.

\*- CSR weighted average cannot be calculated on the current soils data, use prior data version for csr values.

\*c: Using Capabilities Class Dominant Condition Aggregation Method

Soils data provided by USDA and NRCS.