

# Soils Map

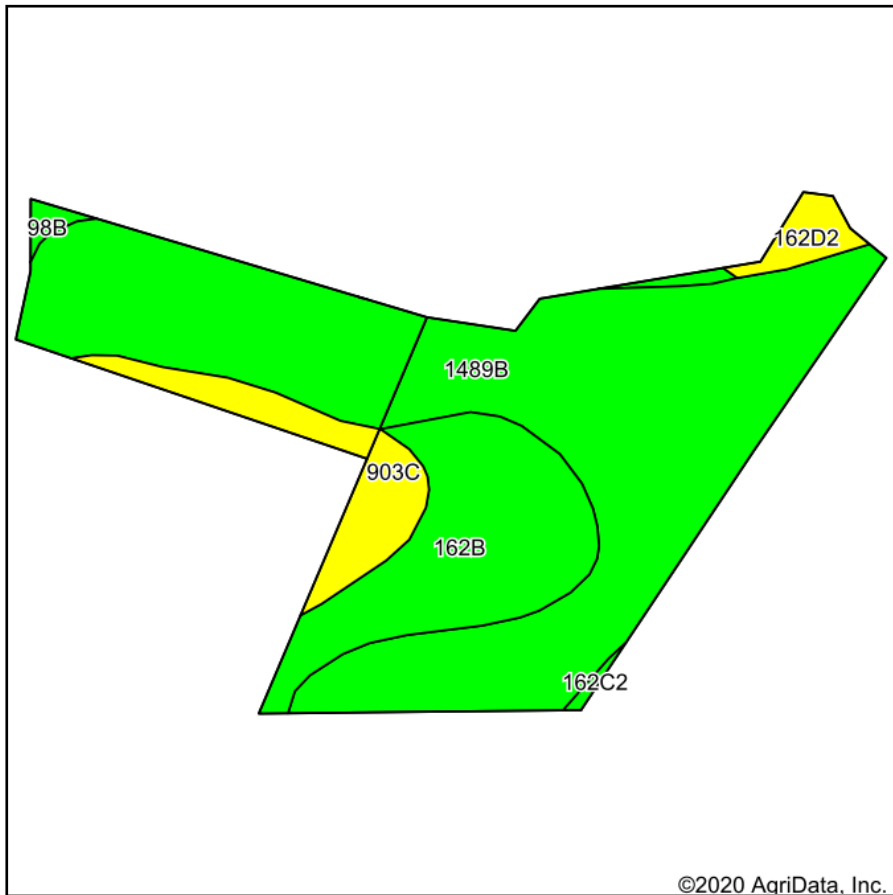

Soils data provided by USDA and NRCS.

©2020 AgriData, Inc.

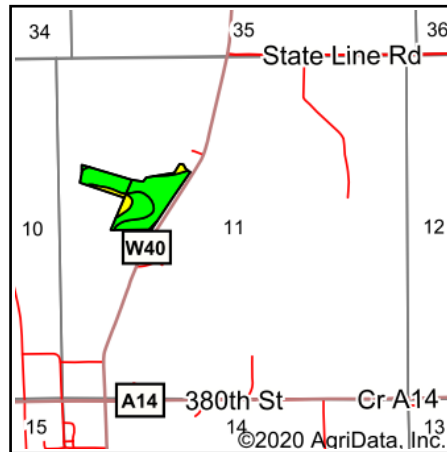

State: **Iowa**  
 County: **Winneshiek**  
 Location: **11-100N-8W**  
 Township: **Hesper**  
 Acres: **19.08**  
 Date: **11/18/2020**



Maps Provided By:



© AgriData, Inc. 2020

www.AgriDataInc.com



Area Symbol: IA191, Soil Area Version: 29							
Code	Soil Description	Acres	Percent of field	CSR2 Legend	Non-Irr Class *c	CSR2**	CSR
1489B	Lawson-Ossian complex, 0 to 4 percent slopes	13.12	68.8%		IIw	77	82
162B	Downs silt loam, 2 to 6 percent slopes	3.69	19.3%		Ile	90	88
903C	Frankville silt loam, 5 to 9 percent slopes	1.55	8.1%		IIIe	42	39
162D2	Downs silt loam, 9 to 14 percent slopes, moderately eroded	0.44	2.3%		IIIe	54	
98B	Huntsville silt loam, 2 to 5 percent slopes, occasionally flooded	0.22	1.2%		Ile	88	90
162C2	Downs silt loam, 5 to 9 percent slopes, moderately eroded	0.06	0.3%		IIIe	80	
<b>Weighted Average</b>						<b>76.3</b>	<b>*-</b>

\*\*IA has updated the CSR values for each county to CSR2.

\*- CSR weighted average cannot be calculated on the current soils data, use prior data version for csr values.

\*c: Using Capabilities Class Dominant Condition Aggregation Method

Soils data provided by USDA and NRCS.