

# Soils Map

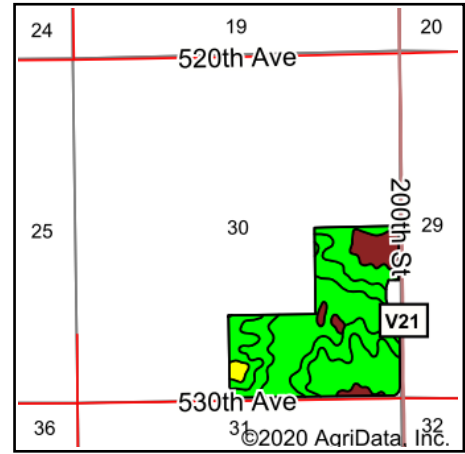

State: **Iowa**  
 County: **Poweshiek**  
 Location: **30-78N-13W**  
 Township: **Deep River**  
 Acres: **113.31**  
 Date: **9/9/2020**

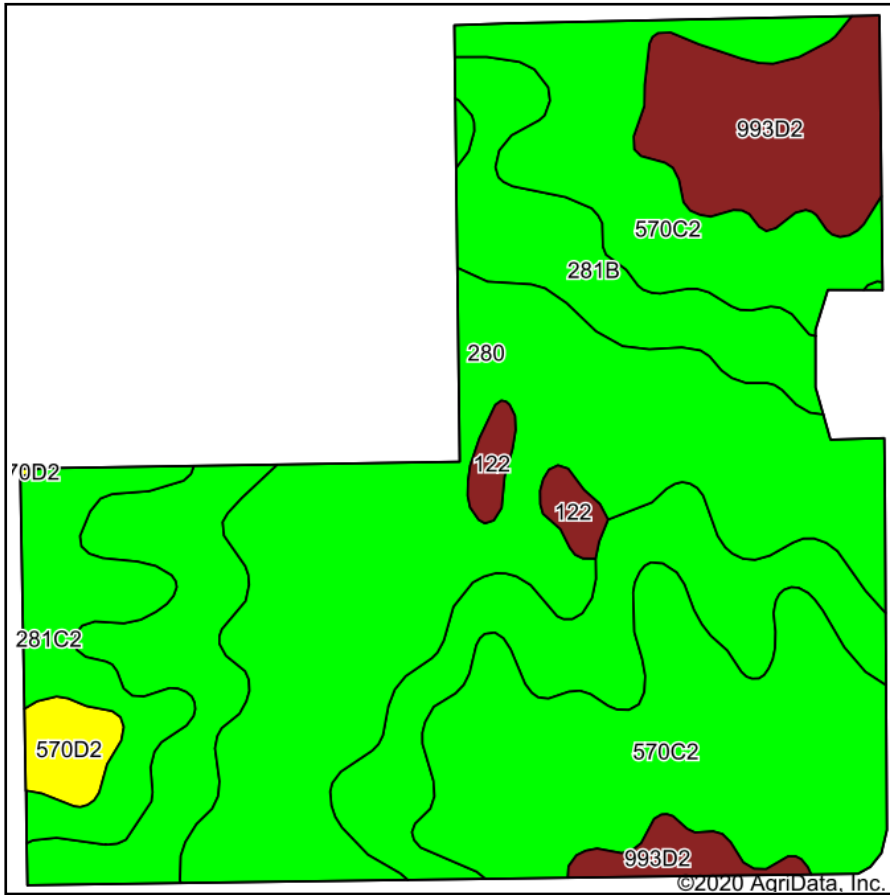

Maps Provided By:



Area Symbol: IA157, Soil Area Version: 24								
Code	Soil Description	Acres	Percent of field	CSR2 Legend	Non-Irr Class *c	CSR2**	CSR	
280	Mahaska silty clay loam, 0 to 2 percent slopes	32.91	29.0%		Iw	94	96	
570C2	Nira silty clay loam, 5 to 9 percent slopes, moderately eroded	31.36	27.7%		IIIe	72	68	
281B	Otley silty clay loam, 2 to 5 percent slopes	28.54	25.2%		IIe	91	91	
993D2	Gara-Armstrong loams, 9 to 14 percent slopes, moderately eroded	9.92	8.8%		IVe	31	20	
281C2	Otley silty clay loam, 5 to 9 percent slopes, eroded	7.21	6.4%		IIIe	82	71	
570D2	Nira silty clay loam, 9 to 14 percent slopes moderately eroded	1.79	1.6%		IIIe	52	58	
122	Sperry silt loam, depressional, 0 to 1 percent slopes	1.58	1.4%		IIIw	36	63	
<b>Weighted Average</b>						<b>79.4</b>	<b>77.7</b>	

\*\*IA has updated the CSR values for each county to CSR2.

\*c: Using Capabilities Class Dominant Condition Aggregation Method  
 Soils data provided by USDA and NRCS.