

Soils Map

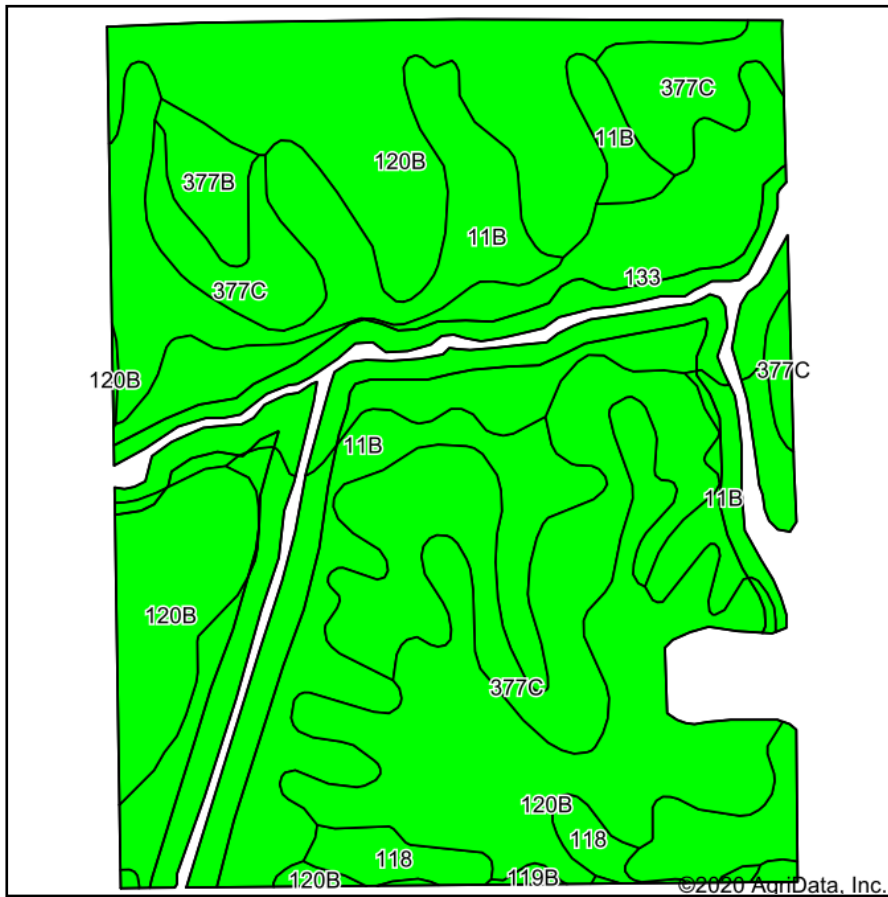

Soils data provided by USDA and NRCS.

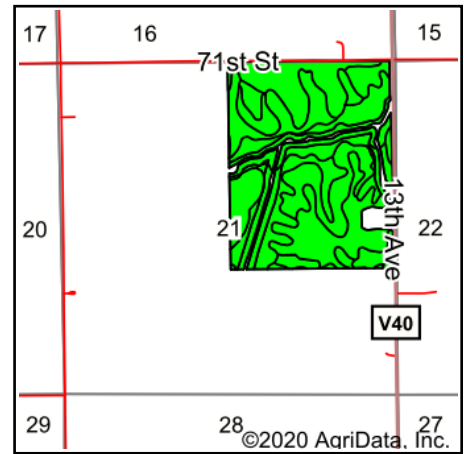

State: **Iowa**
 County: **Benton**
 Location: **21-83N-12W**
 Township: **Kane**
 Acres: **184.27**
 Date: **9/29/2020**



Maps Provided By:



© AgriData, Inc. 2020

www.AgriDataInc.com



| Area Symbol: JA011. Soil Area Version: 23 | | | | | | | |
|---|---|-------|------------------|-------------|------------------|--------|------|
| Cod e | Soil Description | Acres | Percent of field | CSR2 Legend | Non-Irr Class *c | CSR2** | CSR |
| 120B | Tama silty clay loam, 2 to 5 percent slopes | 62.58 | 34.0% | | Ile | 95 | 95 |
| 11B | Colo-Ely complex, 0 to 5 percent slopes | 53.31 | 28.9% | | Ilw | 86 | 68 |
| 377 C | Dinsdale silty clay loam, 5 to 9 percent slopes | 31.63 | 17.2% | | IIIle | 90 | 75 |
| 133 | Colo silty clay loam, 0 to 2 percent slopes, occasionally flooded | 28.80 | 15.6% | | Ilw | 78 | 80 |
| 118 | Garwin silty clay loam, 0 to 2 percent slopes | 4.09 | 2.2% | | Ilw | 90 | 95 |
| 377B | Dinsdale silty clay loam, 2 to 5 percent slopes | 3.44 | 1.9% | | Ile | 94 | 90 |
| 119B | Muscatine silty clay loam, 2 to 5 percent slopes | 0.42 | 0.2% | | Ile | 95 | 95 |
| Weighted Average | | | | | | 88.8 | 81.3 |

**IA has updated the CSR values for each county to CSR2.

*c: Using Capabilities Class Dominant Condition Aggregation Method

Soils data provided by USDA and NRCS.