

Soils Map

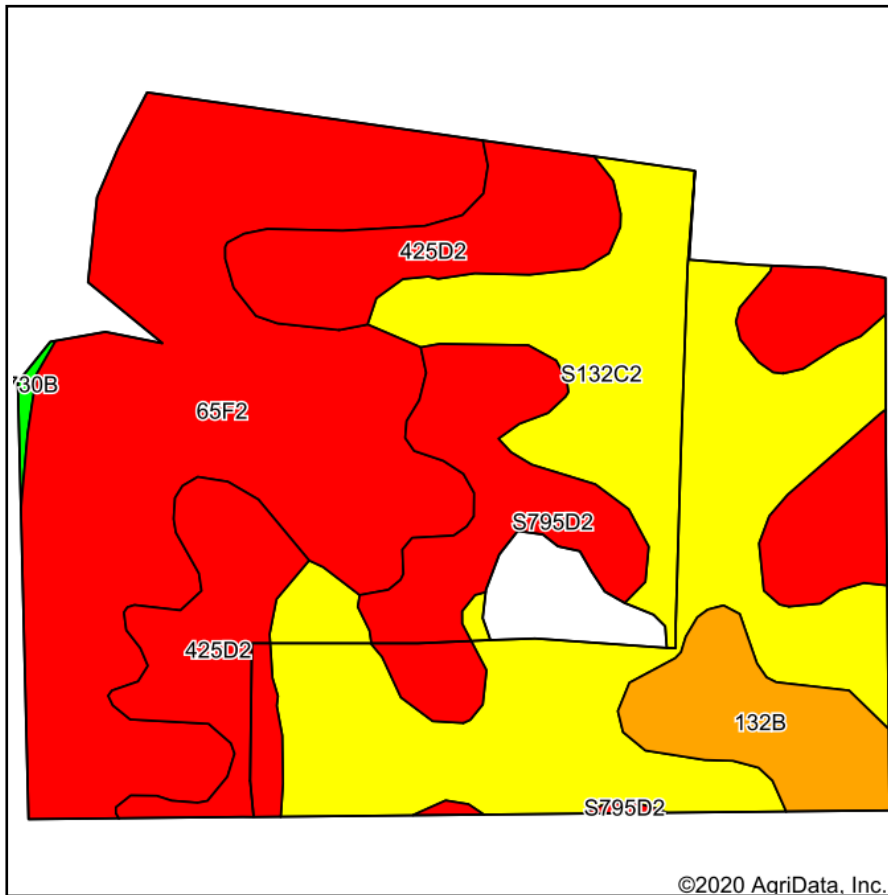

Soils data provided by USDA and NRCS.

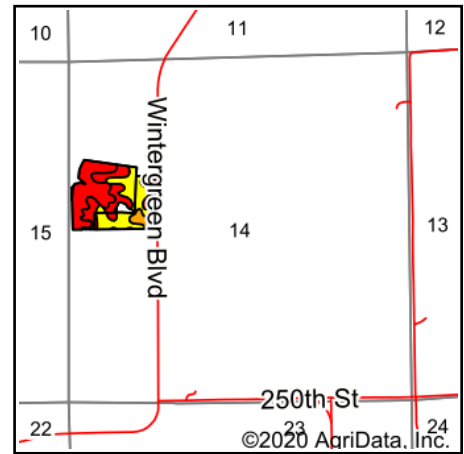

State: **Iowa**
 County: **Jefferson**
 Location: **14-71N-8W**
 Township: **Round Prairie**
 Acres: **26.99**
 Date: **10/7/2020**



Maps Provided By:



Area Symbol: IA101, Soil Area Version: 28							
Code	Soil Description	Acres	Percent of field	CSR2 Legend	Non-Irr Class *c	CSR2**	CSR
65F2	Lindley loam, 18 to 25 percent slopes, moderately eroded	9.05	33.5%		Vlle	10	8
S132C2	Weller silty clay loam, 5 to 9 percent slopes, moderately eroded	9.00	33.3%		IIle	59	
425D2	Keswick clay loam, 9 to 14 percent slopes, moderately eroded	5.00	18.5%		IVe	8	12
S795D2	Ashgrove silty clay loam, 9 to 14 percent slopes, moderately eroded	2.35	8.7%		IVe	7	
132B	Weller silt loam, 2 to 5 percent slopes	1.52	5.6%		IIle	67	60
730B	Nodaway-Coppock-Cantril complex, 2 to 5 percent slopes	0.07	0.3%		IIw	74	61
Weighted Average						29.1	*-

**IA has updated the CSR values for each county to CSR2.

*- CSR weighted average cannot be calculated on the current soils data, use prior data version for csr values.

*c: Using Capabilities Class Dominant Condition Aggregation Method

Soils data provided by USDA and NRCS.