

# Soils Map

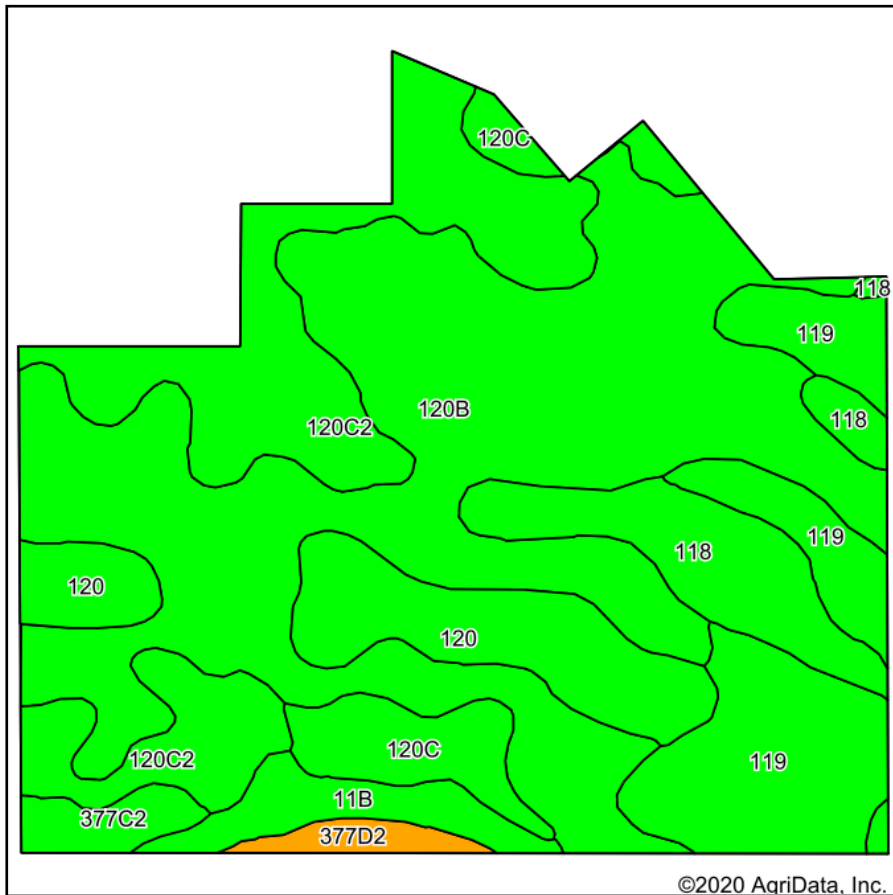

Soils data provided by USDA and NRCS.

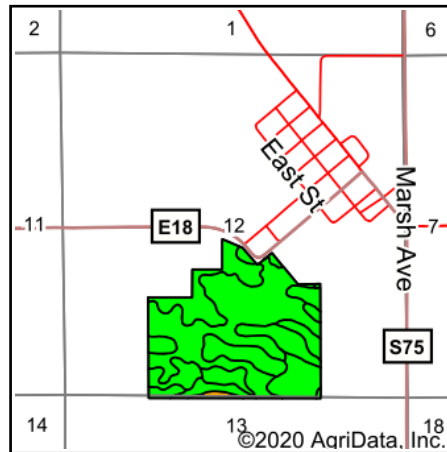

State: **Iowa**  
 County: **Marshall**  
 Location: **12-85N-19W**  
 Township: **Liscomb**  
 Acres: **116.29**  
 Date: **9/24/2020**



Maps Provided By:  
  
 CUSTOMIZED ONLINE MAPPING  
 © AgriData, Inc. 2020 www.AgriDataInc.com



| Area Symbol: IA127. Soil Area Version: 25 |  |       |                  |             |                  |             |           |  |
|---|--|-------|------------------|-------------|------------------|-------------|-----------|--|
| Code                                      | Soil Description   | Acres | Percent of field | CSR2 Legend | Non-Irr Class *c | CSR2**      | CSR       |  |
| 120B                                      | Tama silty clay loam, 2 to 5 percent slopes              | 51.02 | 43.9%            |             | Ile              | 95          | 95        |  |
| 120C2                                     | Tama silty clay loam, 5 to 9 percent slopes, eroded      | 19.51 | 16.8%            |             | IIIe             | 87          | 78        |  |
| 119                                       | Muscataine silty clay loam, 0 to 2 percent slopes        | 15.27 | 13.1%            |             | Iw               | 100         | 100       |  |
| 120                                       | Tama silty clay loam, 0 to 2 percent slopes              | 10.46 | 9.0%             |             | I                | 100         | 100       |  |
| 118                                       | Garwin silty clay loam, 0 to 2 percent slopes            | 8.22  | 7.1%             |             | IIw              | 90          | 95        |  |
| 120C                                      | Tama silty clay loam, 5 to 9 percent slopes              | 4.93  | 4.2%             |             | IIIe             | 90          | 80        |  |
| 11B                                       | Colo-Ely complex, 0 to 5 percent slopes                  | 3.60  | 3.1%             |             | IIw              | 86          | 68        |  |
| 377C2                                     | Dinsdale silty clay loam, 5 to 9 percent slopes, eroded  | 1.93  | 1.7%             |             | IIIe             | 85          | 73        |  |
| 377D2                                     | Dinsdale silty clay loam, 9 to 14 percent slopes, eroded | 1.35  | 1.2%             |             | IIIe             | 62          | 63        |  |
| <b>Weighted Average</b>                   |  |       |                  |             |                  | <b>93.4</b> | <b>91</b> |  |

\*\*IA has updated the CSR values for each county to CSR2.  
 \*c: Using Capabilities Class Dominant Condition Aggregation Method  
 Soils data provided by USDA and NRCS.