

Soils Map

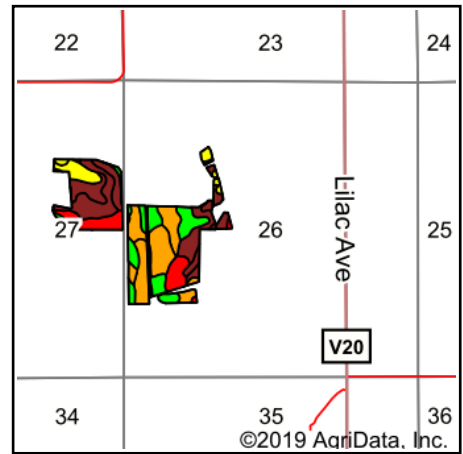

State: **Iowa**
 County: **Davis**
 Location: **26-68N-14W**
 Township: **Wyacondah**
 Acres: **82.77**
 Date: **9/5/2019**

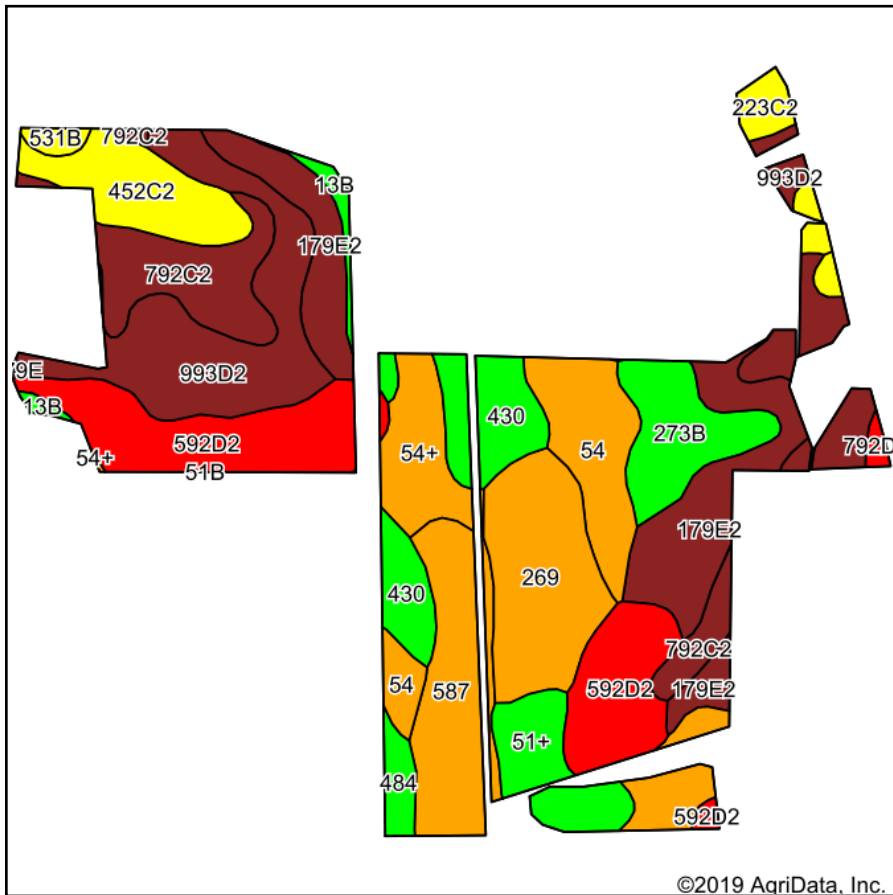

Maps Provided By:
surety
 CUSTOMIZED ONLINE MAPPING
 © AgriData, Inc. 2019 www.AgriDataInc.com



Soils data provided by USDA and NRCS.

©2019 AgriData, Inc.

Area Symbol: IA051. Soil Area Version: 25										
Code	Soil Description	Acres	Percent of field	CSR2 Legend	Non-Irr Class *c	CSR2**	CSR	Cor n	Soybeans	*n NCCPI Soybeans
592D2	Mystic silt loam, 9 to 14 percent slopes, moderately eroded	10.77	13.0%		IVe	10	5			46
179E2	Gara loam, 14 to 18 percent slopes, moderately eroded	9.46	11.4%		VIe	24	33			41
993D2	Gara-Armstrong loams, 9 to 14 percent slopes, moderately eroded	9.31	11.2%		IVe	35	20			45
792C2	Armstrong loam, 5 to 9 percent slopes, moderately eroded	8.80	10.6%		IIIe	31	27			45
587	Chequest silty clay loam, 0 to 2 percent slopes, occasionally flooded	7.85	9.5%		IIw	62	65			71
269	Humeston silt loam, 0 to 2 percent slopes, occasionally flooded	7.08	8.6%		IIIw	70	58			77
54	Zook silty clay loam, heavy till, 0 to 2 percent slopes, occasionally flooded	5.46	6.6%		IIw	68	70			64
430	Ackmore silt loam, heavy till, 0 to 2 percent slopes, occasionally flooded	4.77	5.8%		IIw	77	83			79
452C2	Lineville silt loam, 5 to 9 percent slopes, moderately eroded	4.21	5.1%		IIIe	46	31			50
273B	Olmitz loam, heavy till, 2 to 5 percent slopes	4.09	4.9%		IIe	81	72	152	41	74
54+	Zook silt loam, heavy till, 0 to 2 percent slopes, occasionally flooded, overwash	3.37	4.1%		IIw	68	75			69
51+	Vesser silt loam overwash, 0 to 2 percent slopes	3.28	4.0%		IIw	75	70			83
223C2	Rinda silty clay loam, 5 to 9 percent slopes, moderately eroded	1.36	1.6%		IVw	45	22			44
13B	Olmitz-Vesser-Zook complex, 0 to 5 percent slopes	1.00	1.2%		IIw	74	60	59	16	74
484	Lawson silt loam, heavy till, 0 to 2 percent slopes, occasionally flooded	0.97	1.2%		IIw	86	90			88
531B	Kniffin silt loam, 2 to 5 percent slopes	0.72	0.9%		IIIe	55	54			68
792D2	Armstrong loam, 9 to 14 percent slopes, moderately eroded	0.27	0.3%		IVe	9	13			42
Weighted Average						47.3	43.7	8.2	2.2	*n 58.3

**IA has updated the CSR values for each county to CSR2.
 *n: The aggregation method is "Weighted Average using major components"
 *c: Using Capabilities Class Dominant Condition Aggregation Method
 Soils data provided by USDA and NRCS.