

# Soils Map

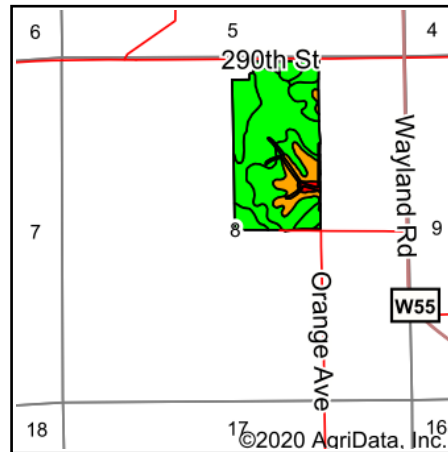

State: **Iowa**  
 County: **Washington**  
 Location: **8-74N-7W**  
 Township: **Marion**  
 Acres: **78.45**  
 Date: **9/8/2020**

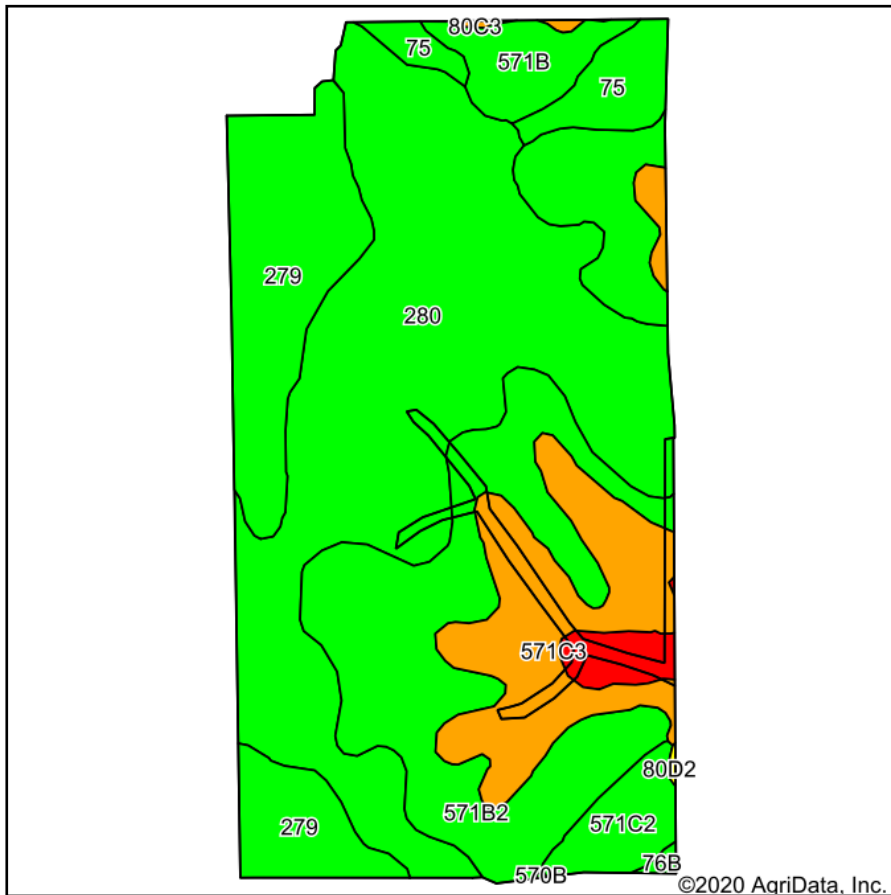

Maps Provided By:  
  
 CUSTOMIZED ONLINE MAPPING  
 © AgriData, Inc. 2020 www.AgriDataInc.com



Area Symbol: IA183. Soil Area Version: 27							
Code	Soil Description	Acres	Percent of field	CSR2 Legend	Non-Irr Class *c	CSR2**	CSR
280	Mahaska silty clay loam, 0 to 2 percent slopes	30.20	38.5%		Iw	94	95
571B2	Hedrick silt loam, 2 to 5 percent slopes, moderately eroded	18.96	24.2%		Ile	82	77
279	Taintor silty clay loam, 0 to 2 percent slopes	11.02	14.0%		IIw	83	88
571C3	Hedrick silty clay loam, 5 to 9 percent slopes, severely eroded	9.30	11.9%		IVe	68	57
75	Givin silt loam, 0 to 2 percent slopes	2.78	3.5%		Iw	84	85
571B	Hedrick silt loam, 2 to 5 percent slopes	2.53	3.2%		Ile	85	82
571C2	Hedrick silt loam, 5 to 9 percent slopes, moderately eroded	2.13	2.7%		IIIe	75	62
795D2	Ashgrove silt loam, 9 to 14 percent slopes, moderately eroded	1.25	1.6%		IVe	5	8
76B	Ladoga silt loam, 2 to 5 percent slopes	0.14	0.2%		Ile	86	85
80C3	Clinton silty clay loam, 5 to 9 percent slopes, severely eroded	0.14	0.2%		IVe	62	55
<b>Weighted Average</b>						<b>83.8</b>	<b>82</b>

\*\*IA has updated the CSR values for each county to CSR2.  
 \*c: Using Capabilities Class Dominant Condition Aggregation Method  
 Soils data provided by USDA and NRCS.