

Soils Map

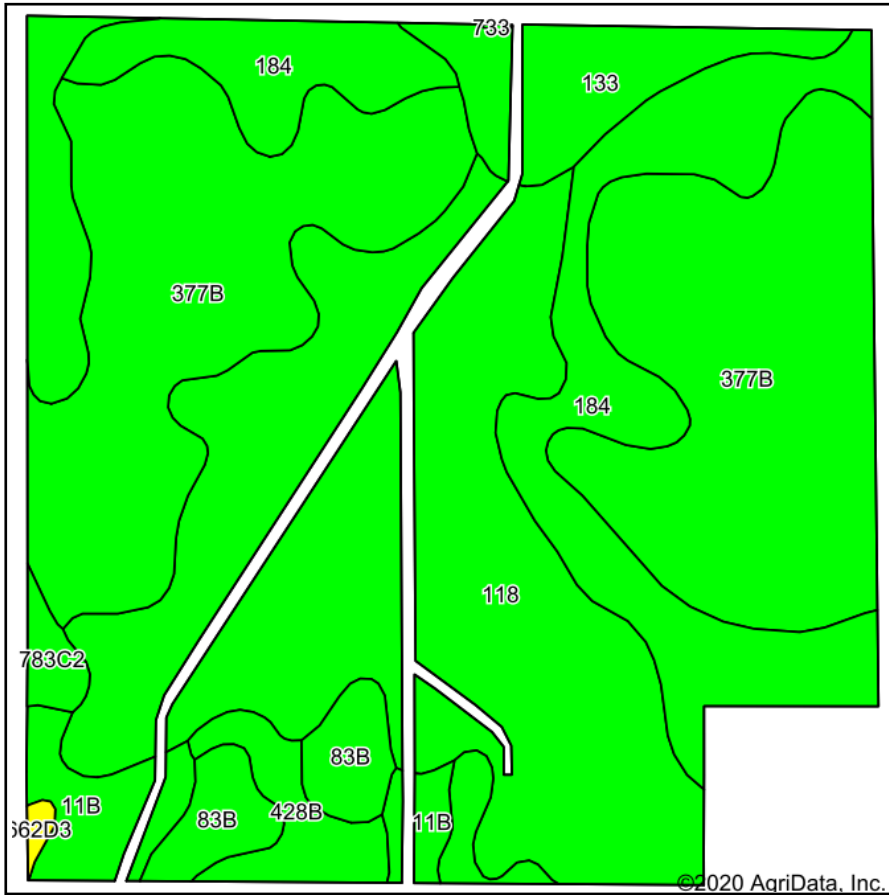

Soils data provided by USDA and NRCS.

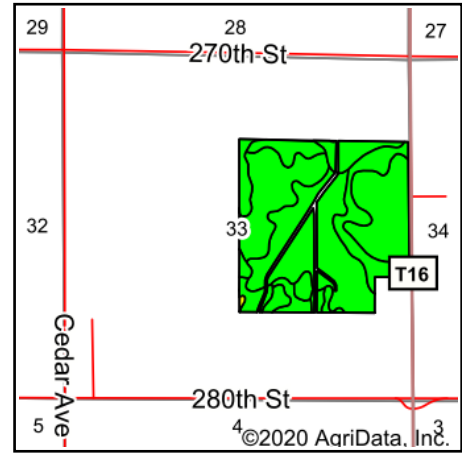

State: **Iowa**
 County: **Butler**
 Location: **33-91N-18W**
 Township: **Madison**
 Acres: **143.31**
 Date: **8/11/2020**



Maps Provided By:



© AgriData, Inc. 2020

www.AgriDataInc.com



Area Symbol: IA023. Soil Area Version: 26														
Code	Soil Description	Acres	Percent of field	CSR2 Legend	Non-Irr Class *c	CSR2**	CSR	Bromegrass alfalfa	Bromegrass alfalfa hay	Cor n	Kentucky bluegrass	Oats	Smooth bromegrass	Soybeans
377B	Dinsdale silty clay loam, 2 to 5 percent slopes	51.09	35.6%		lle	94	90							
118	Garwin silty clay loam, 0 to 2 percent slopes	45.45	31.7%		llw	90	95							
184	Klinger silty clay loam, 1 to 4 percent slopes	21.35	14.9%		lw	95	95							
133	Colo silty clay loam, 0 to 2 percent slopes, occasionally flooded	10.72	7.5%		llw	78	80							
11B	Colo-Ely complex, 0 to 5 percent slopes	4.64	3.2%		llw	86	68							
428B	Ely silty clay loam, 2 to 5 percent slopes	4.36	3.0%		lle	88	88							
83B	Kenyon loam, 2 to 5 percent slopes	4.30	3.0%		lle	90	85	11	6.6	210	3.9	91	6.6	61
783C2	Cresco loam, 5 to 9 percent slopes, moderately eroded	1.12	0.8%		llle	78	40							



662D3	Mt. Carroll silt loam, 9 to 14 percent slopes, severely eroded	0.28	0.2%		Ive	47	60								
Weighted Average						90.9	90.2	0.3	0.2	6.3	0.1	2.7	0.2	1.8	

**IA has updated the CSR values for each county to CSR2.
 *c: Using Capabilities Class Dominant Condition Aggregation Method
 Soils data provided by USDA and NRCS.