

# Soils Map

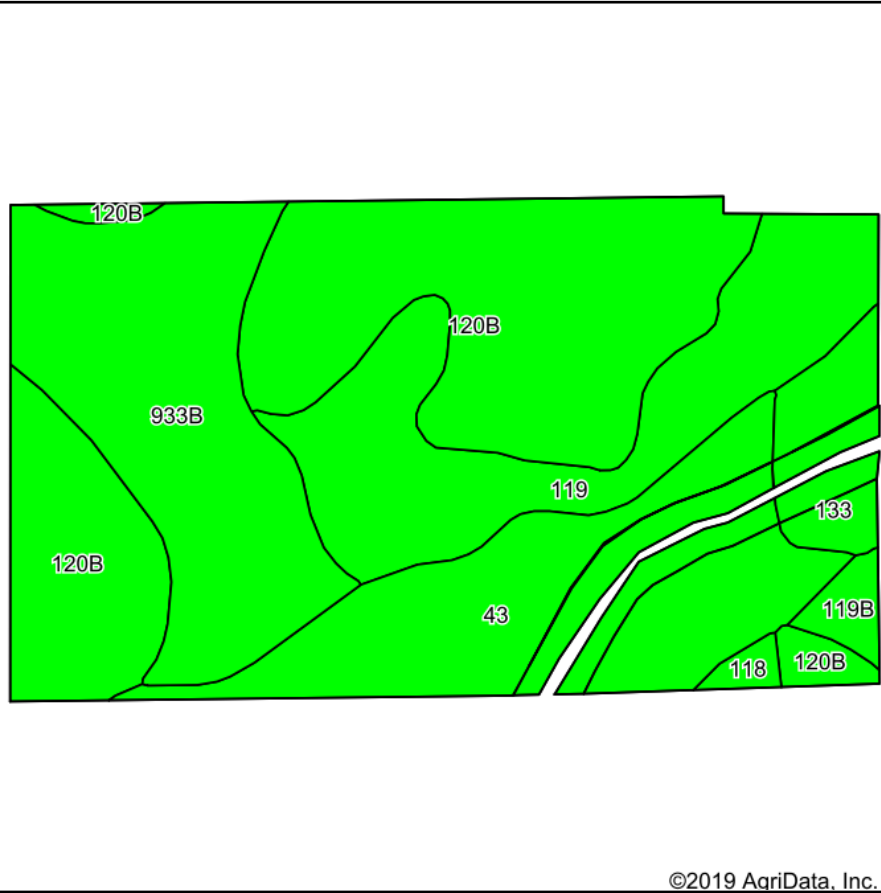

©2019 AgriData, Inc.

Soils data provided by USDA and NRCS.

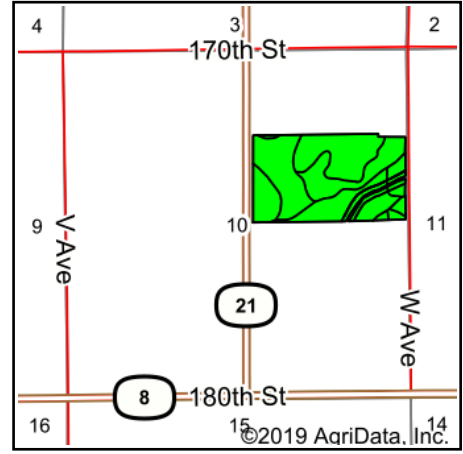

State: **Iowa**  
 County: **Tama**  
 Location: **10-85N-13W**  
 Township: **Clark**  
 Acres: **68.98**  
 Date: **1/24/2020**



Maps Provided By:



© AgriData, Inc. 2019

www.AgriDataInc.com



Area Symbol: IA171. Soil Area Version: 24

Code	Soil Description	Acres	Percent of field	CSR2 Legend	Non-Irr Class *c	CSR2**	CSR
120B	Tama silty clay loam, 2 to 5 percent slopes	23.34	33.8%		Ile	95	95
933B	Sawmill silty clay loam, shallow loess, 1 to 4 percent slopes, occasionally flooded	14.81	21.5%		Ilw	76	80
43	Bremer silty clay loam, 0 to 2 percent slopes	14.05	20.4%		Ilw	74	82
119	Muscatine silty clay loam, 0 to 2 percent slopes	12.29	17.8%		Iw	100	100
133	Colo silty clay loam, 0 to 2 percent slopes, occasionally flooded	3.10	4.5%		Ilw	78	85
119B	Muscatine silty clay loam, 2 to 5 percent slopes	0.93	1.3%		Ile	95	95
118	Garwin silty clay loam, 0 to 2 percent slopes	0.46	0.7%		Ilw	90	95
<b>Weighted Average</b>						<b>86.7</b>	<b>89.6</b>

\*\*IA has updated the CSR values for each county to CSR2.

\*c: Using Capabilities Class Dominant Condition Aggregation Method

Soils data provided by USDA and NRCS.