

# Soils Map

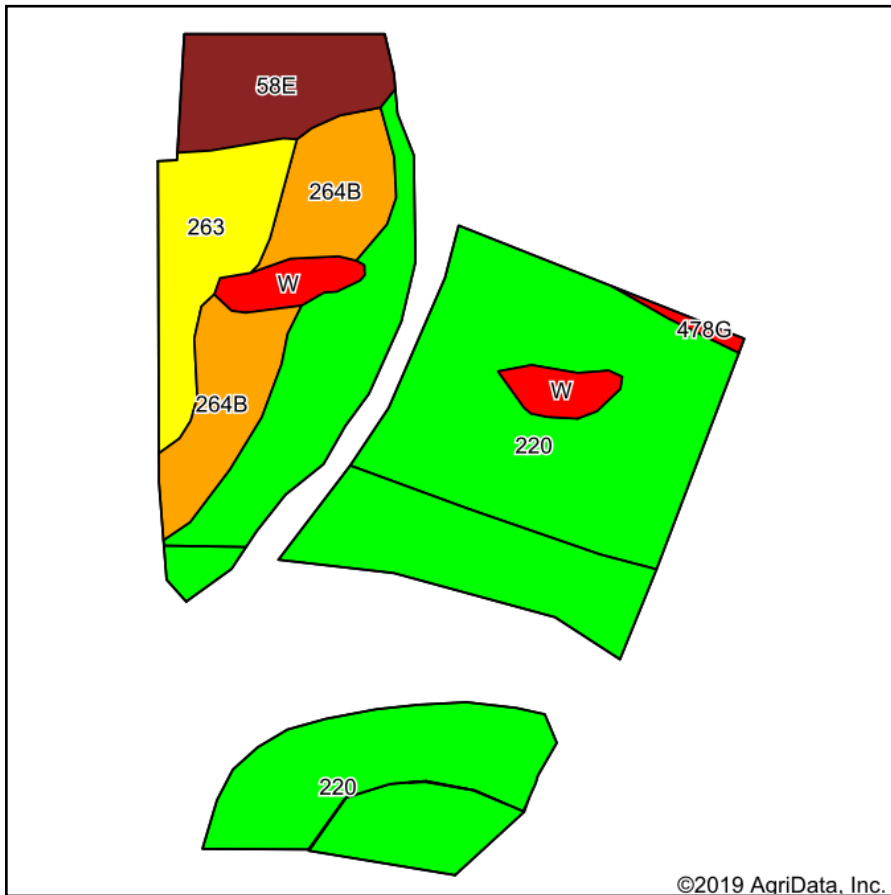

Soils data provided by USDA and NRCS.

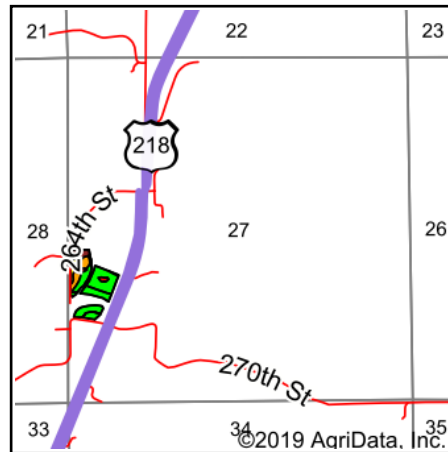





State: **Iowa**  
 County: **Henry**  
 Location: **27-71N-6W**  
 Township: **Center**  
 Acres: **10.02**  
 Date: **1/3/2020**

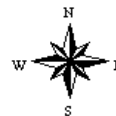

Maps Provided By:  
  
 CUSTOMIZED ONLINE MAPPING  
 © AgriData, Inc. 2019 www.AgriDataInc.com



Area Symbol: IA087, Soil Area Version: 24							
Code	Soil Description	Acres	Percent of field	CSR2 Legend	Non-Irr Class *c	CSR2**	CSR
220	Nodaway silt loam, shallow loess, 0 to 2 percent slopes, occasionally flooded	6.84	68.3%		IIw	77	87
264B	Ainsworth silt loam, 2 to 5 percent slopes	1.17	11.7%		Ile	68	70
263	Okaw silt loam, heavy till, 0 to 2 percent slopes, rarely flooded	0.83	8.3%		IIIw	52	53
58E	Douds loam, heavy loess, 14 to 18 percent slopes	0.80	8.0%		VIe	38	20
W	Water	0.38	3.8%			0	0
<b>Weighted Average</b>						<b>67.8</b>	<b>73.5</b>

\*\*IA has updated the CSR values for each county to CSR2.  
 \*c: Using Capabilities Class Dominant Condition Aggregation Method  
 Soils data provided by USDA and NRCS.