

Soils Map

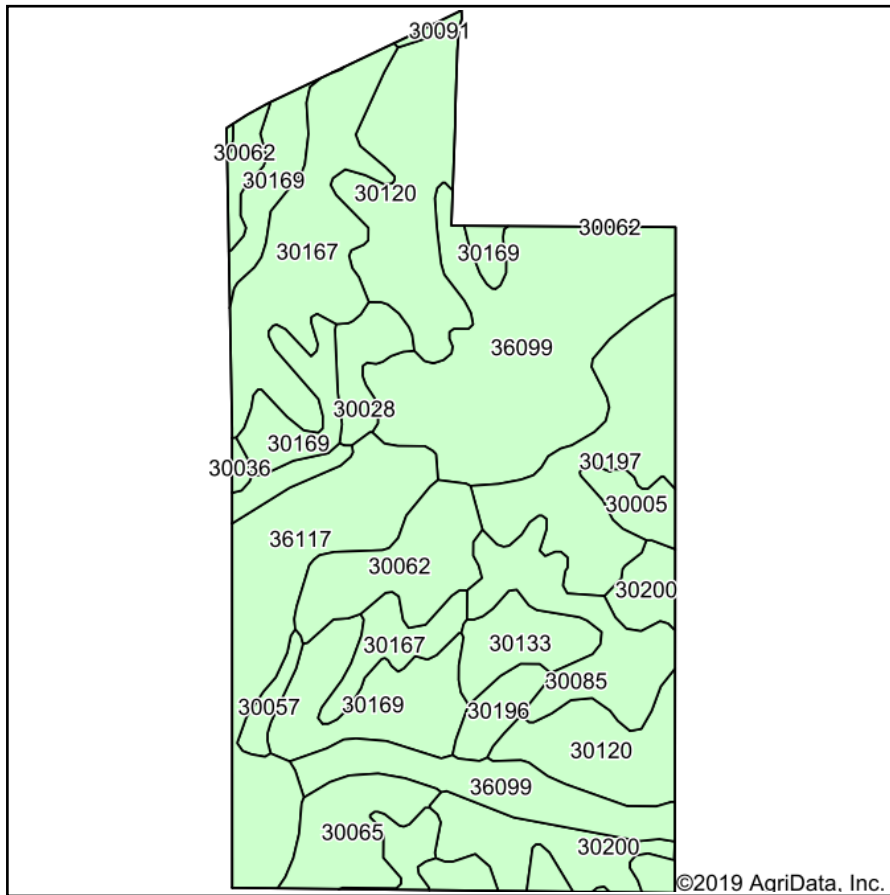

Soils data provided by USDA and NRCS.

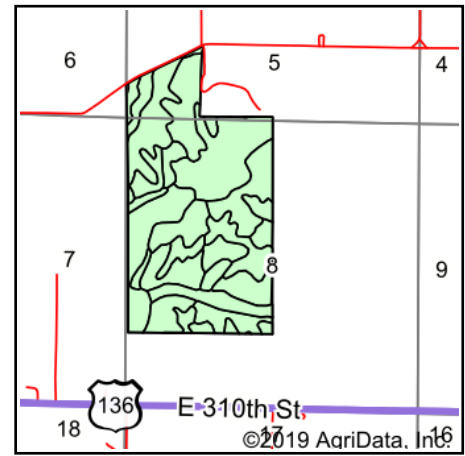

State: **Missouri**
 County: **Harrison**
 Location: **8-63N-27W**
 Township: **Sherman**
 Acres: **267.19**
 Date: **3/12/2019**



Maps Provided By:
surety
 CUSTOMIZED ONLINE MAPPING
 © AgriData, Inc. 2019 www.AgriDataInc.com



Area Symbol: MO081, Soil Area Version: 21

Code	Soil Description	Acres	Percent of field	Non-Irr Class *c	Alfalfa hay	*n NCCPI Soybeans
36099	Zook-Colo silty clay loams, 1 to 3 percent slopes, frequently flooded	51.81	19.4%	IIIw		58
30120	Lagonda silty clay loam, 5 to 9 percent slopes, eroded	34.05	12.7%	IIIe	5	54
30167	Pershing silt loam, 2 to 5 percent slopes	27.99	10.5%	IIIe		62
30169	Pershing silt loam, 5 to 9 percent slopes	27.24	10.2%	IIIe		61
36117	Nodaway silt loam, heavy till, 0 to 2 percent slopes, occasionally flooded	26.40	9.9%	IIw		81
30197	Shelby loam, 14 to 18 percent slopes	20.12	7.5%	IVe		58
30085	Grundy silt loam, 2 to 5 percent slopes	17.34	6.5%	Ile		64
30062	Gara loam, 9 to 14 percent slopes	14.83	5.6%	IVe		60
30200	Shelby loam, 9 to 14 percent slopes	13.30	5.0%	IIIe		63
30065	Gasconade flaggy silty clay loam, 14 to 35 percent slopes	9.29	3.5%	VIIIs	1	2
30133	Lamoni clay loam, 5 to 9 percent slopes, moderately eroded	6.88	2.6%	IIIe		50
30028	Armstrong clay loam, 5 to 9 percent slopes, severely eroded	4.89	1.8%	IVe		30
30196	Shelby clay loam, 9 to 14 percent slopes, severely eroded	3.74	1.4%	IVe		37
30005	Adair loam, 3 to 9 percent slopes	3.64	1.4%	IIIe	5	61
30038	Armstrong loam, 9 to 14 percent slopes	2.39	0.9%	IVe		52
30057	Gara loam, 14 to 18 percent slopes	2.07	0.8%	VIe		52
30091	Grundy silty clay loam, 2 to 5 percent slopes, moderately eroded	0.61	0.2%	Ile		67
30036	Armstrong loam, 5 to 9 percent slopes	0.60	0.2%	IIIe	5	52
Weighted Average					0.8	*n 58.2

*n: The aggregation method is "Weighted Average using major components"

*c: Using Capabilities Class Dominant Condition Aggregation Method

Soils data provided by USDA and NRCS.