

Soils Map

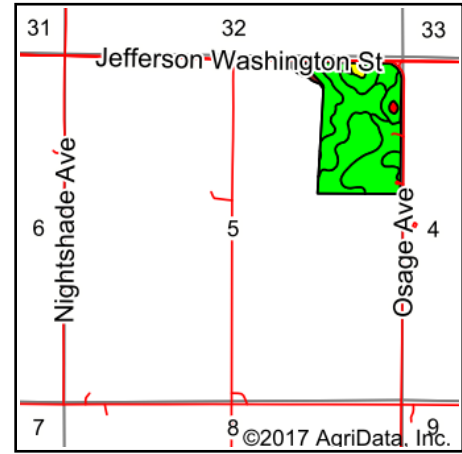

State: **Iowa**
 County: **Jefferson**
 Location: **5-73N-9W**
 Township: **Penn**
 Acres: **62.89**
 Date: **1/17/2018**

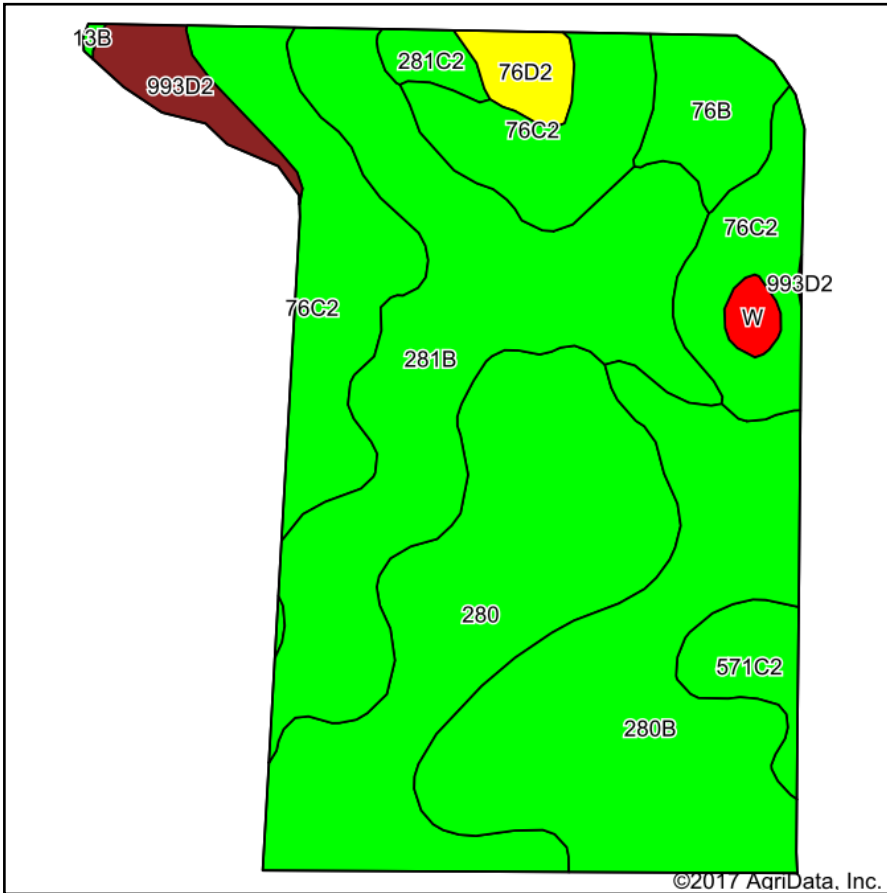

Soils data provided by USDA and NRCS.

©2017 AgriData, Inc.

Area Symbol: IA101, Soil Area Version: 25

Code	Soil Description	Acres	Percent of field	CSR2 Legend	Non-Irr Class *c	CSR2**	CS R
281B	Otley silty clay loam, 2 to 5 percent slopes	14.66	23.3%		Ile	91	90
280B	Mahaska silty clay loam, 2 to 5 percent slopes	14.01	22.3%		Ile	89	90
280	Mahaska silty clay loam, 0 to 2 percent slopes	13.35	21.2%		Iw	94	95
76C2	Ladoga silty clay loam, 5 to 9 percent slopes, eroded	12.83	20.4%		IIle	75	65
76B	Ladoga silt loam, 2 to 5 percent slopes	2.46	3.9%		Ile	86	85
571C2	Hedrick silty clay loam, 5 to 9 percent slopes, moderately erode	1.68	2.7%		IIle	74	62
993D2	Gara-Armstrong complex, 9 to 14 percent slopes, moderately erode	1.52	2.4%		IVe	26	20
76D2	Ladoga silty clay loam, 9 to 14 percent slopes, eroded	1.12	1.8%		IIle	49	55
281C2	Otley silty clay loam, 5 to 9 percent slopes, eroded	0.73	1.2%		IIle	82	70
W	Water	0.47	0.7%			0	0
13B	Olmitz-Vesser-Zook complex, 0 to 5 percent slopes	0.06	0.1%		IIw	74	60
Weighted Average						84.2	81.8

**IA has updated the CSR values for each county to CSR2.

*c: Using Capabilities Class Dominant Condition Aggregation Method

Soils data provided by USDA and NRCS.