

Soils Map

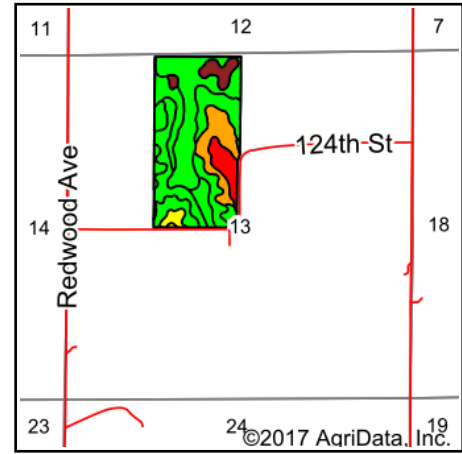

State: **Iowa**
 County: **Jefferson**
 Location: **13-73N-9W**
 Township: **Penn**
 Acres: **77.93**
 Date: **1/11/2018**

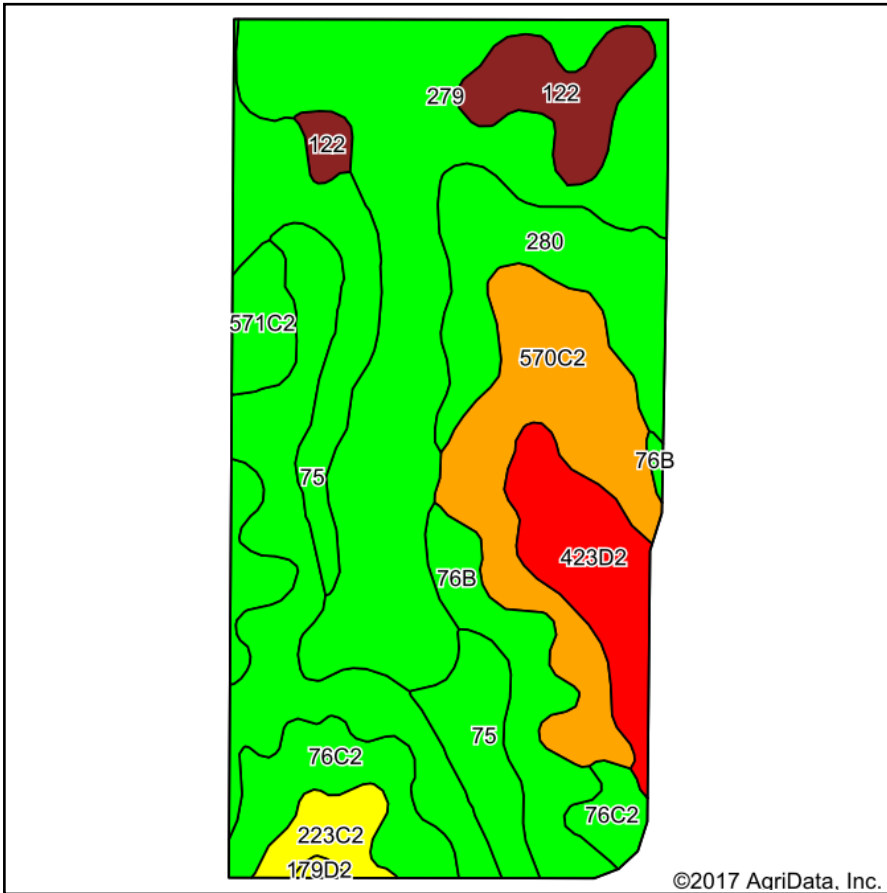

Maps Provided By:

 CUSTOMIZED ONLINE MAPPING
 © AgriData, Inc. 2017 www.AgriDataInc.com



Soils data provided by USDA and NRCS.

©2017 AgriData, Inc.

Area Symbol: IA101, Soil Area Version: 25

Code	Soil Description	Acres	Percent of field	CSR2 Legend	Non-Irr Class *c	CSR2**	CSR
279	Taintor silty clay loam, 0 to 2 percent slopes	20.84	26.7%		IIw	83	88
76B	Ladoga silt loam, 2 to 5 percent slopes	13.56	17.4%		Ile	86	85
570C2	Nira silty clay loam, 5 to 9 percent slopes, moderately eroded	9.74	12.5%		IIIe	70	67
75	Givin silt loam, 0 to 2 percent slopes	8.29	10.6%		Iw	84	85
280	Mahaska silty clay loam, 0 to 2 percent slopes	6.55	8.4%		Iw	94	95
76C2	Ladoga silty clay loam, 5 to 9 percent slopes, eroded	6.42	8.2%		IIIe	75	65
423D2	Bucknell silty clay loam, 9 to 14 percent slopes, moderately eroded	4.96	6.4%		IVe	7	13
122	Sperry silt loam, depressional, 0 to 1 percent slopes	3.98	5.1%		IIIw	36	63
223C2	Rinda silty clay loam, 5 to 9 percent slopes, moderately eroded	1.72	2.2%		IVw	45	22
571C2	Hedrick silty clay loam, 5 to 9 percent slopes, moderately erode	1.71	2.2%		IIIe	74	62
179D2	Gara clay loam, 9 to 14 percent slopes, moderately eroded	0.16	0.2%		IVe	45	43
Weighted Average						73.9	75.1

**IA has updated the CSR values for each county to CSR2.

*c: Using Capabilities Class Dominant Condition Aggregation Method

Soils data provided by USDA and NRCS.