

Soils Map-CSR2

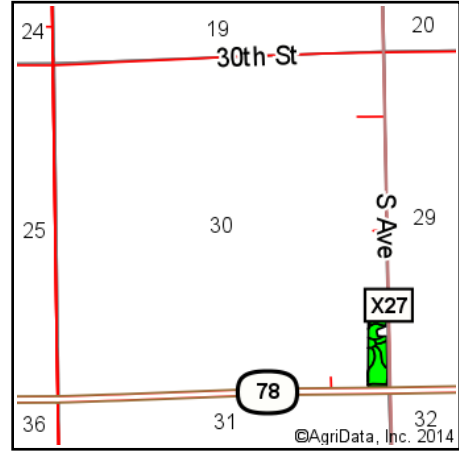

State: **Iowa**
 County: **Louisa**
 Location: **30-73N-4W**
 Township: **Morning Sun**
 Acres: **8.18**
 Date: **9/16/2014**

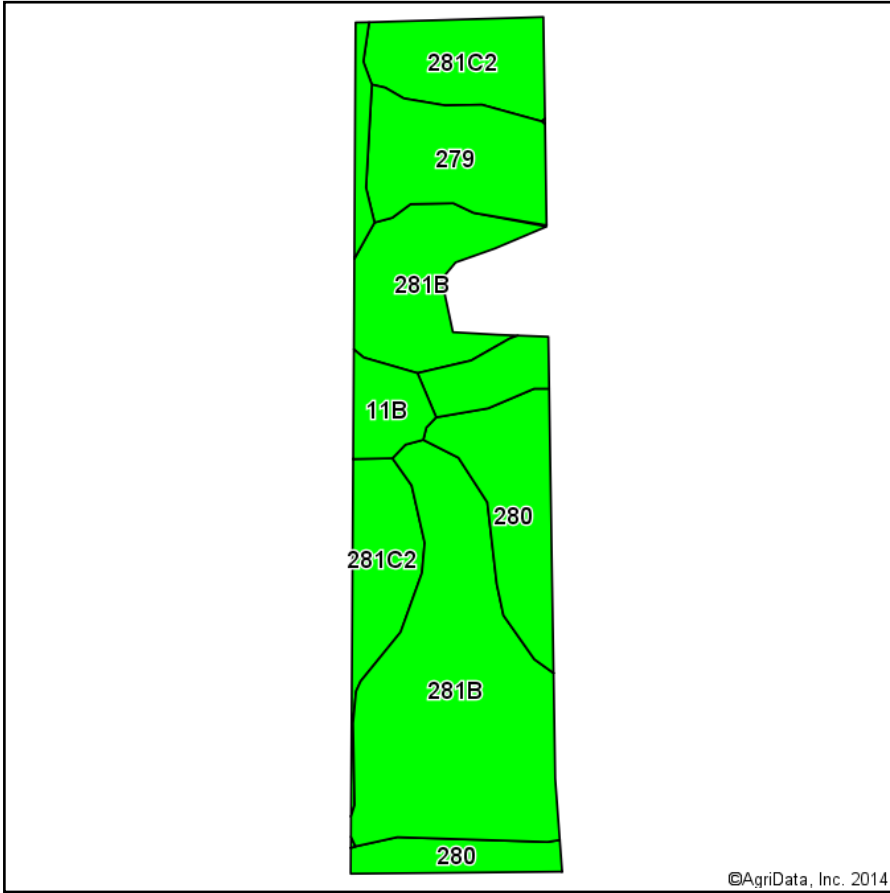
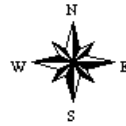

Maps Provided By:
surety
 CUSTOMIZED ONLINE MAPPING
 © AgriData, Inc. 2014 www.AgriDataInc.com

Area Symbol: IA115, Soil Area Version: 17

Code	Soil Description	Acres	Percent of field	**CSR2 Legend	Non-Irr Class	CSR2**	CSR
281B	Otley silty clay loam, 2 to 5 percent slopes	3.69	45.1%		Ile	91	90
281C2	Otley silty clay loam, 5 to 9 percent slopes, moderately eroded	1.41	17.2%		IIle	82	70
279	Taintor silty clay loam, 0 to 2 percent slopes	1.32	16.1%		IIw	84	88
280	Mahaska silty clay loam, 0 to 2 percent slopes	1.27	15.5%		I	91	95
11B	Colo-Ely silty clay loams, 0 to 5 percent slopes	0.49	6.0%		Ile	78	68
Weighted Average						87.5	85.7

Area Symbol: IA115, Soil Area Version: 17

**IA has updated the CSR values for each county to CSR2.

Field borders provided by Farm Service Agency as of 5/21/2008. Aerial photography provided by Aerial Photography Field Office.