

# Soils Map

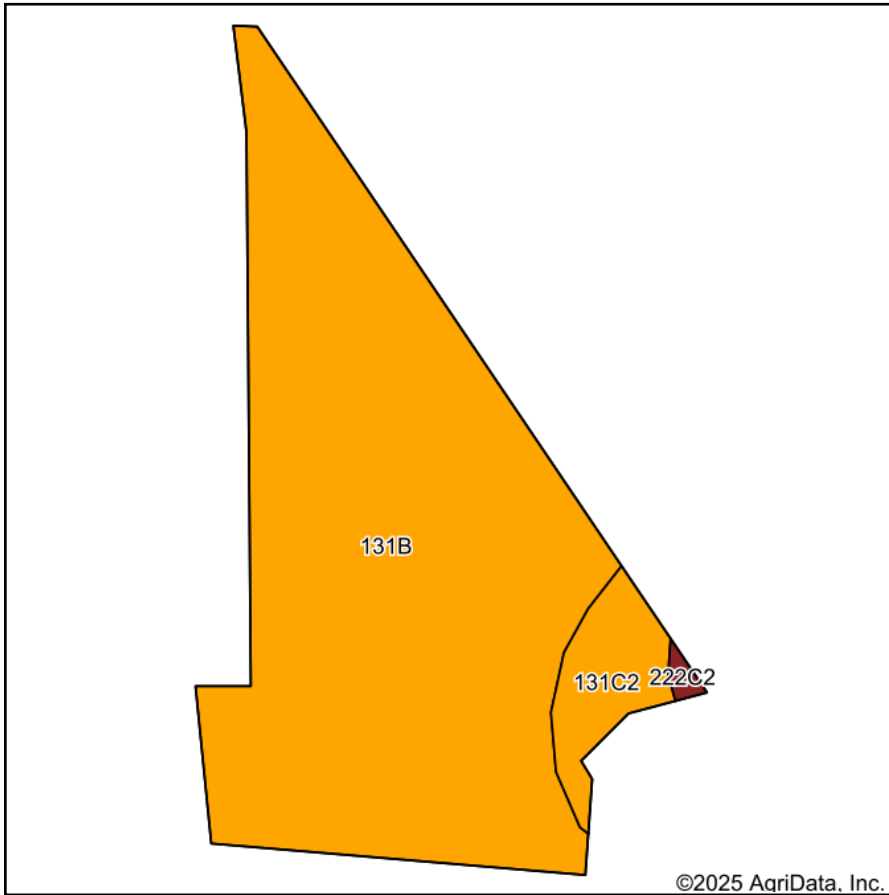

Soils data provided by USDA and NRCS.

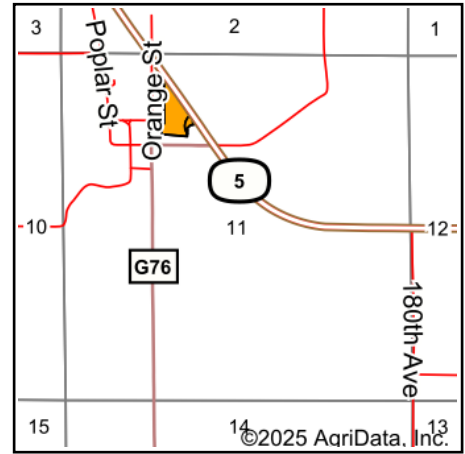

State: **Iowa**  
 County: **Marion**  
 Location: **11-74N-19W**  
 Township: **Indiana**  
 Acres: **5.59**  
 Date: **2/21/2025**



Maps Provided By:



Area Symbol: IA125, Soil Area Version: 34

Code	Soil Description	Acres	Percent of field	CSR2 Legend	Non-Irr Class *c	CSR2**	CSR
131B	Pershing silt loam, 2 to 5 percent slopes	5.19	92.8%		IIIe	70	72
131C2	Pershing silt loam, 5 to 9 percent slopes, moderately eroded	0.40	7.2%		IIIe	62	49
<b>Weighted Average</b>						<b>3.00</b>	<b>69.4</b>
						<b>70.4</b>	

\*\*IA has updated the CSR values for each county to CSR2.

\*c: Using Capabilities Class Dominant Condition Aggregation Method