

Soils Map

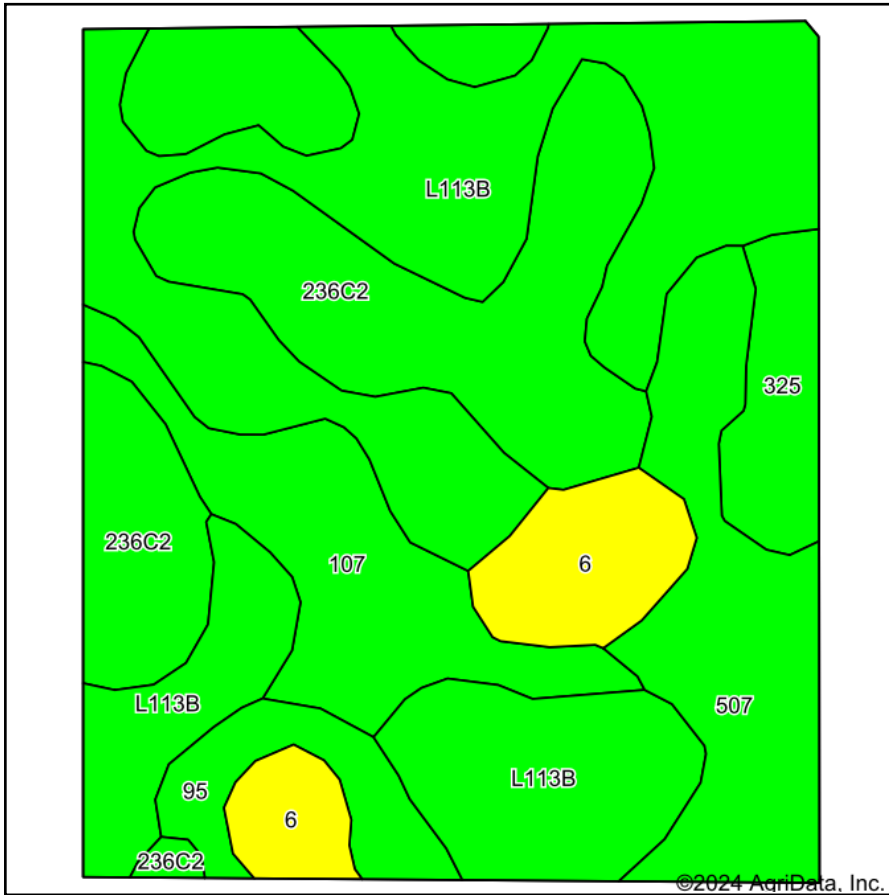

Soils data provided by USDA and NRCS.

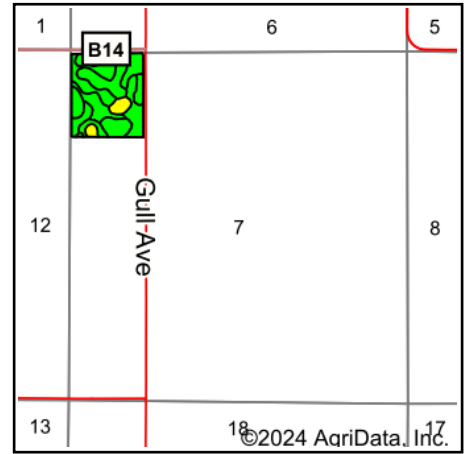

State: **Iowa**
 County: **Cerro Gordo**
 Location: **7-97N-21W**
 Township: **Lincoln**
 Acres: **31.54**
 Date: **9/10/2024**



Maps Provided By:



© AgriData, Inc. 2023

www.AgriDataInc.com



Area Symbol: IA033, Soil Area Version: 27

Code	Soil Description	Acres	Percent of field	CSR2 Legend	Non-Irr Class *c	CSR2**	CSR	
L113B	Reedslake-Le Sueur complex, 1 to 6 percent slopes	12.19	38.6%		Ile	85		
236C2	Lester loam, 6 to 10 percent slopes, moderately eroded	6.33	20.1%		IIIe	76	58	
507	Canisteo clay loam, 0 to 2 percent slopes	3.68	11.7%		IIw	84	78	
107	Webster clay loam, 0 to 2 percent slopes	3.16	10.0%		IIw	86	83	
325	Le Sueur loam, 1 to 3 percent slopes	2.83	9.0%		Iw	77	83	
6	Okoboji silty clay loam, 0 to 1 percent slopes	2.11	6.7%		IIIw	59	57	
95	Harps clay loam, 0 to 2 percent slopes	1.24	3.9%		IIw	72	62	
Weighted Average						2.18	80.2	*-

**IA has updated the CSR values for each county to CSR2.

*- CSR weighted average cannot be calculated on the current soils data, use prior data version for csr values.

*c: Using Capabilities Class Dominant Condition Aggregation Method

Soils data provided by USDA and NRCS.