

# Soils Map

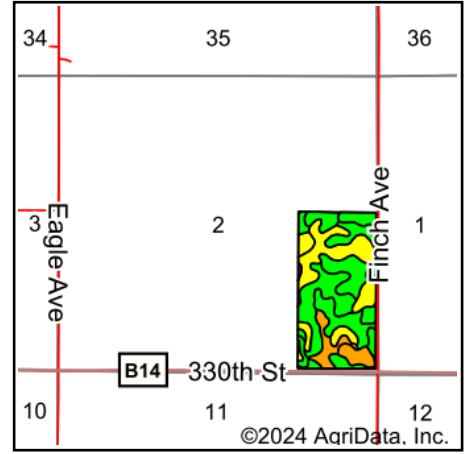

State: **Iowa**  
 County: **Cerro Gordo**  
 Location: **2-97N-22W**  
 Township: **Grant**  
 Acres: **76.4**  
 Date: **9/10/2024**

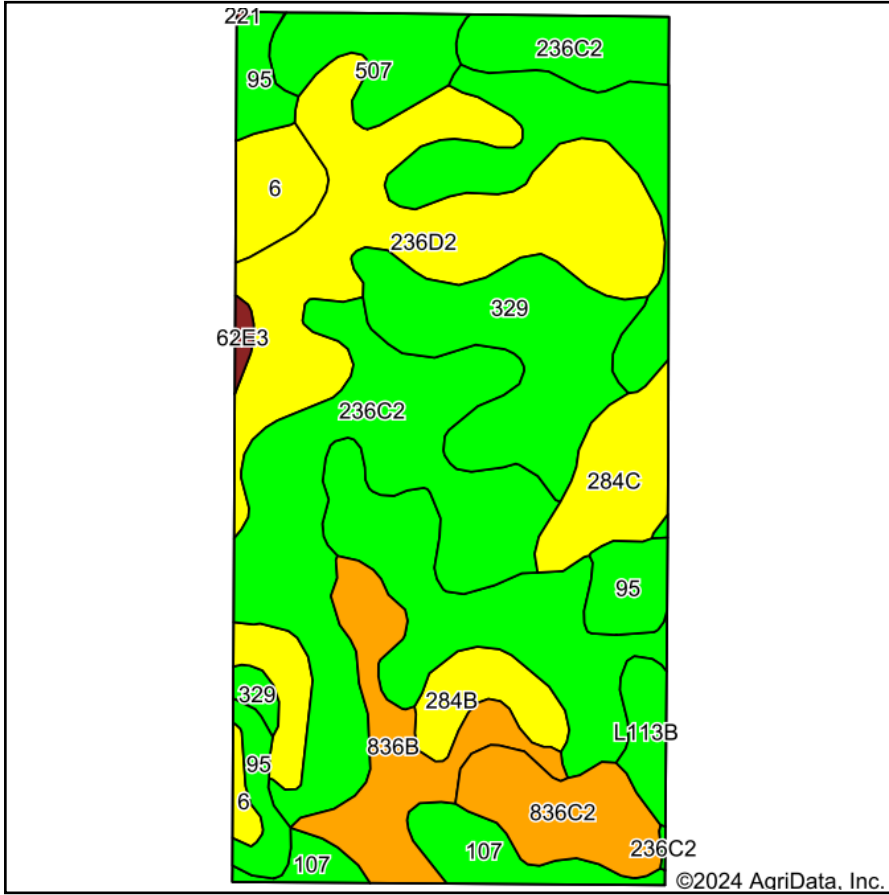

Maps Provided By:  
  
 CUSTOMIZED ONLINE MAPPING  
 © AgriData, Inc. 2023 www.AgriDataInc.com



Area Symbol: IA033, Soil Area Version: 27

Code	Soil Description	Acres	Percent of field	CSR2 Legend	Non-Irr Class *c	CSR2**	CSR	
236C2	Lester loam, 6 to 10 percent slopes, moderately eroded	15.50	20.3%		IIIe	76	58	
107	Webster clay loam, 0 to 2 percent slopes	15.32	20.1%		IIw	86	83	
236D2	Lester loam, 10 to 16 percent slopes, moderately eroded	14.29	18.7%		IVe	49	48	
329	Webster-Nicollet complex, 0 to 3 percent slopes	7.61	10.0%		IIw	87	83	
836B	Kilkenny clay loam, 2 to 6 percent slopes	4.77	6.2%		Ile	69	66	
95	Harps clay loam, 0 to 2 percent slopes	3.59	4.7%		IIw	72	62	
836C2	Kilkenny clay loam, 6 to 10 percent slopes, moderately eroded	3.49	4.6%		IIIe	62	41	
284C	Flagler sandy loam, 5 to 9 percent slopes	3.14	4.1%		IIIe	44	16	
507	Canisteo clay loam, 0 to 2 percent slopes	2.95	3.9%		IIw	84	78	
6	Okoboji silty clay loam, 0 to 1 percent slopes	2.25	2.9%		IIIw	59	57	
284B	Flagler sandy loam, 2 to 5 percent slopes	2.02	2.6%		IIIe	51	37	
L113B	Reedslake-Le Sueur complex, 1 to 6 percent slopes	1.22	1.6%		Ile	85		
62E3	Storden loam, 10 to 22 percent slopes, moderately eroded	0.25	0.3%		IVe	32	26	
<b>Weighted Average</b>						<b>2.73</b>	<b>70.6</b>	<b>*-</b>

\*\*IA has updated the CSR values for each county to CSR2.

\*- CSR weighted average cannot be calculated on the current soils data, use prior data version for csr values.

\*c: Using Capabilities Class Dominant Condition Aggregation Method