

Soils Map

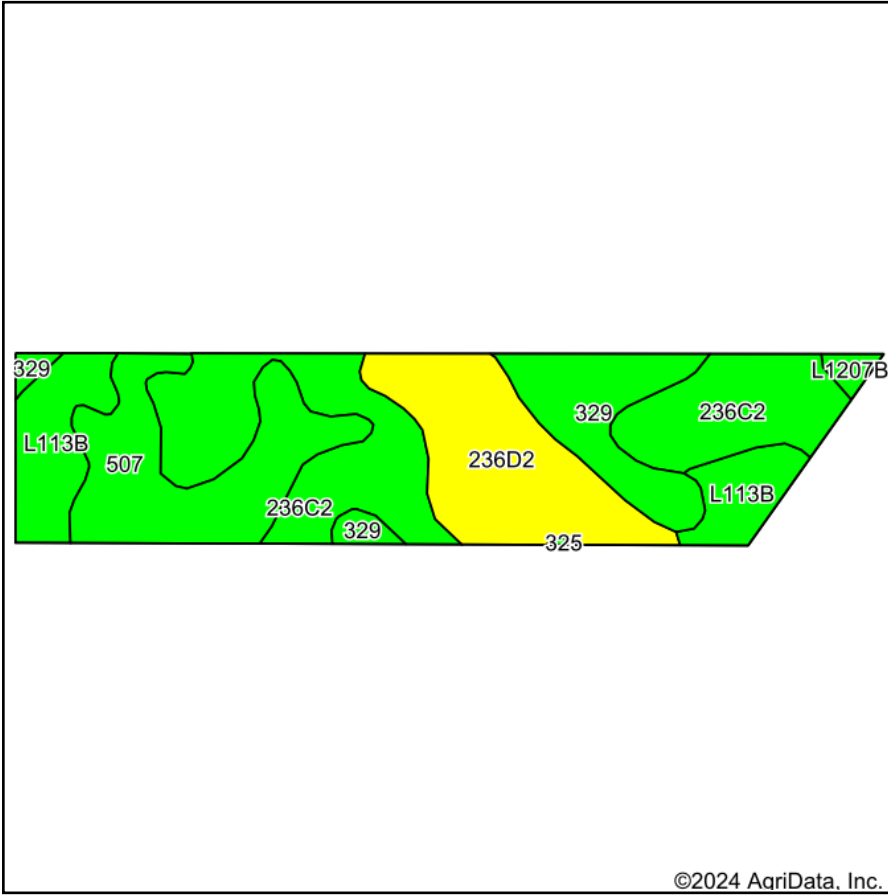

©2024 AgriData, Inc.

Soils data provided by USDA and NRCS.

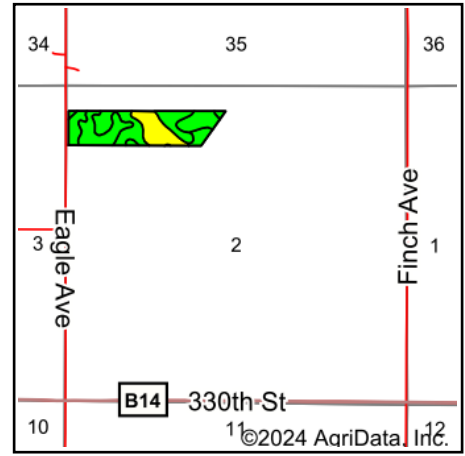

State: **Iowa**
 County: **Cerro Gordo**
 Location: **2-97N-22W**
 Township: **Grant**
 Acres: **27.48**
 Date: **9/10/2024**



Maps Provided By:



© AgriData, Inc. 2023

www.AgriDataInc.com



Area Symbol: IA033, Soil Area Version: 27

Code	Soil Description	Acres	Percent of field	CSR2 Legend	Non-Irr Class *c	CSR2**	CSR	
236C2	Lester loam, 6 to 10 percent slopes, moderately eroded	9.02	32.7%		IIIe	76	58	
236D2	Lester loam, 10 to 16 percent slopes, moderately eroded	5.55	20.2%		IVe	49	48	
507	Canisteo clay loam, 0 to 2 percent slopes	5.27	19.2%		IIw	84	78	
L113B	Reedslake-Le Sueur complex, 1 to 6 percent slopes	3.73	13.6%		Ile	85		
329	Webster-Nicollet complex, 0 to 3 percent slopes	3.62	13.2%		IIw	87	83	
L1207B	Le Sueur-Reedslake-Cordova complex, 0 to 5 percent slopes	0.29	1.1%		Ile	81		
Weighted Average						2.73	74.8	*-

**IA has updated the CSR values for each county to CSR2.

*- CSR weighted average cannot be calculated on the current soils data, use prior data version for csr values.

*c: Using Capabilities Class Dominant Condition Aggregation Method