

# Soils Map

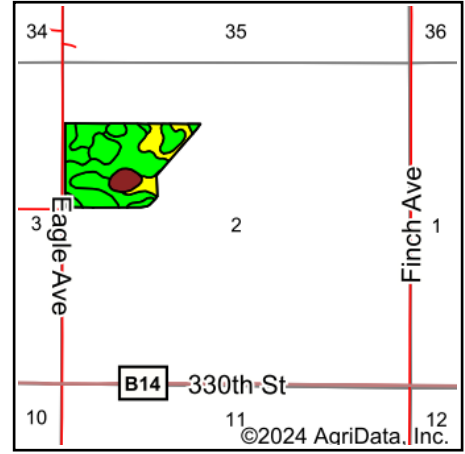

State: **Iowa**  
 County: **Cerro Gordo**  
 Location: **2-97N-22W**  
 Township: **Grant**  
 Acres: **46.35**  
 Date: **9/10/2024**

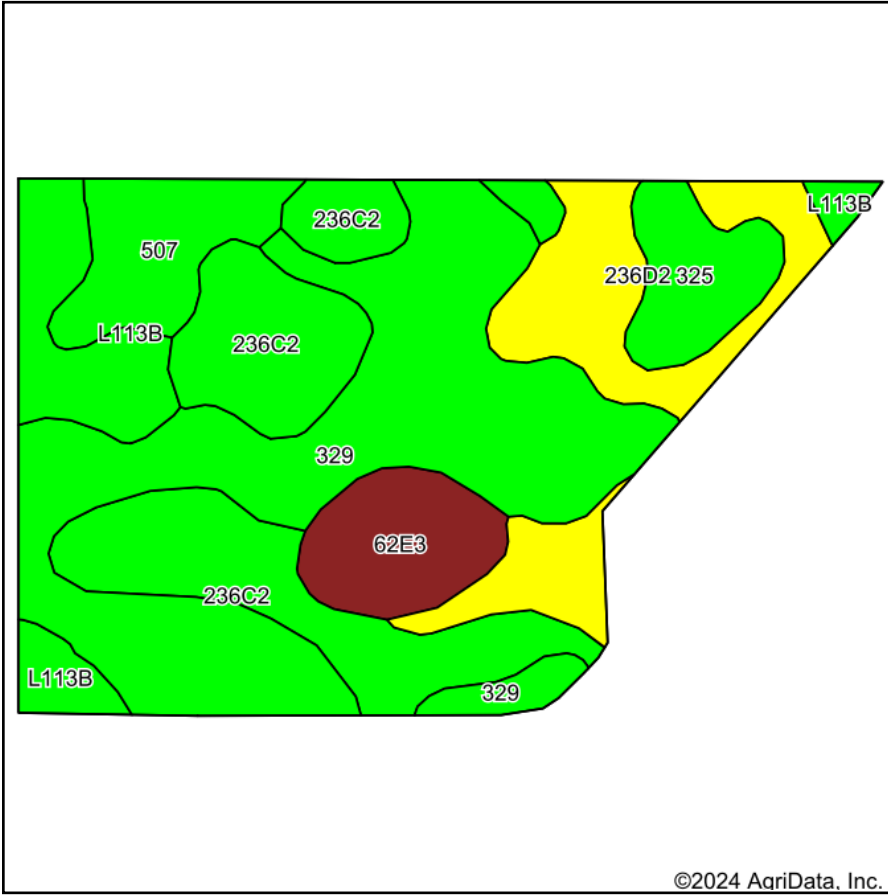

Maps Provided By:  
  
 CUSTOMIZED ONLINE MAPPING  
 © AgriData, Inc. 2023 [www.AgriDataInc.com](http://www.AgriDataInc.com)



Soils data provided by USDA and NRCS.

©2024 AgriData, Inc.

Area Symbol: IA033, Soil Area Version: 27

Code	Soil Description	Acres	Percent of field	CSR2 Legend	Non-Irr Class *c	CSR2**	CSR	
329	Webster-Nicollet complex, 0 to 3 percent slopes	16.69	36.1%		IIw	87	83	
236C2	Lester loam, 6 to 10 percent slopes, moderately eroded	10.35	22.3%		IIIe	76	58	
236D2	Lester loam, 10 to 16 percent slopes, moderately eroded	6.32	13.6%		IVe	49	48	
L113B	Reedslake-Le Sueur complex, 1 to 6 percent slopes	4.23	9.1%		Ile	85		
507	Canisteo clay loam, 0 to 2 percent slopes	3.18	6.9%		IIw	84	78	
62E3	Storden loam, 10 to 22 percent slopes, moderately eroded	3.06	6.6%		IVe	32	26	
325	Le Sueur loam, 1 to 3 percent slopes	2.52	5.4%		Iw	77	83	
<b>Weighted Average</b>						<b>2.57</b>	<b>74.8</b>	<b>*-</b>

\*\*IA has updated the CSR values for each county to CSR2.

\*- CSR weighted average cannot be calculated on the current soils data, use prior data version for csr values.

\*c: Using Capabilities Class Dominant Condition Aggregation Method