

# Soils Map

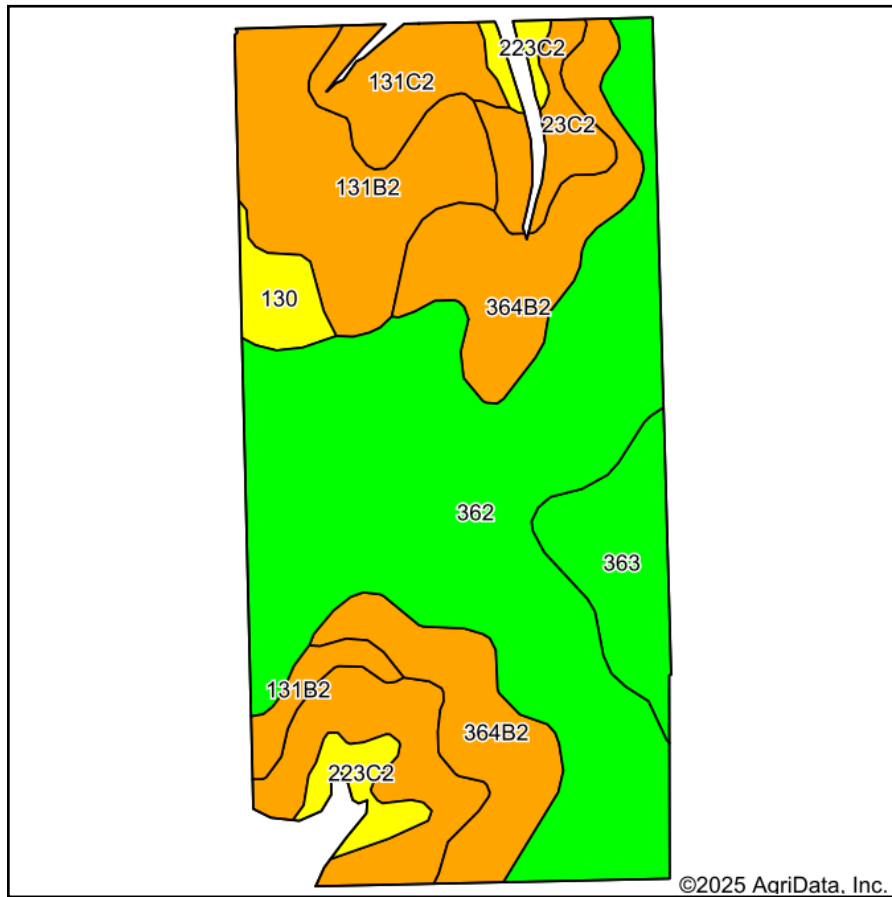

Soils data provided by USDA and NRCS.

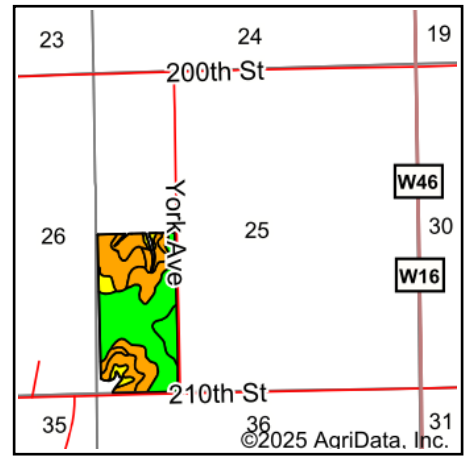

State: **Iowa**  
 County: **Van Buren**  
 Location: **25-69N-8W**  
 Township: **Harrisburg**  
 Acres: **74.86**  
 Date: **6/24/2025**



Maps Provided By:  
  
 CUSTOMIZED ONLINE MAPPING  
 © AgriData, Inc. 2023 www.AgriDataInc.com



Area Symbol: IA177, Soil Area Version: 32

Code	Soil Description	Acres	Percent of field	CSR2 Legend	Non-Irr Class *c	CSR2**	CSR
362	Haig silt loam, 0 to 2 percent slopes	32.53	43.5%		IIw	83	70
364B2	Grundy silty clay loam, 2 to 5 percent slopes, moderately eroded	12.04	16.1%		Ile	70	70
131B2	Pershing silty clay loam, 2 to 5 percent slopes, moderately eroded	10.40	13.9%		IIIe	68	63
131C2	Pershing silty clay loam, 5 to 9 percent slopes, moderately eroded	8.61	11.5%		IIIe	62	45
363	Haig silty clay loam, 0 to 2 percent slopes	4.87	6.5%		IIw	83	65
23C2	Arispe silty clay loam, 5 to 9 percent slopes, moderately eroded	2.55	3.4%		IIIe	62	50
223C2	Rinda silty clay loam, 5 to 9 percent slopes, moderately eroded	2.18	2.9%		IVw	45	22
130	Belinda silt loam, 0 to 2 percent slopes	1.68	2.2%		IIIw	47	63
Weighted Average					2.37	73.8	63.6

\*\*IA has updated the CSR values for each county to CSR2.

\*c: Using Capabilities Class Dominant Condition Aggregation Method

Soils data provided by USDA and NRCS.