

# Soils Map

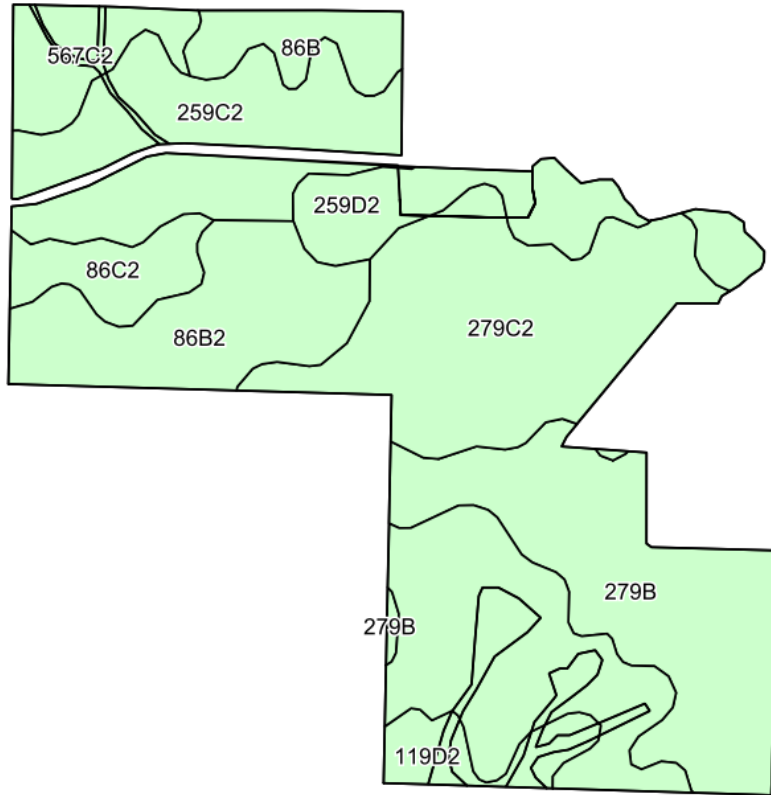

©2025 AgriData, Inc.

Soils data provided by USDA and NRCS.

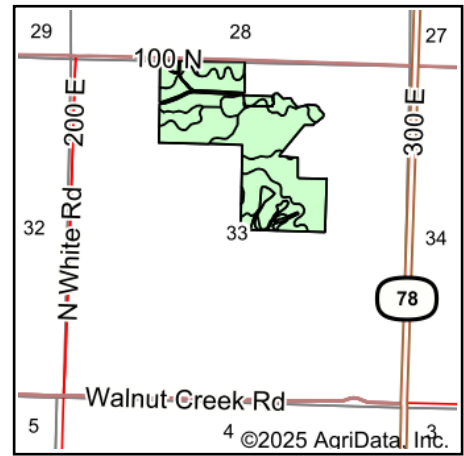

State: **Illinois**  
 County: **Stark**  
 Location: **33-12N-5E**  
 Township: **West Jersey**  
 Acres: **91.1**  
 Date: **12/29/2025**



Maps Provided By:



© AgriData, Inc. 2025

www.AgriDataInc.com



Area Symbol: IL175, Soil Area Version: 18

Code	Soil Description	Acres	Percent of field	Subsoil rooting <sup>a</sup>	Corn Bu/A	Soybeans Bu/A	Wheat Bu/A	Oats Bu/A <sup>b</sup>	Sorghum <sup>c</sup> Bu/A	Grass-legume <sup>e</sup> hay, T/A	Crop productivity index for optimum management
**279C2	Rozetta silt loam, 5 to 10 percent slopes, eroded	30.92	33.9%	FAV	**153	**47	**60	**78	0	**5.00	**112
**279B	Rozetta silt loam, 2 to 5 percent slopes	16.51	18.1%	FAV	**161	**50	**64	**82	0	**5.00	**118
**259C2	Assumption silt loam, 5 to 10 percent slopes, eroded	13.36	14.7%	FAV	**152	**48	**60	**77	0	**4.00	**111
**86B2	Osco silt loam, 2 to 5 percent slopes, eroded	10.11	11.1%	FAV	**180	**56	**71	**96	0	**6.00	**133
**259D2	Assumption silt loam, 10 to 18 percent slopes, eroded	6.67	7.3%	FAV	**142	**45	**57	**72	0	**4.00	**104
**567C2	Elkhart silt loam, 5 to 10 percent slopes, eroded	3.85	4.2%	FAV	**159	**50	**60	**76	0	**5.00	**116
**86C2	Osco silt loam, 5 to 10 percent slopes, eroded	3.51	3.9%	FAV	**178	**56	**70	**95	0	**6.00	**131
**86B	Osco silt loam, 2 to 5 percent slopes	3.39	3.7%	FAV	**187	**59	**74	**100	0	**7.00	**138
**119D2	Elco silt loam, 10 to 18 percent slopes, eroded	2.78	3.1%	FAV	**131	**43	**51	**65	0	**4.00	**97
<b>Weighted Average</b>					<b>158.3</b>	<b>49.3</b>	<b>62.4</b>	<b>81.1</b>	<b>*-</b>	<b>5</b>	<b>116.1</b>

Soils data provided by USDA and NRCS. Soils data provided by University of Illinois at Champaign-Urbana.

**Table: Optimum Crop Productivity Ratings for Illinois Soil EFOTG are sourced from Bulletin 811 calculated Map Unit Base Yield Indices, and adjusted (Adj) for slope, erosion, flooding, and surface texture.** Publication Date: 02-08-2023

Crop yields and productivity (B811 EFOTG) are maintained at the following USDA web site: 2023 Illinois Soil Productivity and Yield Indices:

<https://efotg.sc.egov.usda.gov/#!/state/IL/documents/section=2&folder=52809>

**\*\*** Base indexes from Bulletin 811 adjusted for slope, erosion, flooding, and surface texture according to the II. Soils EFOTG

**b** Soils in the southern region were not rated for oats and are shown with a zero "0".

**c** Soils in the northern region or in both regions were not rated for grain sorghum and are shown with a zero "0".

**e** Soils in the well drained group were not rated for grass-legume and are shown with a zero "0".