

# Soils Map

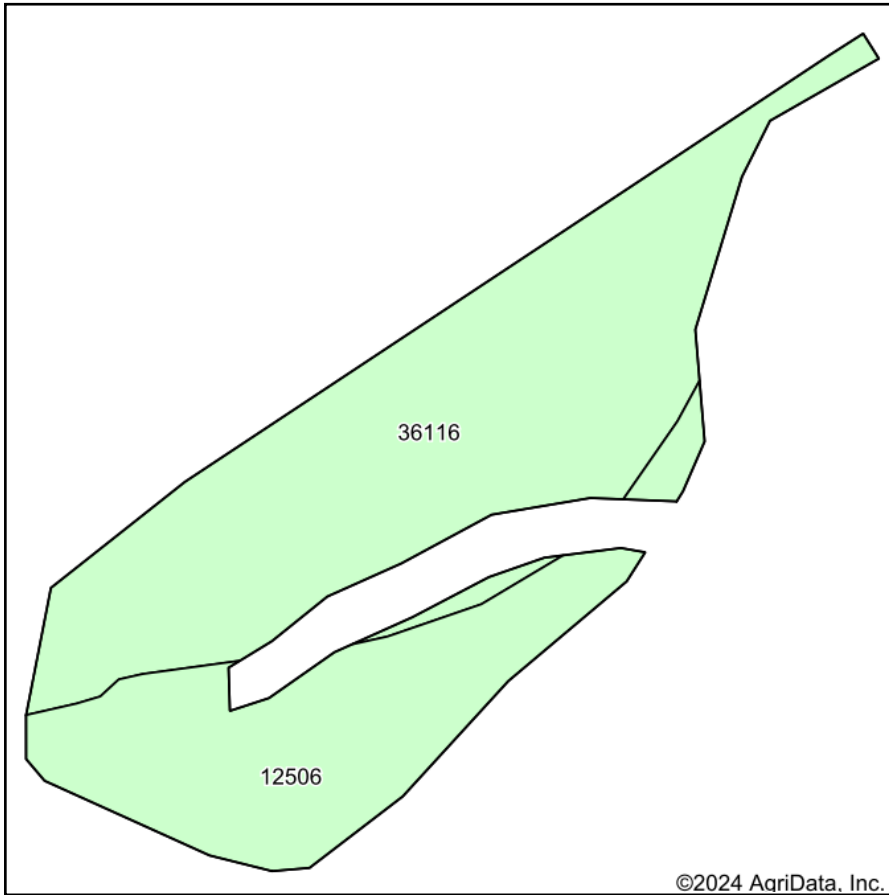

Soils data provided by USDA and NRCS.

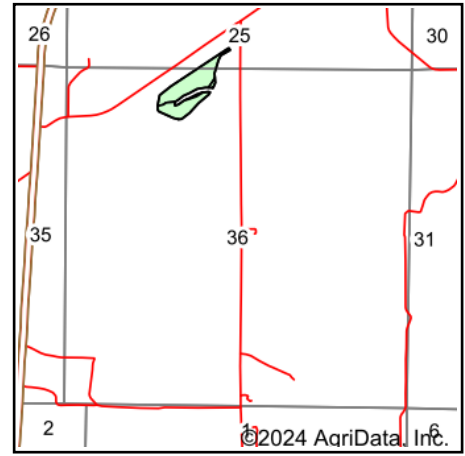

State: **Missouri**  
 County: **DeKalb**  
 Location: **36-58N-33W**  
 Township: **Washington**  
 Acres: **9.71**  
 Date: **9/17/2024**



Maps Provided By:



© AgriData, Inc. 2023

www.AgriDataInc.com



Area Symbol: MO063, Soil Area Version: 25

Code	Soil Description	Acres	Percent of field	Non-Irr Class *c	Alfalfa hay Tons	Caucasian bluestem Tons	Common bermudagrass Tons	Orchardgrass red clover Tons	Tall fescue Tons	Warm season grasses Tons
36116	Zook silty clay loam, heavy till, 0 to 2 percent slopes, occasionally flooded	6.32	65.1%	llw						
12506	Wiota silt loam, 0 to 2 percent slopes, rarely flooded	3.39	34.9%	lw	5	8	8	7	7	9
<b>Weighted Average</b>				<b>1.65</b>	<b>1.7</b>	<b>2.8</b>	<b>2.8</b>	<b>2.4</b>	<b>2.4</b>	<b>3.1</b>

\*c: Using Capabilities Class Dominant Condition Aggregation Method