

Soils Map

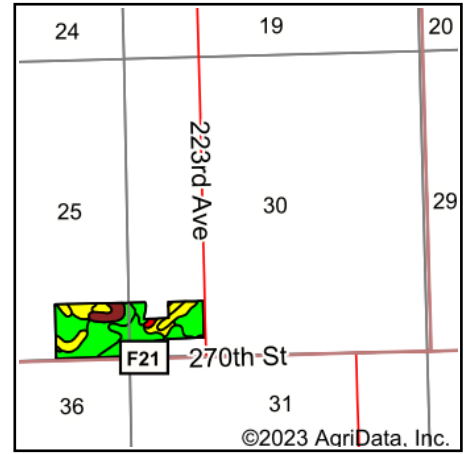

State: **Iowa**
 County: **Clinton**
 Location: **25-81N-2E**
 Township: **Orange**
 Acres: **49.66**
 Date: **10/31/2023**

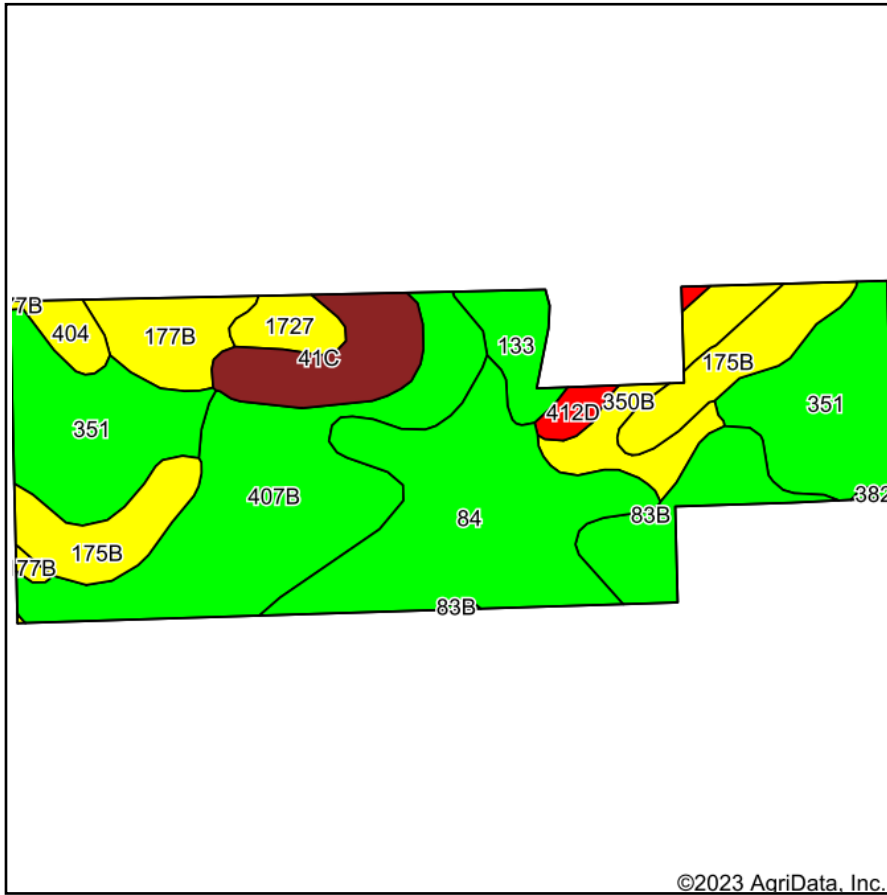

Maps Provided By:



Area Symbol: IA045, Soil Area Version: 29

Code	Soil Description	Acres	Percent of field	CSR2 Legend	Non-Irr Class *c	Irr Class *c	CSR2**	CSR
407B	Schley loam, 1 to 4 percent slopes	10.32	20.8%		IIw		81	73
351	Atterberry silt loam, sandy substratum, 0 to 2 percent slopes	9.88	19.9%		Iw		80	73
84	Clyde silty clay loam, 0 to 3 percent slopes	9.68	19.5%		IIw		88	77
175B	Dickinson fine sandy loam, 2 to 5 percent slopes	4.79	9.6%		IIIe		50	56
41C	Sparta loamy sand, 5 to 9 percent slopes	3.05	6.1%		IVs	Ile	37	25
83B	Kenyon loam, 2 to 5 percent slopes	2.99	6.0%		Ile		90	87
350B	Waukegan silt loam, 2 to 5 percent slopes	2.49	5.0%		Ile		55	69
177B	Saude loam, 2 to 5 percent slopes	2.35	4.7%		IIs		55	61
133	Colo silty clay loam, 0 to 2 percent slopes, occasionally flooded	1.55	3.1%		IIw		78	85
1727	Udolpho loam, 0 to 2 percent slopes	1.07	2.2%		IIw		48	69
404	Thorp silt loam, 0 to 2 percent slopes	0.81	1.6%		IIw		60	57
412D	Sogn loam, 5 to 14 percent slopes	0.60	1.2%		VIIs		5	8
382	Maxfield silty clay loam, 0 to 2 percent slopes	0.08	0.2%		IIw		87	90
Weighted Average					2.07	*-	72.4	68.5

**IA has updated the CSR values for each county to CSR2.

*c: Using Capabilities Class Dominant Condition Aggregation Method

*- Irr Class weighted average cannot be calculated on the current soils data due to missing data.

Soils data provided by USDA and NRCS.