

Soils Map

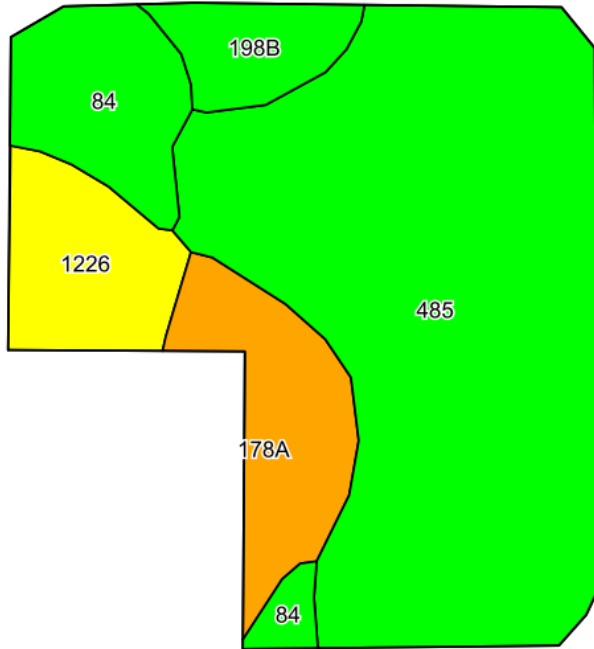

©2025 AgriData, Inc.

Soils data provided by USDA and NRCS.

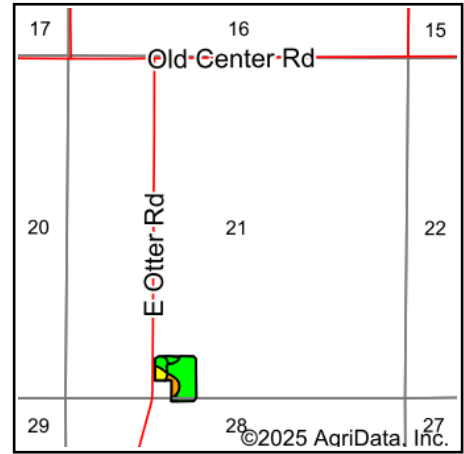

State: **Iowa**
 County: **Linn**
 Location: **21-85N-7W**
 Township: **Otter Creek**
 Acres: **8.38**
 Date: **12/9/2025**



Maps Provided By:



© AgriData, Inc. 2025

www.AgriDataInc.com



Area Symbol: IA113, Soil Area Version: 32

| Code | Soil Description | Acres | Percent of field | CSR2 Legend | Non-Irr Class *c | CSR2** |
|------------------|--|-------|------------------|-------------|------------------|--------|
| 485 | Spillville loam, 0 to 2 percent slopes, occasionally flooded | 5.33 | 63.5% | | Ilw | 76 |
| 178A | Waukee loam, 0 to 2 percent slopes | 0.92 | 11.0% | | IlS | 69 |
| 84 | Clyde silty clay loam, 0 to 3 percent slopes | 0.91 | 10.9% | | Ilw | 88 |
| 1226 | Lawler loam, 0 to 2 percent slopes, rarely flooded | 0.77 | 9.2% | | IlS | 59 |
| 198B | Floyd loam, 1 to 4 percent slopes | 0.45 | 5.4% | | Ilw | 89 |
| Weighted Average | | | | | 2.00 | 75.7 |

**IA has updated the CSR values for each county to CSR2.

*c: Using Capabilities Class Dominant Condition Aggregation Method

Soils data provided by USDA and NRCS.